

LEE COUNTY SURVEY MARK DESCRIPTION

DESIGNATION 2281 COUNTY LEE STATE FLORIDA
 LOCATED IN SEC 33 TWP 44S RGE 22E USGS QUAD MAP PINE ISLAND CENTER
 TO REACH SURVEY MARK:
 FROM PINE ISLAND CENTER; RUN SOUTH ALONG STRINGFELLOW ROAD
 1.5 mi. ± TO MARIA DR.; THENCE RUN WEST ALONG MARIA DR. 0.6 mi ± TO
 DISK "2281"

TYPE OF SET 3" LEE COUNTY PUBLIC WORKS ALUM. DISK IN PAVEMENT
 MARK _____ DATE SET APRIL 20 1998
 HORIZONTAL CONTROL ORIGINATED ON 2ND 1ST ORDER CONTROL BY _____
 ON 1927 DATUM. ON 1983 (1990 GPS ADJUSTMENT) DATUM.
 COORDINATES (FT.) 3RD ORDER COORDINATES (FT.) 3RD ORDER
 NORTHING (Y) _____ NORTHING (Y) 820856.98
 EASTING (X) _____ EASTING (X) 616826.42
 GRID FLORIDA TRANSVERSE MERCATOR RECOVERED BY _____
 ZONE WEST DATE CONDITION _____
 FIELD BOOK BWL #2 PAGE 12

RECOVERY TIES

- NO. 1 00° - 6.91' to 5/8" I.R. w/ wit. Cap (LB4919)
- NO. 2 135° - 38.04' to 5/8" I.R. w/ wit. Cap (LB4919)
- NO. 3 236° - 38.83' to 5/8" I.R. w/ wit. Cap (LB4919)

NW	NE
SW	SE

SECTION

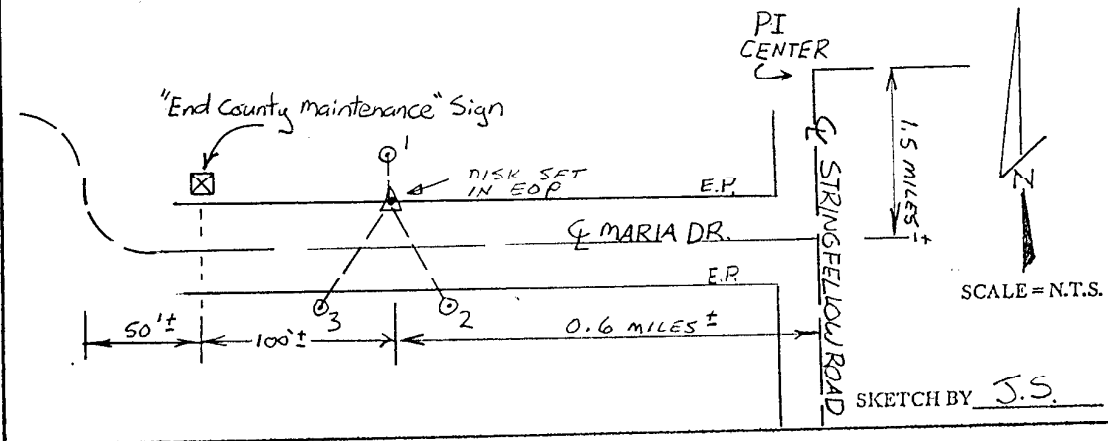

JOHNSON ENGINEERING, INC.

CIVIL ENGINEERS - LAND SURVEYORS
 2158 JOHNSON STREET, POST OFFICE BOX 1550, FORT MYERS, FLORIDA, 33902-1550
 PHONE: 941-334-0046