

LEE COUNTY
SURVEY MARK DESCRIPTION

1301

DESIGNATION 136 COUNTY LEE STATE FL.
 LOCATED IN SEC 8 TWP 44 S RGE 24 E USGS QUAD MAP FORT MYERS NW
 TO REACH SURVEY MARK:

TYPE OF 3/4" ALUMINUM LEE COUNTY SURVEY CONTROL MARK ON 3/4" PIPE SET IN CONCRETE
 MARK 136 DATE SET APRIL 29 19 98
 HORIZONTAL CONTROL ORIGINATED ON 2nd/1st ORDER CONTROL BY NATIONAL GEODETIC SURVEY (NGS)
 ON 1927 DATUM. ON 1983 (1990 GPS Adjustment) DATUM.
 COORDINATES (FT). 2nd ORDER COORDINATES (FT). 2nd ORDER
 NORTHING (M) N/A NORTHING (M) 842863.4678
 EASTING (M) N/A EASTING (M) 677728.9994
 GRID FLORIDA TRANSVERSE MERCATOR RECOVERED BY _____
 ZONE WEST DATE, CONDITION _____
 FIELD BOOK JEI # 4 PAGE 4

RECOVERY TIES

- NO. 1 SET PK NAIL W/DISK
- NO. 2 SET PK NAIL W/DISK
- NO. 3 SET PK NAIL W/DISK

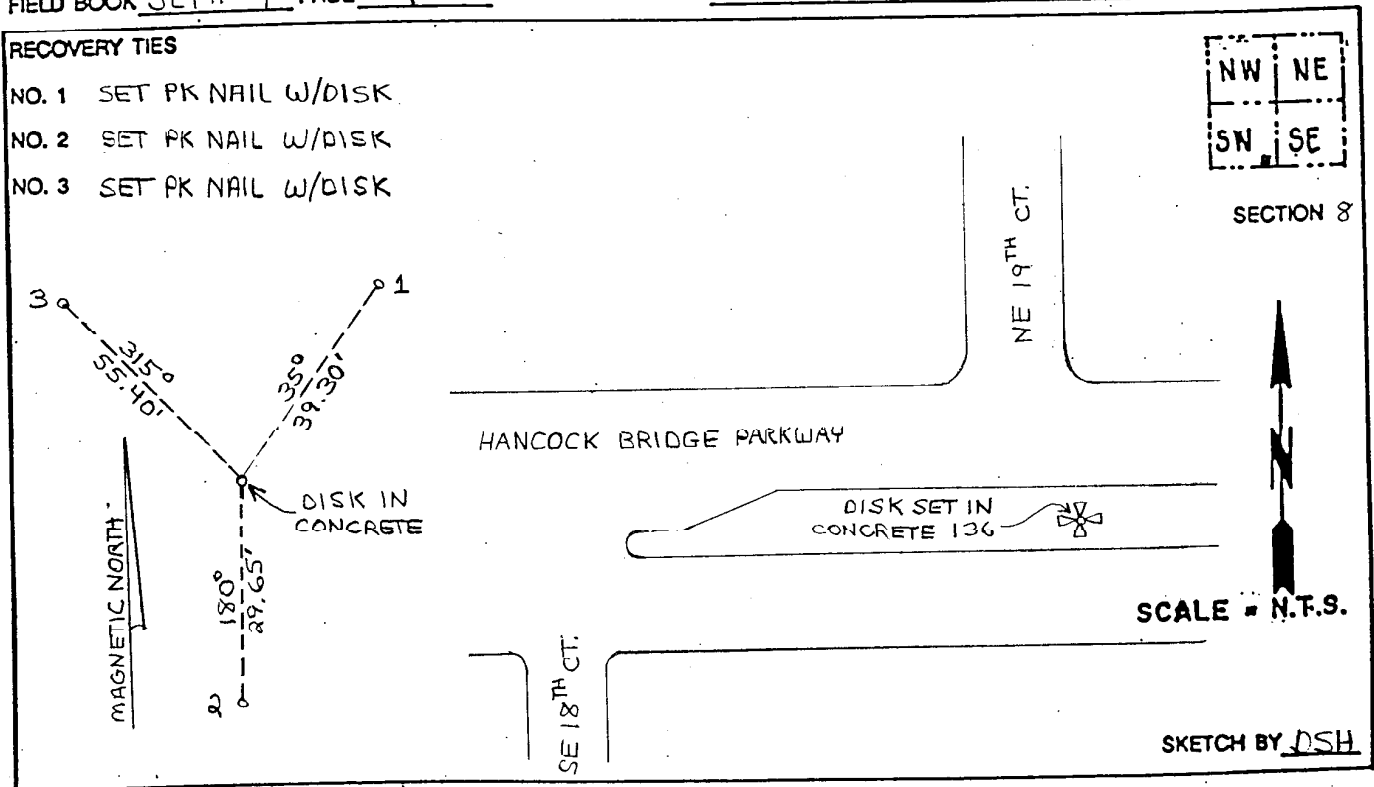

JOHNSON ENGINEERING, INC.
 CIVIL ENGINEERS LAND SURVEYORS
 2158 JOHNSON STREET, POST OFFICE BOX 1550, FORT MYERS, FLORIDA, 33902-1550
 PHONE (941) 334-0046