

LEE COUNTY SURVEY MARK DESCRIPTION

1261

DESIGNATION 111 COUNTY LEE STATE FL.
 LOCATED IN SEC 22 TWP 43S RGE 25 E USGS QUAD MAP FORT MYERS
 TO REACH SURVEY MARK:

TYPE OF 3/4" ALUMINUM LEE COUNTY SURVEY CONTROL MARK SET IN PAVEMENT
 MARK 111 DATE SET APRIL 7 1998
 HORIZONTAL CONTROL ORIGINATED ON 2ND/1ST ORDER CONTROL BY NATIONAL GEODETIC SURVEY (NGS)
 ON 1927 DATUM. ON 1983 (1990 GPS Adjustment) DATUM.
 COORDINATES (FT), 2ND ORDER COORDINATES (FT), 2ND ORDER
 NORTHING (M) N/A NORTHING (M) 865638.3692
 EASTING (M) N/A EASTING (M) 719619.0460
 GRID FLORIDA TRANSVERSE MERCATOR RECOVERED BY _____
 ZONE WEST DATE, CONDITION _____
 FIELD BOOK JEI # 2 PAGE 69

RECOVERY TIES

- NO. 1 SET PK NAIL W/DISK
- NO. 2 SET PK NAIL W/DISK
- NO. 3 SET PK NAIL W/DISK

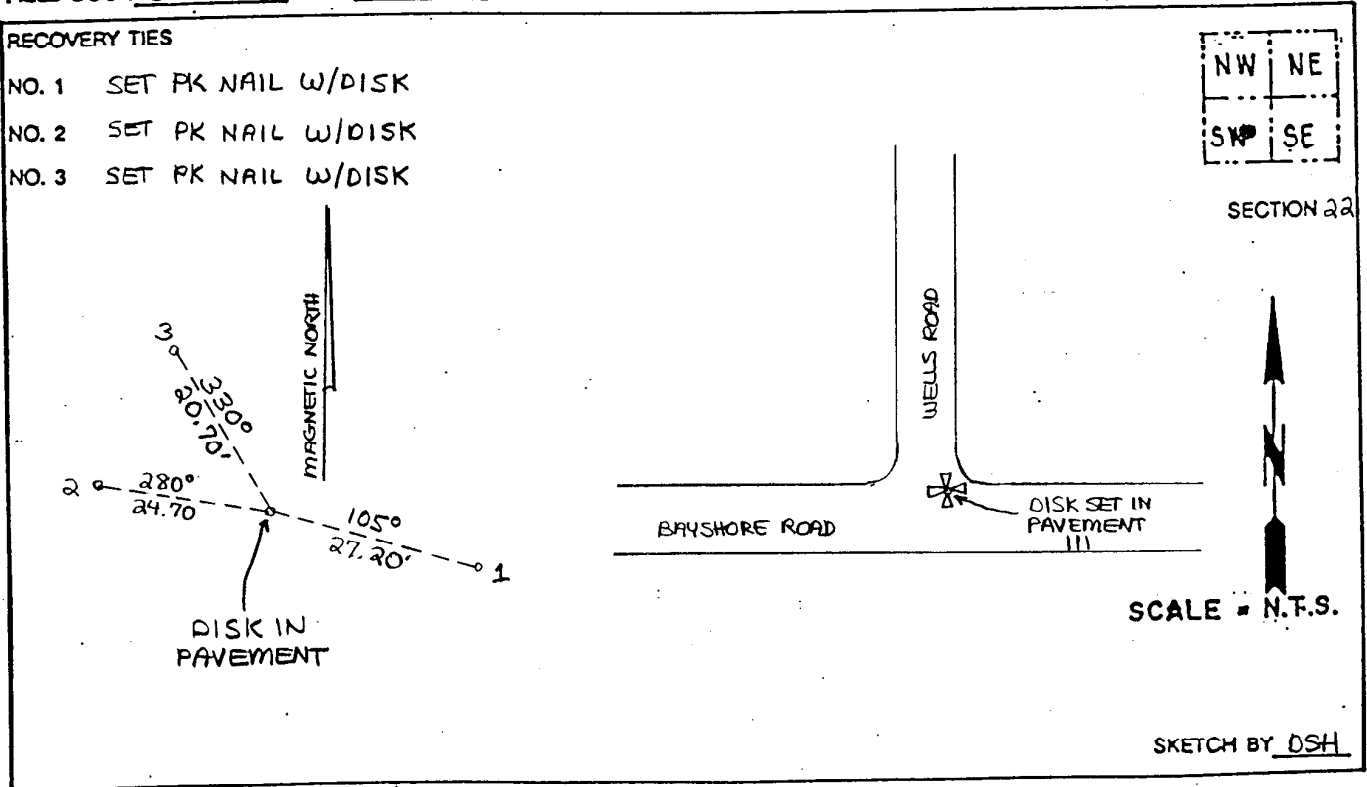

JOHNSON ENGINEERING, INC.
 CIVIL ENGINEERS - LAND SURVEYORS
 2156 JOHNSON STREET, POST OFFICE BOX 1350, FORT MYERS, FLORIDA, 33902-1350
 PHONE 19411 334-0046