

LEE COUNTY
SURVEY MARK DESCRIPTION

DESIGNATION 224 COUNTY LEE STATE FLORIDA

LOCATED IN SEC 20 TWP 46S RGE 24E USGS QUAD MAP FORT MYERS BEACH

TO REACH SURVEY MARK:

FROM SUMMERLIN ROAD, RUN SOUTH ON SAN CARLOS BLVD. TO ESTERO BLVD.,
THENCE RUN EAST ON ESTERO BLVD. 1.4 mi. + TO DONORA BLVD, THENCE RUN
NORTH EASTERLY ALONG DONORA BLVD TO HOUSE #490 AT END OF STREET.

TYPE OF SET 3" LEE COUNTY PUBLIC WORKS ALUM. DISK.

MARK _____ DATE SET JUNE 10 1998

HORIZONTAL CONTROL ORIGINATED ON 2ND 1ST ORDER CONTROL BY _____

ON _____ 1927 DATUM. ON 1983 (1990 GPS ADJUSTMENT) DATUM.

COORDINATES (FT). 224 ORDER _____ COORDINATES (FT) 224 ORDER _____

NORTHING (Y) _____ NORTHING (Y) 768679.28

EASTING (X) _____ EASTING (X) 679105.56

GRID FLORIDA TRANSVERSE MERCATOR RECOVERED BY _____

ZONE WEST DATE CONDITION _____

FIELD BOOK BWL #4 PAGE 1

RECOVERY TIES

NO. 1 $292^{\circ}-31.23'$ to PK + DISK (LB4914)

NO. 2 $168^{\circ}-29.72'$ to PK + DISK (LB4919)

NO. 3 $350^{\circ}-34.67'$ to East Cor. of Garage

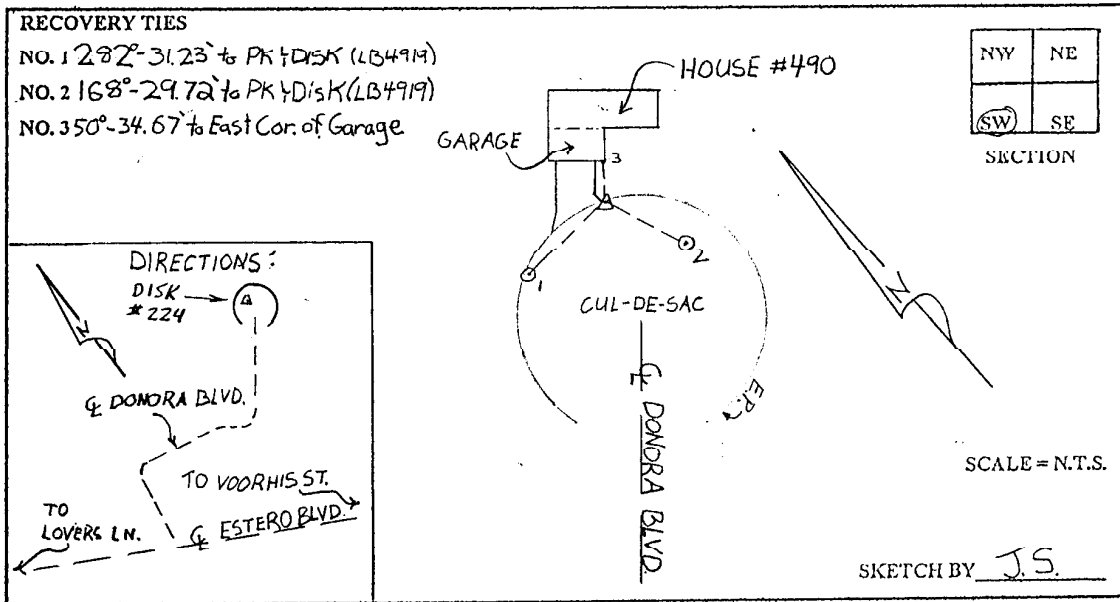

JOHNSON ENGINEERING, INC.

CIVIL ENGINEERS - LAND SURVEYORS

2158 JOHNSON STREET, POST OFFICE BOX 1550, FORT MYERS, FLORIDA, 33902-1550

PHONE: 941-334-0046