

## LEE COUNTY SURVEY MARK DESCRIPTION

DESIGNATION 2012 COUNTY LFE STATE FLORIDA  
 LOCATED IN SEC 36 TWP 45S RGE 27E USGS QUAD MAP ALVA SE

TO REACH SURVEY MARK:  
 FROM COLONIAL BLVD. EXTENSION; RUN SOUTH EASTERLY ALONG S.R.-82 15 mi. ± TO COLUMBUS BLVD.; THENCE RUN NORTHERLY ALONG COLUMBUS BLVD 0.5 mi. ± TO DAMEN ST. E.; THENCE RUN EAST ALONG DAMEN ST. E. TO HALLMARK AVE. S.; THENCE RUN SOUTH ALONG HALLMARK AVE. S. TO DELORES ST. E.

TYPE OF SET 6" ROUND CONCRETE MONUMENT w/ 3" LEE COUNTY PUBLIC  
 MARK WORKS ALUM. DISK DATE SET JUNE 22 1998

HORIZONTAL CONTROL ORIGINATED ON 2<sup>ND</sup> 1<sup>ST</sup> ORDER CONTROL BY \_\_\_\_\_  
 ON 1927 DATUM. ON 1983 (1990 GPS ADJUSTMENT) DATUM.

COORDINATES (FT.) 2<sup>ND</sup> ORDER COORDINATES (FT.) 2<sup>ND</sup> ORDER  
 NORTHING (Y) \_\_\_\_\_ NORTHING (Y) 797329.75  
 EASTING (X) \_\_\_\_\_ EASTING (X) 796450.10

GRID FLORIDA TRANSVERSE MERCATOR RECOVERED BY \_\_\_\_\_  
 ZONE WEST DATE CONDITION \_\_\_\_\_  
 FIELD BOOK BWL #1 PAGE 3

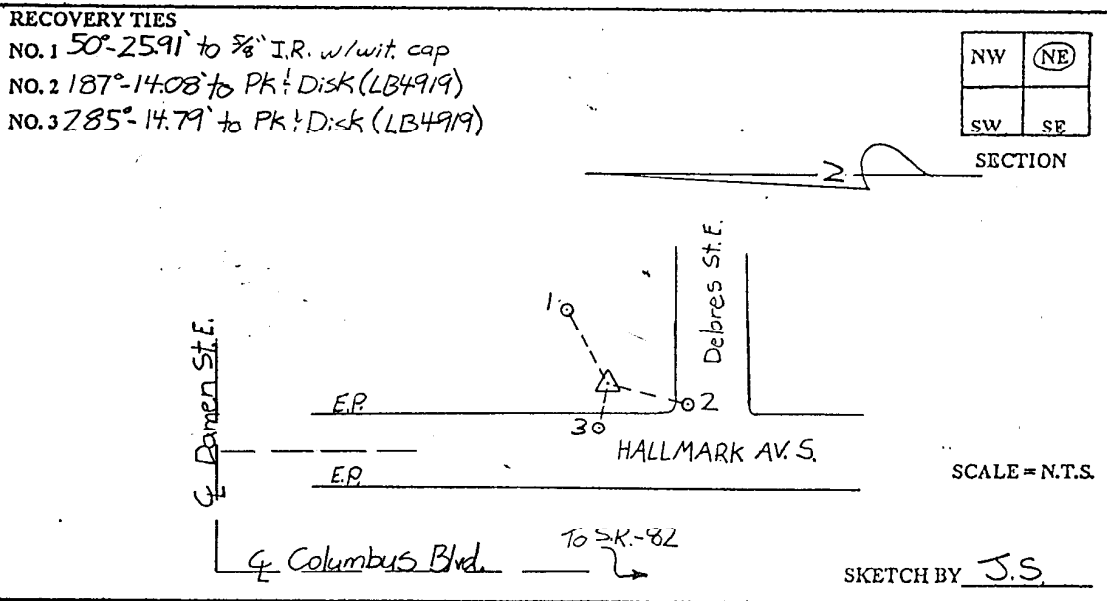

**JOHNSON ENGINEERING, INC.**

CIVIL ENGINEERS - LAND SURVEYORS

2158 JOHNSON STREET, POST OFFICE BOX 1550, FORT MYERS, FLORIDA, 33902-1550

PHONE: 941-334-0046