

LEE COUNTY SURVEY MARK DESCRIPTION

DESIGNATION 154 COUNTY LEE STATE FLORIDA
 LOCATED IN SEC 13 TWP 46S RGE 24E USGS QUAD MAP ESTERO

TO REACH SURVEY MARK:

FROM ALICO ROAD, RUN NORTHERLY ALONG US-41 0.9 mi.± TO ISLAND PARK ROAD, THENCE RUN SOUTHERLY ALONG ISLAND PARK ROAD 1.6 mi.± TO PARK ROAD, THENCE RUN WESTERLY ALONG PARK ROAD TO JACOBS DR., THENCE RUN SOUTHERLY ALONG JACOBS DR TO COCOS ST., THENCE RUN EASTERLY ALONG COCOS ST. TO HOUSE #6380 AND TO MARK.
 TYPE OF SET 6" ROUND CONCRETE MONUMENT W/ 3" LEE COUNTY

MARK PUBLIC WORKS ALUM. DISK DATE SET JUNE 23 1998
 HORIZONTAL CONTROL ORIGINATED ON 2ND 1ST ORDER CONTROL BY _____
 ON _____ 1927 DATUM. ON 1983 (1990 GPS ADJUSTMENT) DATUM.
 COORDINATES (FT.) NO ORDER COORDINATES (FT.) NO ORDER
 NORTHING (Y) _____ NORTHING (Y) 779800.61
 EASTING (X) _____ EASTING (X) 701851.49
 GRID FLORIDA TRANSVERSE MERCATOR RECOVERED BY _____
 ZONE WEST DATE CONDITION _____
 FIELD BOOK BWL#4 PAGE 13

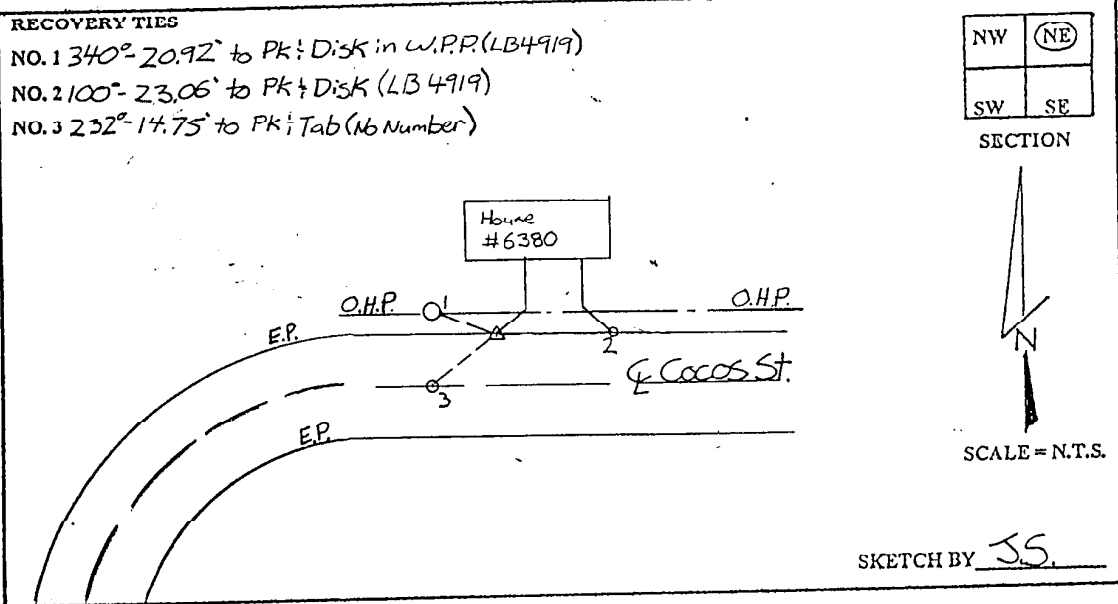

JOHNSON ENGINEERING, INC.
 CIVIL ENGINEERS - LAND SURVEYORS
 2158 JOHNSON STREET, POST OFFICE BOX 1550, FORT MYERS, FLORIDA, 33902-1550
 PHONE: 941-334-0046