

### LEE COUNTY SURVEY MARK DESCRIPTION

DESIGNATION 233 COUNTY LEE STATE FLORIDA  
 LOCATED IN SEC 24 TWP 46S RGE 23E USGS QUAD MAP FORT MYERS BEACH  
 TO REACH SURVEY MARK:  
 FROM SUMMERLIN ROAD, RUN SOUTHERLY ALONG SAN CARLOS BLVD. TO ESTERO  
 BLVD., THENCE RUN WEST ALONG ESTERO BLVD. TO CARLOS CIR., CONTINUE  
 RUNNING WEST TO DOLPHIN WATCH SELF STORAGE GARAGES ON THE SOUTH  
 SIDE OF ESTERO BLVD.  
 TYPE OF SET 6" ROUND CONCRETE MONUMENT W/ 3" LEE COUNTY PUBLIC  
MARK WORKS ALUM. DISK DATE SET JUNE 8 19 98  
 HORIZONTAL CONTROL ORIGINATED ON 2<sup>ND</sup> 1<sup>ST</sup> ORDER CONTROL BY \_\_\_\_\_  
 ON 1927 DATUM. ON 1983 (1990 GPS ADJUSTMENT) DATUM.  
 COORDINATES (FT). \_\_\_\_\_ ORDER \_\_\_\_\_ COORDINATES (FT) \_\_\_\_\_ ORDER \_\_\_\_\_  
 NORTHING (Y) \_\_\_\_\_ NORTHING (Y) 772004.18  
 EASTING (X) \_\_\_\_\_ EASTING (X) 668644.76  
 GRID FLORIDA TRANSVERSE MERCATOR RECOVERED BY \_\_\_\_\_  
 ZONE WEST DATE CONDITION \_\_\_\_\_  
 FIELD BOOK BLW/ #4 PAGE 7

RECOVERY TIES  
 NO. 1  $2^{\circ}-20.84'$  to  $\frac{5}{8}$ " I.R. w/ Trav. Cap LB4919  
 NO. 2  $92^{\circ}-17.66'$  to PK Disk (LB4919)  
 NO. 3  $234^{\circ}-20.62'$  to  $\frac{5}{8}$ " I.R. w/ Trav. Cap LB4919

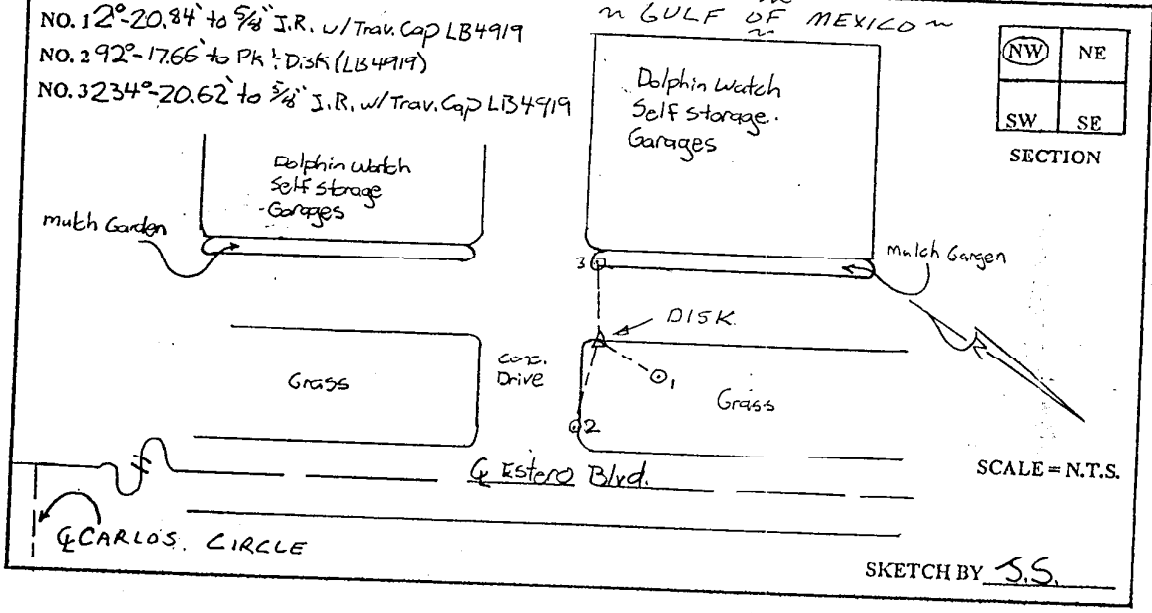

**JOHNSON ENGINEERING, INC.**  
 CIVIL ENGINEERS - LAND SURVEYORS  
 2158 JOHNSON STREET, POST OFFICE BOX 1550, FORT MYERS, FLORIDA, 33902-1550  
 PHONE: 941-334-0046