

## LEE COUNTY SURVEY MARK DESCRIPTION

DESIGNATION 2226 COUNTY LEE STATE FLORIDA  
 LOCATED IN SEC 8 TWP 45S RGE 23E USGS QUAD MAP PINE ISLAND CENTER

**TO REACH SURVEY MARK:**

FROM CHIQUITA BLVD, RUN WEST ALONG CAPECORAL PKWY 1.5 mi.± TO SANDS BLVD; THENCE RUN NORTH ON SANDS BLVD. 0.3 mi.± TO S.W. 45<sup>th</sup> ST; THENCE RUN WEST ON SW 45<sup>th</sup> ST. 400'± TO DISK "2226"

TYPE OF SET 3" LEE COUNTY PUBLIC WORKS ALUM. DISK IN PAVEMENT  
 MARK \_\_\_\_\_ DATE SET APRIL 23 1998

HORIZONTAL CONTROL ORIGINATED ON 2<sup>nd</sup> 1<sup>st</sup> ORDER CONTROL BY \_\_\_\_\_  
 ON 1927 DATUM. ON 1983 (1990 GPS ADJUSTMENT) DATUM.

COORDINATES (FT.) 2<sup>ND</sup> ORDER COORDINATES (FT.) 2<sup>ND</sup> ORDER  
 NORTHING (Y) \_\_\_\_\_ NORTHING (Y) 811985.80  
 EASTING (X) \_\_\_\_\_ EASTING (X) 645348.63

GRID FLORIDA TRANSVERSE MERCATOR RECOVERED BY \_\_\_\_\_  
 ZONE WEST DATE CONDITION \_\_\_\_\_  
 FIELD BOOK BWL#2 PAGE 1,16

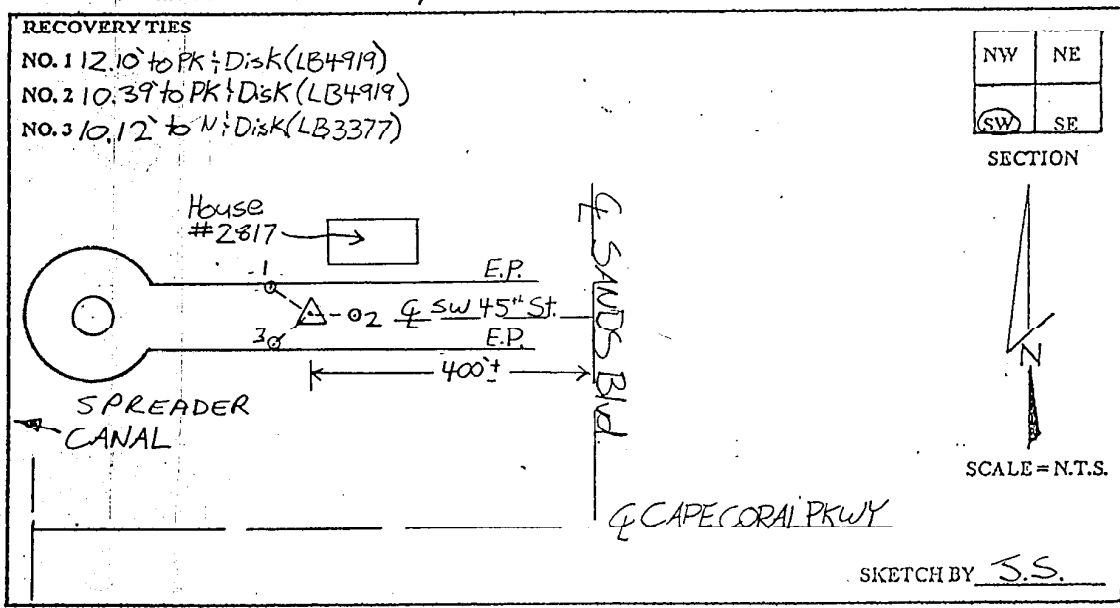

### JOHNSON ENGINEERING, INC.

CIVIL ENGINEERS - LAND SURVEYORS  
 2158 JOHNSON STREET, POST OFFICE BOX 1550, FORT MYERS, FLORIDA, 33902-1550  
 PHONE: 941-334-0046