

LEE COUNTY  
SURVEY MARK DESCRIPTION

DESIGNATION 2102 COUNTY LEE STATE FLORIDA  
 LOCATED IN SEC 20 TWP 45S RGE 27E USGS QUAD MAP ALVA SW

TO REACH SURVEY MARK:  
 FROM ALABAMA ROAD, RUN SOUTHEASTERLY ALONG S.R.-82 1.5 mi.± TO  
 PARKDALE BLVD; THENCE RUN NORTHERLY ALONG PARKDALE BLVD. 0.4 mi.± TO  
 SOURFERIE ROAD; THENCE RUN NORTH WESTERLY ALONG SOURFERIE ROAD  
 TO HOUSE #341.

TYPE OF SET 6" ROUND CONCRETE MONUMENT W/ 3" LEE COUNTY  
 MARK PUBLIC WORKS DISK DATE SET JUNE 19 19 98  
 HORIZONTAL CONTROL ORIGINATED ON 2ND 1ST ORDER CONTROL BY \_\_\_\_\_  
 ON 1927 DATUM. ON 1983 (1990 GPS ADJUSTMENT) DATUM.  
 COORDINATES (FT.) 2ND ORDER COORDINATES (FT.) 2ND ORDER  
 NORTHING (Y) \_\_\_\_\_ NORTHING (X) 807040.61  
 EASTING (X) \_\_\_\_\_ EASTING (X) 774096.56  
 GRID FLORIDA TRANSVERSE MERCATOR RECOVERED BY \_\_\_\_\_  
 ZONE WEST DATE CONDITION \_\_\_\_\_  
 FIELD BOOK BWL #4 PAGE 10

RECOVERY TIES

- NO. 1 335°-37.30' to PK: Disk in W.P.P. (LB4919)
- NO. 2 152°-53.86' to PK: Disk (LB4919)
- NO. 3 196°-21.37' to PK: Disk (LB4919)
- NO. 4 296°-68.90' to PK: Disk (Lehigh Corp. PCP)

NW	NE
SW	SE

SECTION

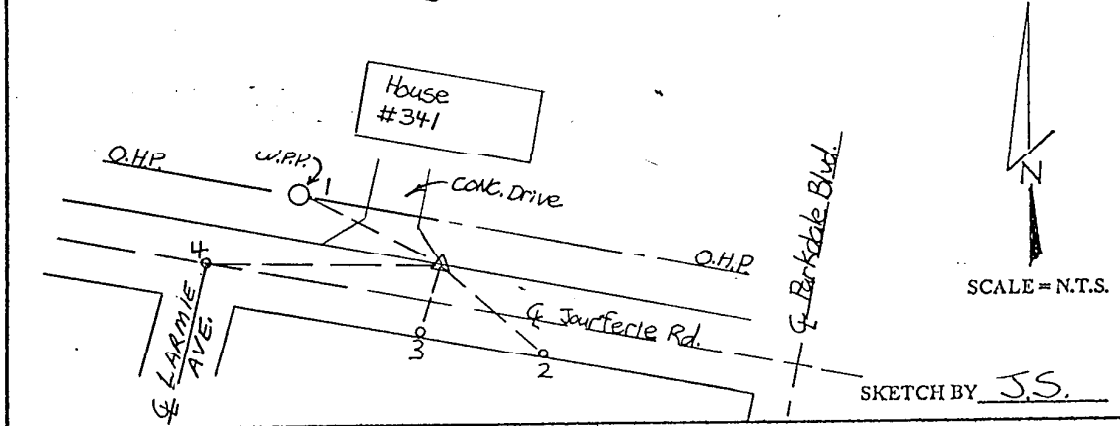

JOHNSON ENGINEERING, INC.

CIVIL ENGINEERS - LAND SURVEYORS

2158 JOHNSON STREET, POST OFFICE BOX 1550, FORT MYERS, FLORIDA, 33902-1550

PHONE: 941-334-0046