

LEE COUNTY SURVEY MARK DESCRIPTION

DESIGNATION 2251 COUNTY LEE STATE FLORIDA
 LOCATED IN SEC 14 TWP 455 RGE 22E USGS QUAD MAP PINE ISLAND CENTER

TO REACH SURVEY MARK:
 FROM PINE ISLAND CENTER; RUN SOUTH ALONG STRINGFELLOW ROAD
 3.75 mi. ± TO SUBSTATION; THENCE RUN EAST ALONG A DIRT ACCESS
 ROAD 0.85 mi. ± TO DISK "2251"

TYPE OF SET 6" ROUND CONCRETE MONUMENT W/ 3" LEE COUNTY
 MARK PUBLIC WORKS DISK DATE SET APRIL 24 1998
 HORIZONTAL CONTROL ORIGINATED ON 2ND 1ST ORDER CONTROL BY _____
 ON _____ 1927 DATUM ON 1983 (1990 GPS ADJUSTMENT) DATUM.
 COORDINATES (FT.) 2251 ORDER _____ COORDINATES (FT.) 2251 ORDER _____
 NORTHING (Y) _____ NORTHING (Y) 810328.97
 EASTING (X) _____ EASTING (X) 628620.36
 GRID FLORIDA TRANSVERSE MERCATOR RECOVERED BY _____
 ZONE WEST DATE CONDITION _____
 FIELD BOOK BWL#2 PAGE 7

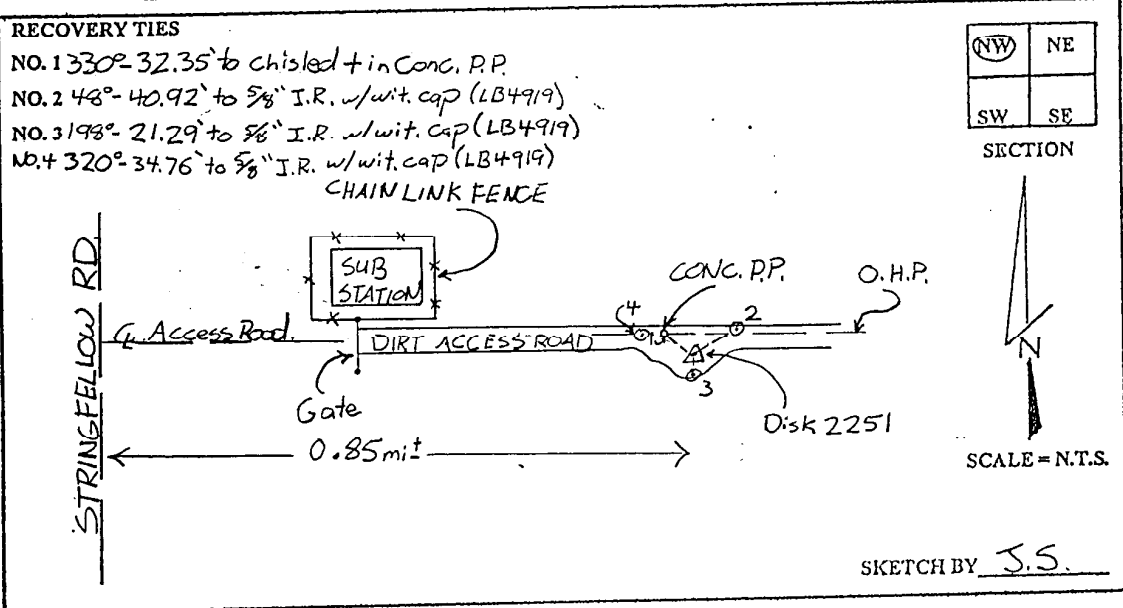

JOHNSON ENGINEERING, INC.

CIVIL ENGINEERS - LAND SURVEYORS

2158 JOHNSON STREET, POST OFFICE BOX 1550, FORT MYERS, FLORIDA, 33902-1550

PHONE: 941-334-0046