

LEE COUNTY  
SURVEY MARK DESCRIPTION

1102

DESIGNATION 2263 COUNTY LEE STATE FL.  
 LOCATED IN SEC 3 TWP 45S RGE 22E USGS QUAD MAP PINE ISLAND CENTER  
 TO REACH SURVEY MARK:

TYPE OF 3/4" ALUMINUM LEE COUNTY SURVEY CONTROL MARK SET IN CONCRETE  
 MARK 2263 DATE SET APRIL 23 1998  
 HORIZONTAL CONTROL ORIGINATED ON 2<sup>nd</sup>/1<sup>st</sup> ORDER CONTROL BY NATIONAL GEODETIC SURVEY (NGS)  
 ON 1927 DATUM. ON 1983 (1990 GPS Adjustment) DATUM.  
 COORDINATES (FT), 2<sup>nd</sup> ORDER COORDINATES (FT), 2<sup>nd</sup> ORDER  
 NORTHING (M) N/A NORTHING (M) 820126.3284  
 EASTING (M) N/A EASTING (M) 622050.5545  
 GRID FLORIDA TRANSVERSE MERCATOR RECOVERED BY \_\_\_\_\_  
 ZONE WEST DATE, CONDITION \_\_\_\_\_  
 FIELD BOOK BW # 2 PAGE 2

RECOVERY TIES

- NO. 1 SET IRON ROD
- NO. 2 SET IRON ROD
- NO. 3 SET IRON ROD

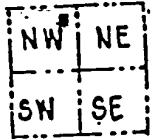

SECTION 3

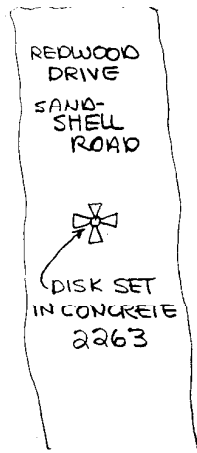
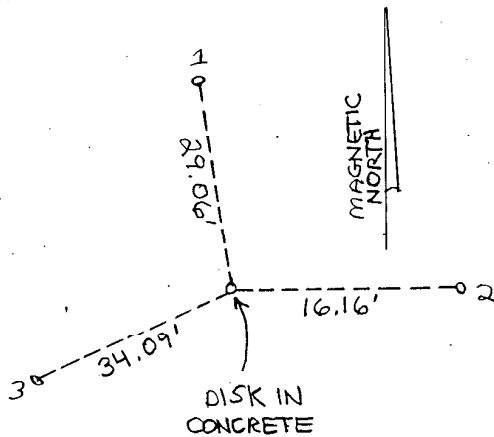

↑  
100' N.  
TO END  
OF ROAD

NOTE:  
"PARTY SPOT"  
THIS TARGET  
IN DANGER

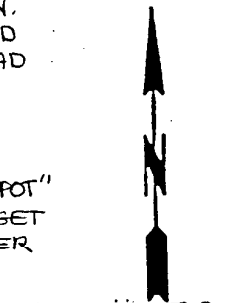

SCALE = N.T.S.

SKETCH BY DSH