

LEE COUNTY  
SURVEY MARK DESCRIPTION

1079

DESIGNATION 4123 COUNTY CHARLOTTE STATE FL.  
 LOCATED IN SEC \_\_\_\_\_ TWP 42 S RGE 25 E USGS QUAD MAP \_\_\_\_\_  
 TO REACH SURVEY MARK:

TYPE OF 3/4" ALUMINUM LEE COUNTY SURVEY CONTROL MARK ON 3/4" PIPE SET IN CONCRETE

MARK 4123 DATE SET APRIL 29 19 98

HORIZONTAL CONTROL ORIGINATED ON 2<sup>nd</sup>/1<sup>st</sup> ORDER CONTROL BY NATIONAL GEODETIC SURVEY (NGS)

ON 1927 DATUM. ON 1983 (1990 GPS Adjustment) DATUM.

COORDINATES (FT), 2<sup>nd</sup> ORDER COORDINATES (FT), 2<sup>nd</sup> ORDER

NORTHING (N) N/A NORTHING (N) 886160.4344

EASTING (E) N/A EASTING (E) 729278.7495

GRID FLORIDA TRANSVERSE MERCATOR RECOVERED BY \_\_\_\_\_

ZONE WEST DATE, CONDITION \_\_\_\_\_

FIELD BOOK JEI # 2 PAGE 45

RECOVERY TIES

- NO. 1 SET 1/2" STEEL PIN W/C LB642
- NO. 2 SET 1/2" STEEL PIN W/C LB642
- NO. 3 SET 1/2" STEEL PIN W/C LB642

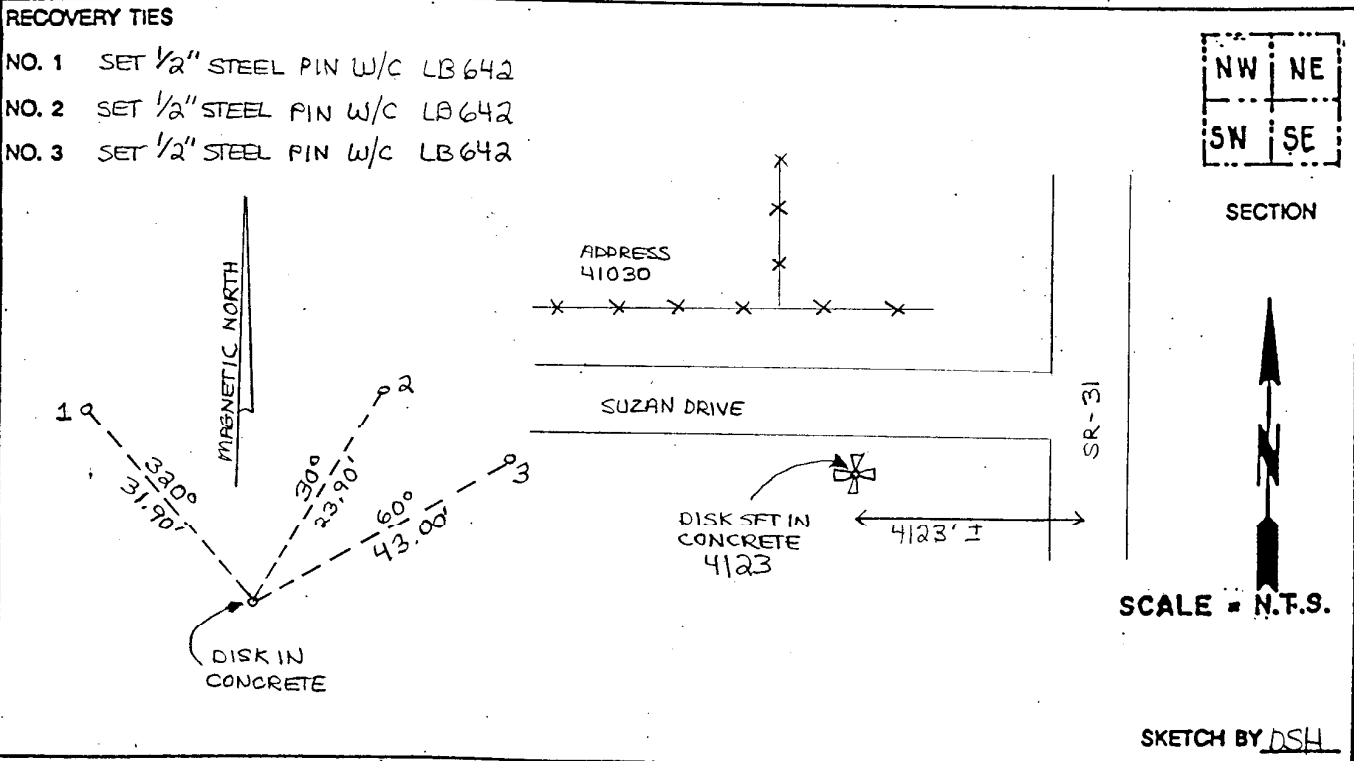

JOHNSON ENGINEERING, INC.  
 CIVIL ENGINEERS LAND SURVEYORS

2156 JOHNSON STREET, POST OFFICE BOX 1550, FORT MYERS, FLORIDA, 33902-1550  
 PHONE (941) 334-0046