

# LEE COUNTY SURVEY MARK DESCRIPTION

1025

DESIGNATION 2272 COUNTY LEE STATE FL.  
 LOCATED IN SEC 28 TWP 44 S RGE 22 E USGS QUAD MAP PINE ISLAND CENTER  
 TO REACH SURVEY MARK:

TYPE OF 3/4" ALUMINUM LEE COUNTY SURVEY CONTROL MARK SET IN CONCRETE  
 MARK 2272 DATE SET APRIL 23 19 98  
 HORIZONTAL CONTROL ORIGINATED ON 2<sup>nd</sup>/1<sup>st</sup> ORDER CONTROL BY NATIONAL GEODETIC SURVEY (NGS)  
 ON 1927 DATUM. ON 1983 (1990 GPS Adjustment) DATUM.  
 COORDINATES (FT), 2<sup>nd</sup> ORDER COORDINATES (FT), 2<sup>nd</sup> ORDER  
 NORTHING (M) N/A NORTHING (M) 828760.7800  
 EASTING (M) N/A EASTING (M) 620158.9152  
 GRID FLORIDA TRANSVERSE MERCATOR RECOVERED BY \_\_\_\_\_  
 ZONE WEST DATE, CONDITION \_\_\_\_\_  
 FIELD BOOK BW#2 PAGE 6

**RECOVERY TIES**

- NO. 1 SET PK NAIL W/DISK NW FACE OF POWER POLE
- NO. 2 SET IRON ROD LB 4919
- NO. 3 SET PK NAIL W/DISK LB 4919 SOUTH FACE OF POWER POLE

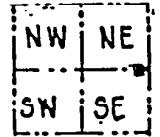

SECTION 28

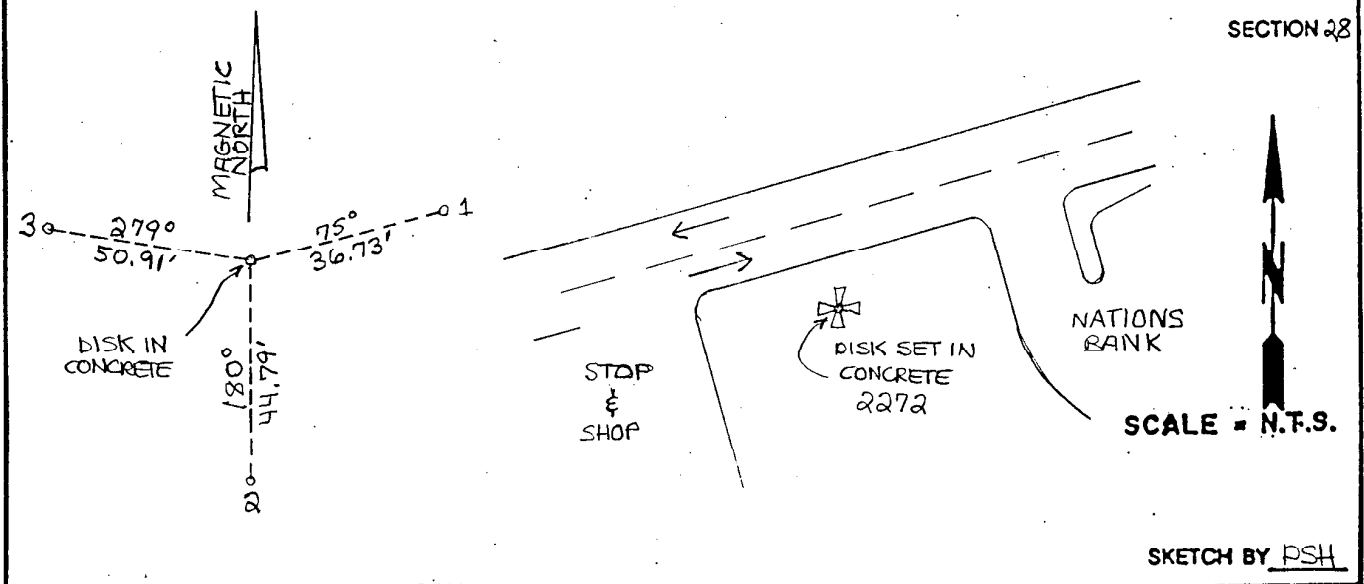

SKETCH BY PSH