

LEE COUNTY
SURVEY MARK DESCRIPTION

1007

DESIGNATION 2263 COUNTY LEE STATE FL.
 LOCATED IN SEC 3 TWP 45S RGE 22E USGS QUAD MAP PINE ISLAND CENTER
 TO REACH SURVEY MARK:

TYPE OF 3/4" ALUMINUM LEE COUNTY SURVEY CONTROL MARK SET IN CONCRETE
 MARK 2263 DATE SET APRIL 23 1998
 HORIZONTAL CONTROL ORIGINATED ON 2nd/1st ORDER CONTROL BY NATIONAL GEODETIC SURVEY (NGS)
 ON 1927 DATUM. ON 1983 (1990 GPS Adjustment) DATUM.
 COORDINATES (FT), 2nd ORDER COORDINATES (FT), 2nd ORDER
 NORTHING (M) N/A NORTHING (M) 820126.3284
 EASTING (M) N/A EASTING (M) 622050.5545
 GRID FLORIDA TRANSVERSE MERCATOR RECOVERED BY _____
 ZONE WEST DATE, CONDITION _____
 FIELD BOOK BW #2 PAGE 2

RECOVERY TIES

- NO. 1 SET IRON ROD
- NO. 2 SET IRON ROD
- NO. 3 SET IRON ROD

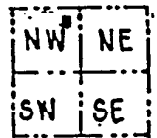

SECTION 3

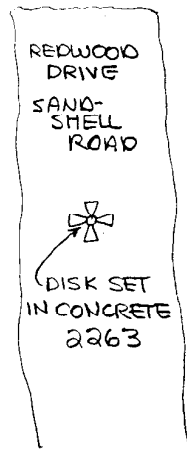
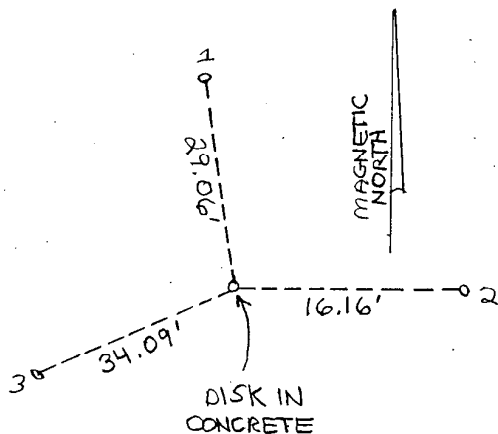

↑
100' N.
TO END
OF ROAD

NOTE:
"PARTY SPOT"
THIS TARGET
IN DANGER



SCALE = N.T.S.

SKETCH BY DSH