

LEE COUNTY SURVEY MARK DESCRIPTION

DESIGNATION FDNR 12-81-A52 COUNTY LEE STATE FL

LOCATED IN SEC 03 TWP 46 S. RGE 21 E. USGS QUAD MAP CAPTIVA, FL.

TO REACH SURVEY MARK FROM

From the intersection of Captiva Drive and the North end of Blind Pass bridge travel North along centerline of said Captiva Drive for +/- 1.51 Miles to a point. The monument is 51.8' Northwest of Wooden Power Pole It is 25.7' Southwest of the Ely gate post and 33.0' Southeast of Wly gate post of metal gate across sand drive. It is concrete monument w/ brass disk.

TYPE OF 4X4" CONCRETE MONUMENT W/ BRASS DISK

MARK FDNR 12-81-A52

DATE REF APRIL 24, 19 92

HORIZONTAL CONTROL ORIGINATED ON 2nd/1st ORDER CONTROL BY USC & GS / NGS

ON NAD'27 DATUM. ON NAD'83 DATUM.

COORDINATES (FT), 2ND ORDER

NORTHING (Y) 788861.060

EASTING (X) 438499.329.

COORDINATES (FT), 2ND ORDER

NORTHING (Y) 789030.895

EASTING (X) 594729.783

GRID FLORIDA TRANSVERSE MERCATOR

ZONE WEST

RECOVERED BY _____

DATE, CONDITION _____

FIELD BOOK 2029 PAGE 69

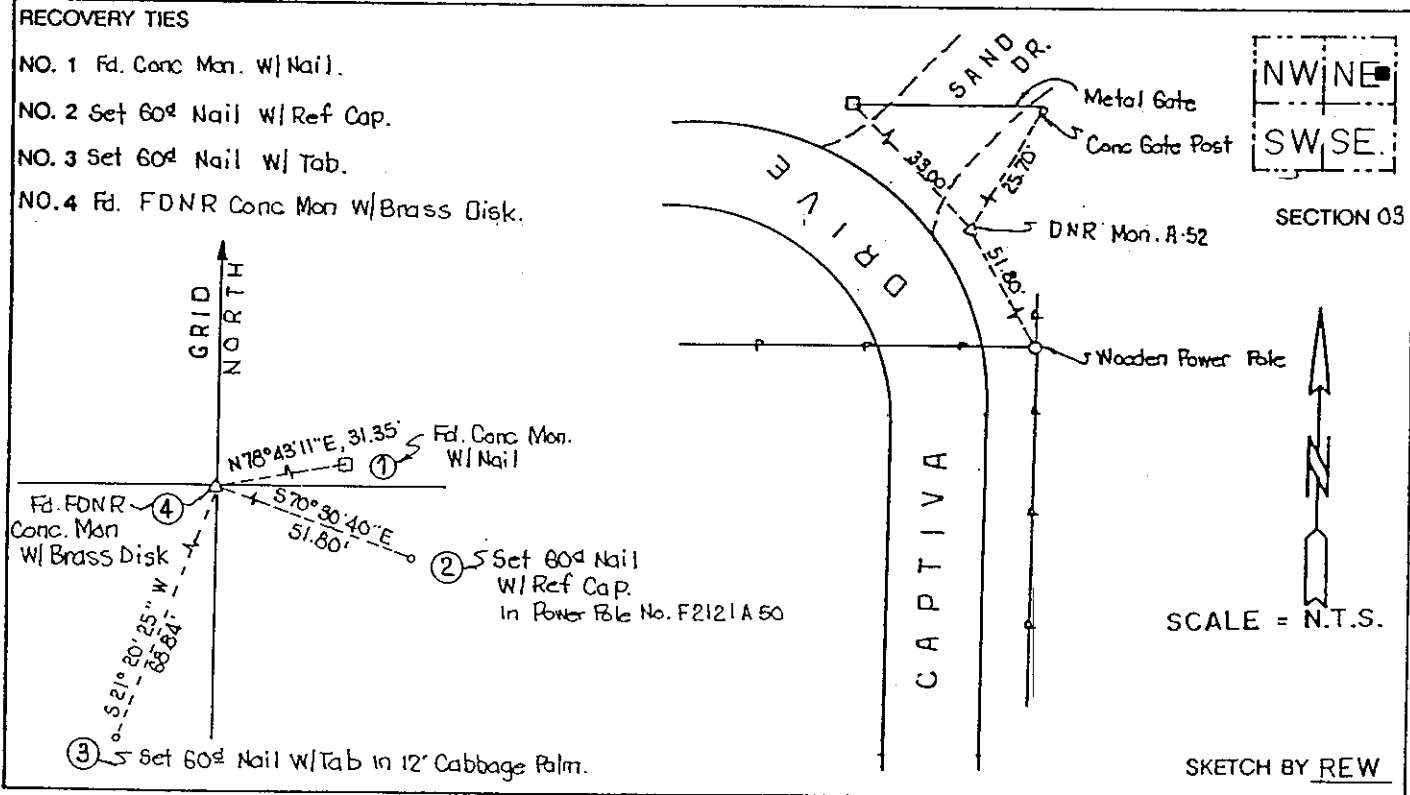

JOHNSON ENGINEERING, INC.

CIVIL ENGINEERS - LAND SURVEYORS

2158 JOHNSON STREET, POST OFFICE BOX 1550, FORT MYERS, FLORIDA, 33902-1550
PHONE (813) 334-0046

457