

# LEE COUNTY SURVEY MARK DESCRIPTION

DESIGNATION FDNR 12-81-A55 COUNTY LEE STATE FL  
 LOCATED IN SEC 02 TWP 46 S. RGE 21 E. USGS QUAD MAP WULFERT, FL.

TO REACH SURVEY MARK FROM  
 From the intersection of Captiva Drive and the North end of Blind Pass bridge travel North along centerline of said Captiva Drive for +/- 0.52 Miles to a point. The monument is 20' North of C/L of Sand Drive. It is 3.0' East of Ely edge of pav't. It is 8.0' West of 38" Australian pine tree. It is a concrete monument W/ brass disk.

TYPE OF 4" X 4" CONCRETE MONUMENT W/ BRASS DISK.

MARK FDNR 12-81-A55 DATE REF. APRIL 23, 19 92

HORIZONTAL CONTROL ORIGINATED ON 2ND/1ST ORDER CONTROL BY USC & GS / NGS

ON NAD'27 DATUM. ON NAD'83 DATUM

COORDINATES (FT), 2ND ORDER COORDINATES (FT), 2ND ORDER

NORTHING (Y) 783730.452

NORTHING (Y) 783900.272

EASTING (X) 439546.347

EASTING (X) 595776.800

GRID: FLORIDA TRANSVERSE MERCATOR

RECOVERED BY \_\_\_\_\_

ZONE WEST

DATE, CONDITION \_\_\_\_\_

FIELD BOOK 2029 PAGE 67

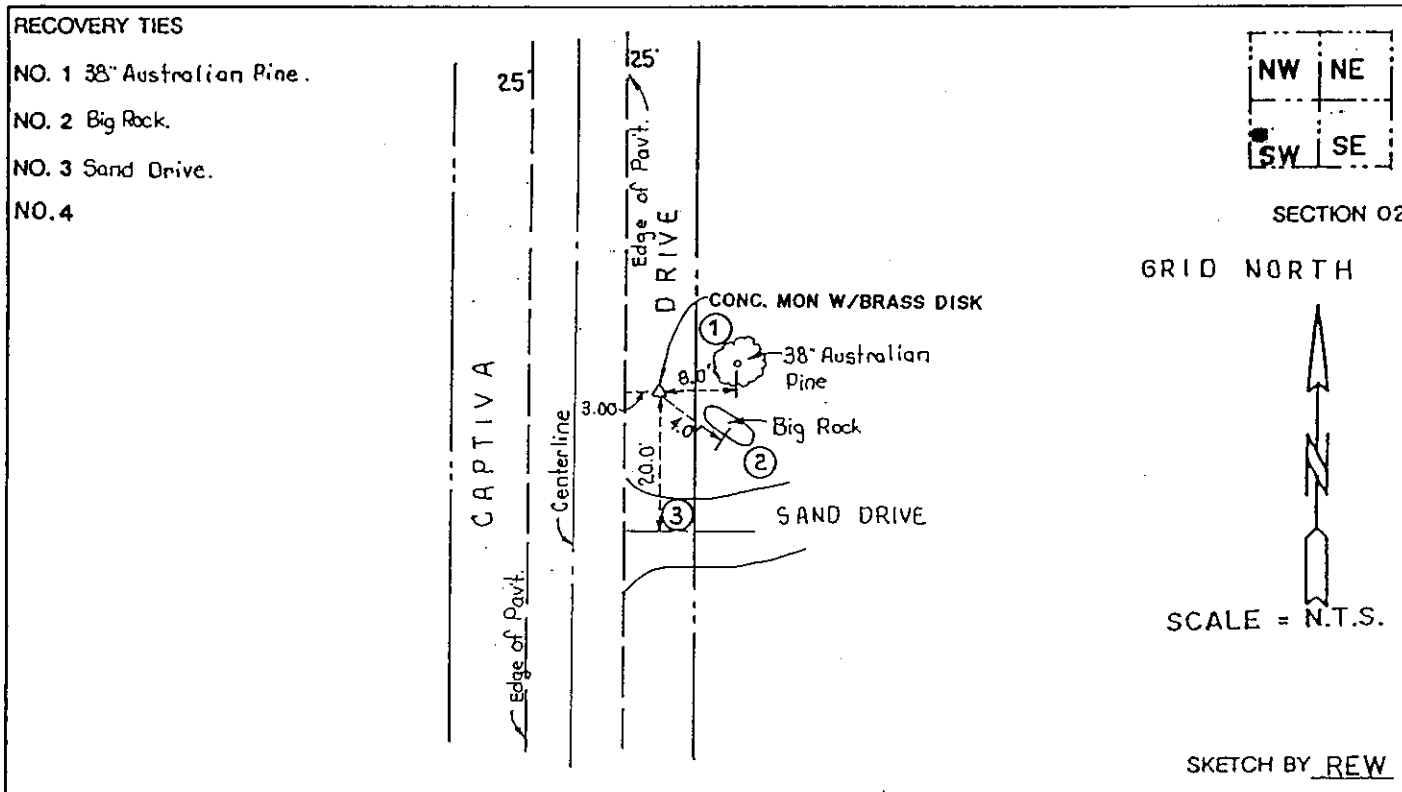

**JOHNSON ENGINEERING, INC.**  
 CIVIL ENGINEERS - LAND SURVEYORS  
 2158 JOHNSON STREET, POST OFFICE BOX 1350, FORT MYERS, FLORIDA, 33902-1350  
 PHONE (813) 334-0046

1455