

# LEE COUNTY SURVEY MARK DESCRIPTION

DESIGNATION 2424 COUNTY LEE STATE FLORIDA  
 LOCATED IN SEC 30 TWP 45S RGE 24E USGS QUAD MAP FORT MYERS SW  
 TO REACH SURVEY MARK:  
 FROM GLADIOLUS DRIVE, RUN NORTH EASTERLY ALONG MC GREGOR BLVD.  
 0.4 mi. ± TO WESTPORT DRIVE; THENCE RUN NORTH WESTERLY ALONG WESTPORT  
 DRIVE TO COMPASS POINT DRIVE; THENCE RUN NORTH EASTERLY ALONG COMPASS  
 POINT DRIVE 1200' ± TO LONGWATER CHASE COURT, THENCE RUN NORTH EASTERLY  
 ALONG LONGWATER CHASE CT. TO ADDRESS #11271 AND MARK.  
 TYPE OF SET 3" LEE COUNTY PUBLIC WORKS ALUM. DISK  
 MARK IN PAVEMENT DATE SET APRIL 23 1998  
 HORIZONTAL CONTROL ORIGINATED ON 2ND ST ORDER CONTROL BY \_\_\_\_\_  
 ON \_\_\_\_\_ 1927 DATUM. ON 1983 (1990 GPS ADJUSTMENT) DATUM.  
 COORDINATES (FT) 2ND ORDER COORDINATES (FT) 2ND ORDER  
 NORTHING (Y) \_\_\_\_\_ NORTHING (Y) 798281.72  
 EASTING (X) \_\_\_\_\_ EASTING (X) 674960.64  
 GRID FLORIDA TRANSVERSE MERCATOR RECOVERED BY \_\_\_\_\_  
 ZONE WEST DATE CONDITION \_\_\_\_\_  
 FIELD BOOK BWL #1 PAGE 48

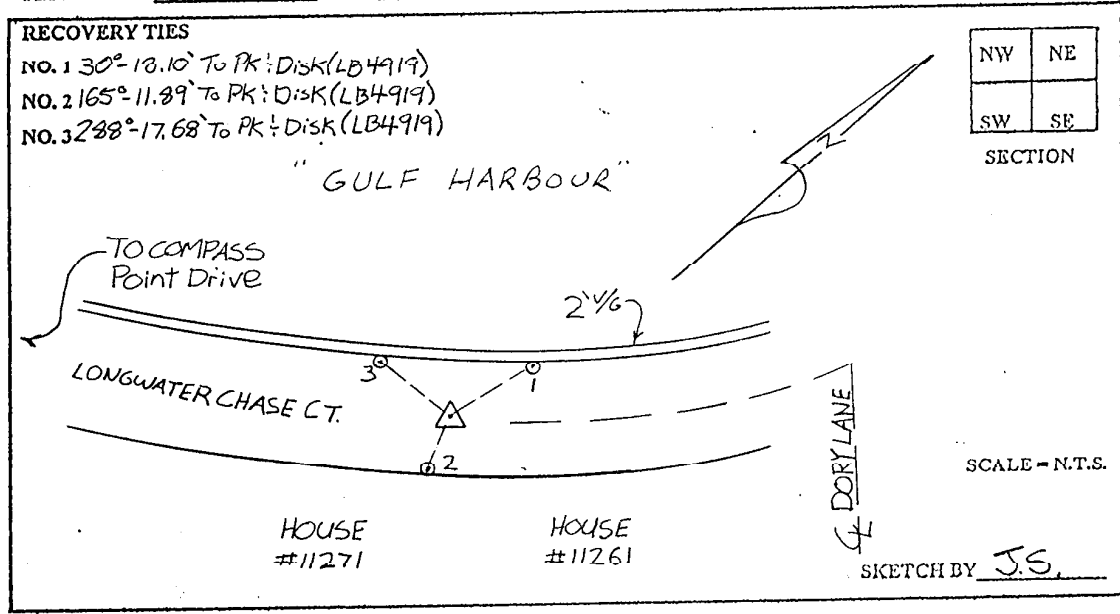

## JOINSON ENGINEERING, INC.

CIVIL ENGINEERS - LAND SURVEYORS  
 2158 JOHNSON STREET, POST OFFICE BOX 1550, FORT MYERS, FLORIDA, 33902-1550  
 PHONE: 941-334-0046