

LEE COUNTY
SURVEY MARK DESCRIPTION

DESIGNATION 2012 COUNTY LEE STATE FLORIDA
 LOCATED IN SEC 36 TWP 45S RGE 27E USGS QUAD MAP ALVA SE

TO REACH SURVEY MARK:
 FROM COLONIAL BLVD. EXTENSION; RUN SOUTH EASTERLY ALONG S.R.-82 15 mi. ± TO COLUMBUS BLVD.; THENCE RUN NORTHERLY ALONG COLUMBUS BLVD 0.5 mi. ± TO DAMEN ST. E.; THENCE RUN EAST ALONG DAMEN ST. E. TO HALLMARK AVE. S.; THENCE RUN SOUTH ALONG HALLMARK AVE. S. TO DELORES ST. E.

TYPE OF SET 6" ROUND CONCRETE MONUMENT w/ 3" LEE COUNTY PUBLIC
 MARK WORKS ALUM. DISK DATE SET JUNE 22 19 98

HORIZONTAL CONTROL ORIGINATED ON 2ND ORDER CONTROL BY _____
 ON 1927 DATUM. ON 1983 (1990 GPS ADJUSTMENT) DATUM.

COORDINATES (FT). 2ND ORDER COORDINATES (FT) 2ND ORDER
 NORTHING (Y) _____ NORTHING (Y) 797329.75
 EASTING (X) _____ EASTING (X) 796450.10

GRID FLORIDA TRANSVERSE MERCATOR RECOVERED BY _____
 ZONE WEST DATE CONDITION _____
 FIELD BOOK BWL #1 PAGE 3

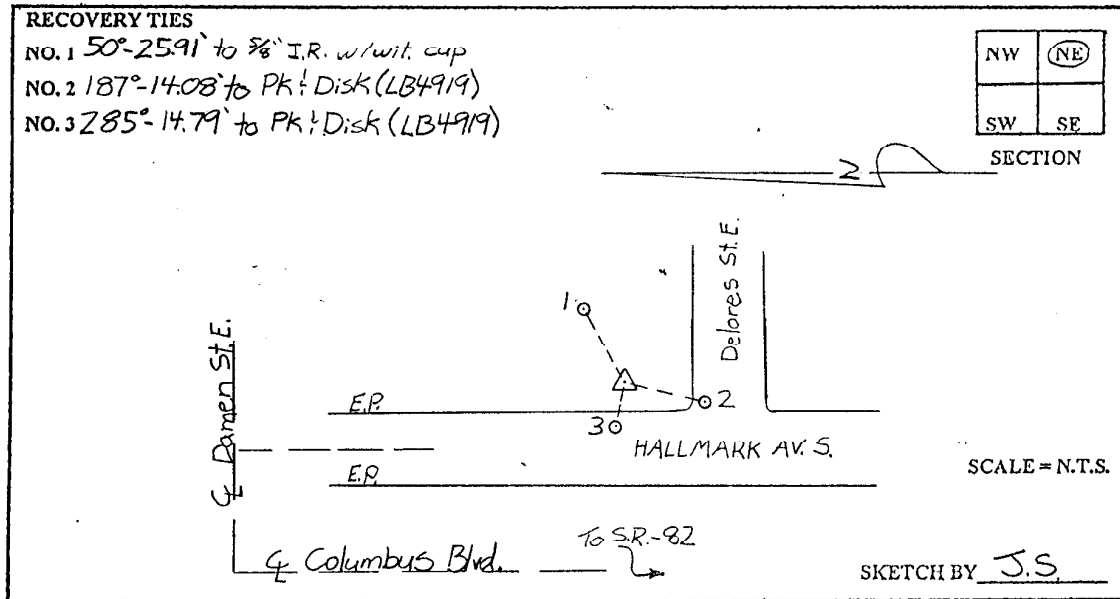

JOHNSON ENGINEERING, INC.

CIVIL ENGINEERS - LAND SURVEYORS

2158 JOHNSON STREET, POST OFFICE BOX 1550, FORT MYERS, FLORIDA, 33902-1550

PHONE: 941-334-0046