

LEE COUNTY  
SURVEY MARK DESCRIPTION

1309

DESIGNATION 237 COUNTY LEE STATE FL.  
LOCATED IN SEC 13 TWP 46 S RGE 23 E USGS QUAD MAP FORT MYERS BEACH FL.  
TO REACH SURVEY MARK:

TYPE OF \_\_\_\_\_  
MARK 237 DATE SET FEBRUARY 19 98  
HORIZONTAL CONTROL ORIGINATED ON 2<sup>nd</sup>/1<sup>st</sup> ORDER CONTROL BY NATIONAL GEODETIC SURVEY (NGS)  
ON 1927 DATUM. ON 1983 (1990 GPS Adjustment) DATUM.  
COORDINATES (FT), 2<sup>nd</sup> ORDER COORDINATES (FT), 2<sup>nd</sup> ORDER  
NORTHING (Y) \_\_\_\_\_ NORTHING (Y) 775154.923  
EASTING (X) \_\_\_\_\_ EASTING (X) 670639.041  
GRID FLORIDA TRANSVERSE MERCATOR RECOVERED BY \_\_\_\_\_  
ZONE WEST DATE, CONDITION \_\_\_\_\_  
FIELD BOOK DENI # 3 PAGE 4

RECOVERY TIES

- NO. 1
- NO. 2
- NO. 3

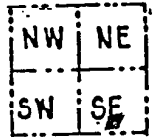

SECTION

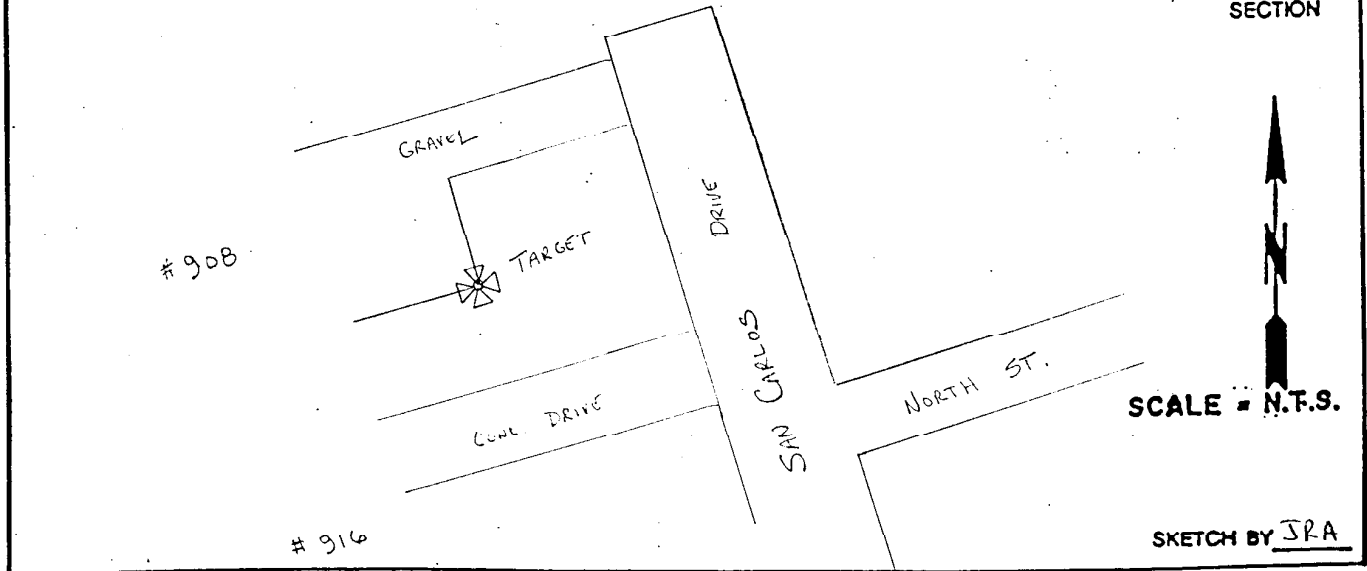

**JOHNSON ENGINEERING, INC.**  
CIVIL ENGINEERS LAND SURVEYORS  
2156 JOHNSON STREET, POST OFFICE BOX 1550, FORT MYERS, FLORIDA, 33902-1550  
PHONE 1941 334-0046