

LEE COUNTY  
SURVEY MARK DESCRIPTION

1289

DESIGNATION 230 COUNTY LEE STATE FL.  
LOCATED IN SEC 19 TWP 46 S. RGE 24 E. USGS QUAD MAP FORT MYERS BENCH FL.  
TO REACH SURVEY MARK:

TYPE OF PK NAIL & DISC DEVI & ASSOC.  
MARK 230 DATE SET FEBRUARY 19 98  
HORIZONTAL CONTROL ORIGINATED ON 2<sup>nd</sup>/1<sup>st</sup> ORDER CONTROL BY NATIONAL GEODETIC SURVEY (NGS)  
ON 1927 DATUM. ON 1983 (1990 GPS Adjustment) DATUM.  
COORDINATES (FT), 2<sup>nd</sup> ORDER COORDINATES (FT), 2<sup>nd</sup> ORDER  
NORTHING (N) \_\_\_\_\_ NORTHING (N) 769608.271  
EASTING (E) \_\_\_\_\_ EASTING (E) 672475.752  
GRID FLORIDA TRANSVERSE MERCATOR RECOVERED BY \_\_\_\_\_  
ZONE WEST DATE, CONDITION \_\_\_\_\_  
FIELD BOOK DEVI #3 PAGE 3

RECOVERY TIES

- NO. 1
- NO. 2
- NO. 3

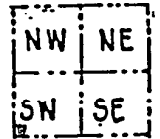

SECTION

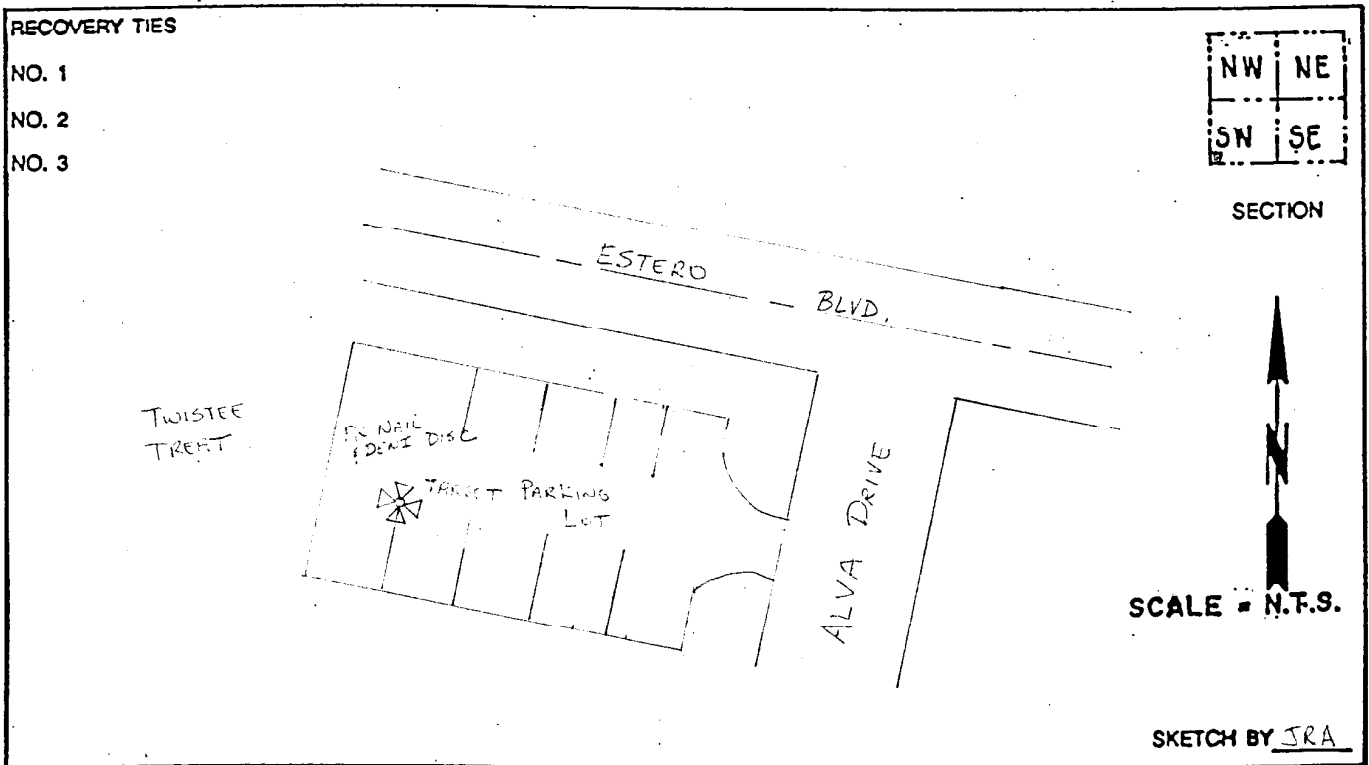

JOHNSON ENGINEERING, INC.  
CIVIL ENGINEERS LAND SURVEYORS  
2158 JOHNSON STREET, POST OFFICE BOX 1550, FORT MYERS, FLORIDA, 33902-1550  
PHONE (941) 334-0046