

LEE COUNTY SURVEY MARK DESCRIPTION

DESIGNATION 206 COUNTY LEE STATE FLORIDA
 LOCATED IN SEC 11 TWP 47S RGE 24E USGS QUAD MAP FORT MYERS BEACH

TO REACH SURVEY MARK:
 FROM U.S.-41, RUN WEST ALONG BONITA BEACH ROAD TO BONITA BEACH, THENCE CONTINUE ALONG BONITA BEACH ROAD NOW RUNNING NORTH OVER BIG HICKORY ISLAND TO LOVERS KEY STATE RECREATION AREA. MARK IS LOCATED IN THE PARKING AREA NEAR THE SHOWER AND CHANGING ROOM.

TYPE OF SET 6" ROUND CONCRETE MONUMENT W/ 3" LEE COUNTY PUBLIC
 MARK WORKS ALUM. DISK DATE SET JUNE 10 1998

HORIZONTAL CONTROL ORIGINATED ON ADJUST ORDER CONTROL BY _____
 ON 1927 DATUM. ON 1983 (1990 GPS ADJUSTMENT) DATUM.

COORDINATES (FT). 3000 ORDER _____ COORDINATES (FT) 3000 ORDER _____
 NORTHING (Y) _____ NORTHING (Y) 748196.05
 EASTING (X) _____ EASTING (X) 696650.90

GRID FLORIDA TRANSVERSE MERCATOR
 ZONE WEST
 FIELD BOOK BWL #4 PAGE 206

RECOVERED BY _____
 DATE CONDITION _____

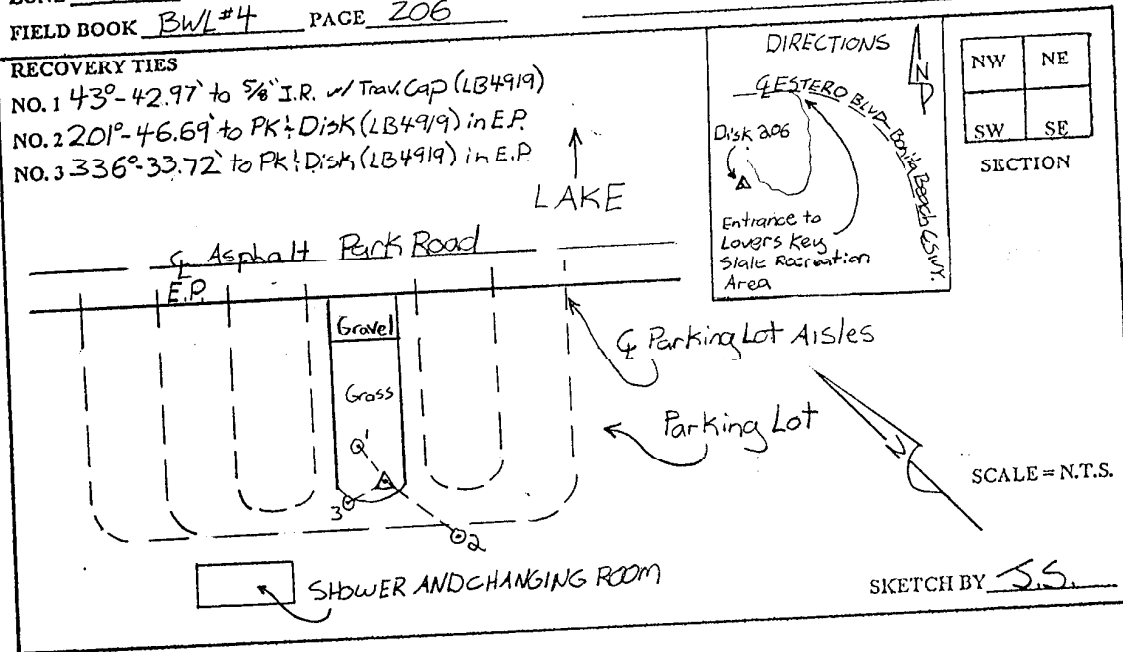

JOHNSON ENGINEERING, INC.

CIVIL ENGINEERS - LAND SURVEYORS
 2158 JOHNSON STREET, POST OFFICE BOX 1550, FORT MYERS, FLORIDA, 33902-1550
 PHONE: 941-334-0046