

LEE COUNTY SURVEY MARK DESCRIPTION

DESIGNATION 160 COUNTY LEE STATE FLORIDA
 LOCATED IN SEC 20 TWP 46S RGE 25E USGS QUAD MAP ESTERO

TO REACH SURVEY MARK:
 FROM ALKO ROAD, RUN SOUTHERLY ALONG US-41 3.0 mi± TO ELMWOOD ROAD, THENCE RUN WESTERLY ALONG ELMWOOD ROAD 0.2 mi± TO MOBILE HOME #4441. LOCATED AT THE INTERSECTION WITH SPICEWOOD LANE.

TYPE OF SET 6" ROUND CONCRETE MONUMENT W/ 3" LEE COUNTY PUBLIC
 MARK WORKS ALUM. DISK DATE SET JUNE 23 1998

HORIZONTAL CONTROL ORIGINATED ON 2ND TRIM ORDER CONTROL BY _____
 ON 1927 DATUM. ON 1983 (1990 GPS ADJUSTMENT) DATUM.

COORDINATES (FT.) 7000 ORDER _____ COORDINATES (FT.) 7000 ORDER _____
 NORTHING (Y) _____ NORTHING (Y) 771082.22
 EASTING (X) _____ EASTING (X) 712342.10

GRID FLORIDA TRANSVERSE MERCATOR RECOVERED BY _____
 ZONE WEST DATE CONDITION _____
 FIELD BOOK BWL #4 PAGE 13

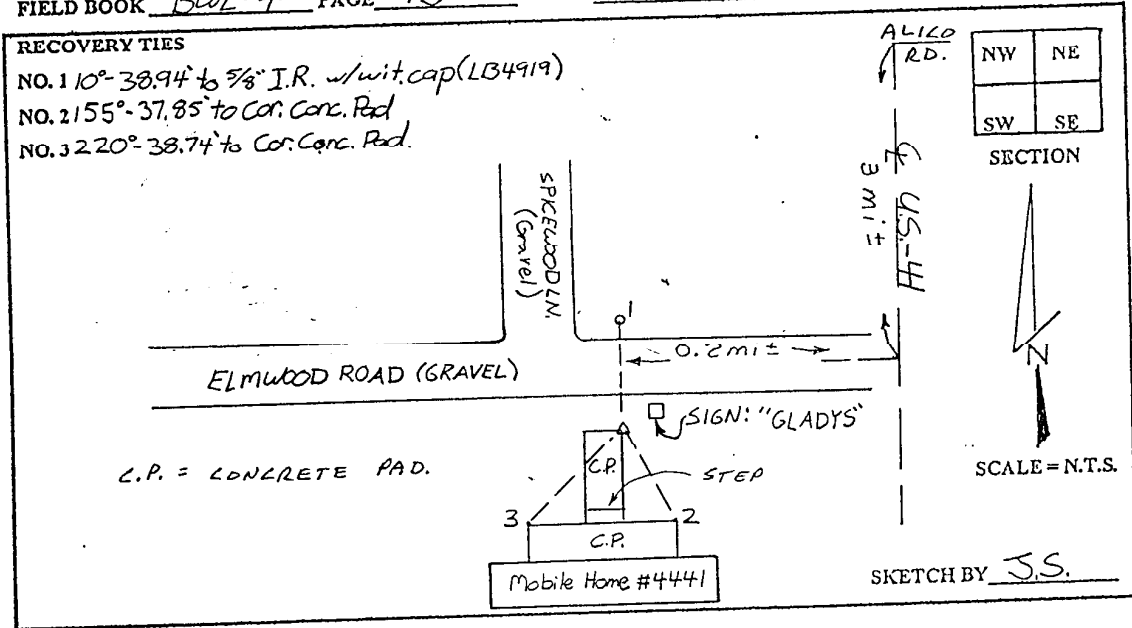

JOHNSON ENGINEERING, INC.

CIVIL ENGINEERS - LAND SURVEYORS

2158 JOHNSON STREET, POST OFFICE BOX 1550, FORT MYERS, FLORIDA, 33902-1550

PHONE: 941-334-0046