

LEE COUNTY SURVEY MARK DESCRIPTION

DESIGNATION 238 COUNTY LEE STATE FLORIDA
 LOCATED IN SEC 19 TWP 46S RGE 24E USGS QUAD MAP FORT MYERS BEACH
 TO REACH SURVEY MARK:
 FROM SUMMERLIN ROAD, RUN SOUTH ALONG SAN CARLOS BLVD. 2.5 mi. ±
 TO MAIN ST, THENCE RUN EASTERLY ALONG MAIN ST. TO THE INTERSECTION
 OF MAIN ST. AND SPANISH MAIN, THENCE CONTINUE RUNNING EASTERLY ALONG
 SPANISH MAIN TO THE INTERSECTION OF CORTEZ WAY, THENCE RUN NORTHERLY
 ALONG CORTEZ WAY TO MOBILE HOME #76.
 TYPE OF SET 6" ROUND CONCRETE MONUMENT w/ 3" LEE COUNTY PUBLIC WORKS
 MARK ALUM. DISK DATE SET JUNE 16 1998
 HORIZONTAL CONTROL ORIGINATED ON 2-11-47 ORDER CONTROL BY _____
 ON 1927 DATUM. ON 1983 (1990 GPS ADJUSTMENT) DATUM.
 COORDINATES (FT.) 2ND ORDER COORDINATES (FT.) 2ND ORDER
 NORTHING (X) _____ NORTHING (X) 772681.27
 EASTING (X) _____ EASTING (X) 675562.90
 GRID FLORIDA TRANSVERSE MERCATOR RECOVERED BY _____
 ZONE WEST DATE CONDITION _____
 FIELD BOOK BWL #4 PAGE 8

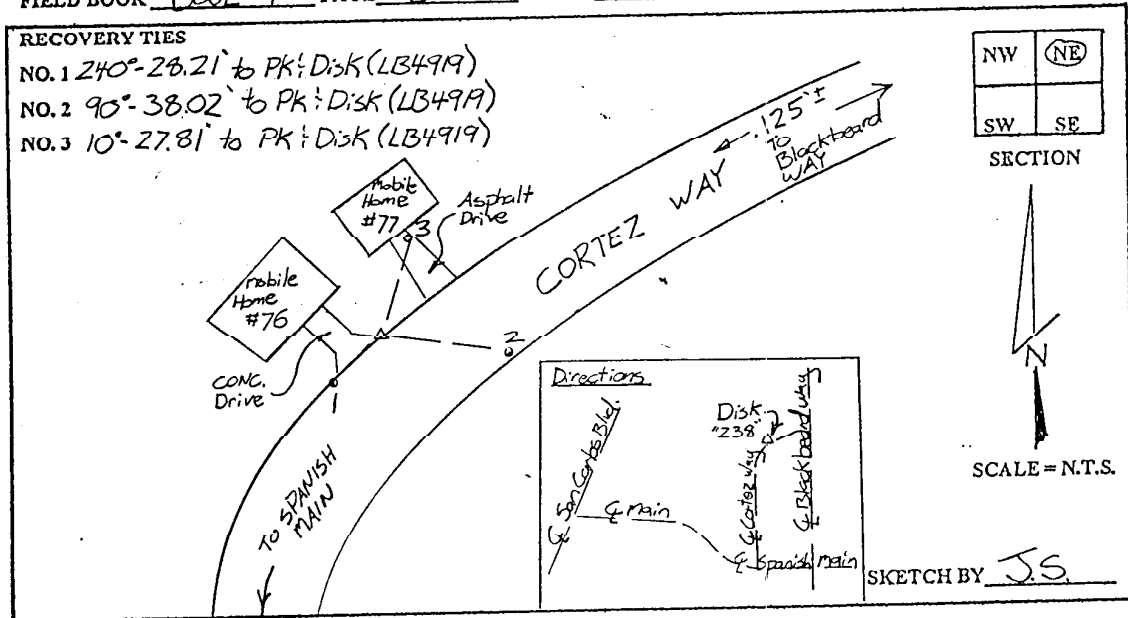

JOHNSON ENGINEERING, INC.

CIVIL ENGINEERS - LAND SURVEYORS

2158 JOHNSON STREET, POST OFFICE BOX 1550, FORT MYERS, FLORIDA, 33902-1550

PHONE: 941-334-0046