

## LEE COUNTY SURVEY MARK DESCRIPTION

DESIGNATION 257 COUNTY LEE STATE FLORIDA  
 LOCATED IN SEC 7 TWP 46 S. RGE 24 E. USGS QUAD MAP FT. MYERS BEACH

TO REACH SURVEY MARK:  
 FROM SUMMERLIN ROAD RUN SOUTH ON SANCARIOS BLVD. 0.3 mi.± TO INDIAN  
 PARK WAY, THENCE RUN WEST ALONG INDIAN PARK WAY 0.4 mi.± TO KIOWA DR.,  
 THENCE RUN NORTH ALONG KIOWA DR. THROUGH THE INTERSECTION WITH SIOUX ROAD  
 TO MOBILE HOME #48.

TYPE OF SET 6" ROUND CONCRETE MONUMENT W/ 3" LEE COUNTY  
 MARK PUBLIC WORKS ALUM. DISK DATE SET JUNE 9 1998  
 HORIZONTAL CONTROL ORIGINATED ON 2ND 1ST ORDER CONTROL BY \_\_\_\_\_  
 ON 1927 DATUM ON 1983 (1990 GPS ADJUSTMENT) DATUM.  
 COORDINATES (FT.) ORDER ORDER  
 NORTHING (Y) \_\_\_\_\_  
 EASTING (X) \_\_\_\_\_  
 GRID FLORIDA TRANSVERSE MERCATOR RECOVERED BY \_\_\_\_\_  
 ZONE WEST DATE CONDITION \_\_\_\_\_  
 FIELD BOOK BWL #4 PAGE 7

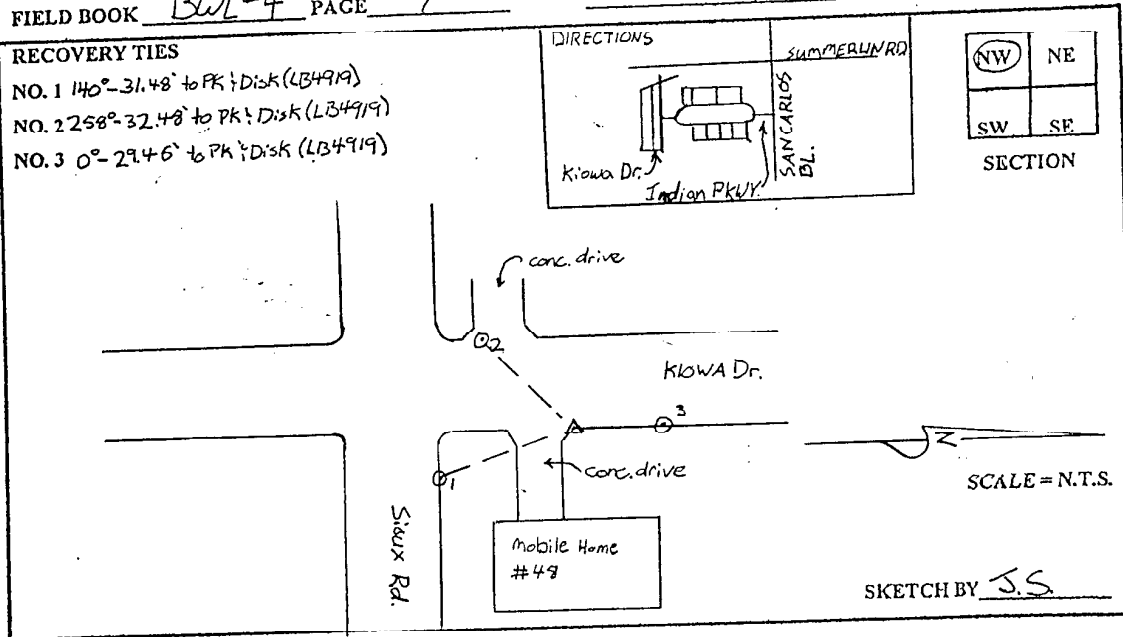

### JOHNSON ENGINEERING, INC.

CIVIL ENGINEERS - LAND SURVEYORS  
 2158 JOHNSON STREET, POST OFFICE BOX 1550, FORT MYERS, FLORIDA, 33902-1550  
 PHONE: 941-334-0046