

LEE COUNTY SURVEY MARK DESCRIPTION

DESIGNATION 2432 COUNTY LEE STATE FLORIDA
 LOCATED IN SEC 35 TWP 45S RGE 23E USGS QUAD MAP FORT MYERS SW

TO REACH SURVEY MARK:
 FROM MCGREGOR BLVD AND DAVIS ROAD; THENCE RUN NORTH ALONG
 DAVIS ROAD TO END; THENCE RUN WEST ALONG IONA ROAD 500'± TO
 ENTRANCE TO ST. CHARLES HARBOUR; THENCE RUN WESTERLY ALONG
 BLENHEIM TRAIL TO KNIGHTS BRIDGE COURT; THENCE RUN NORTH ON KNIGHT
 BRIDGE COURT 0.3 mi± TO MARK.

TYPE OF SET 3" LEE COUNTY PUBLIC WORKS ALUM. DISK
 MARK IN PAVEMENT DATE SET APRIL 23 1998

HORIZONTAL CONTROL ORIGINATED ON 2ND ORDER CONTROL BY _____
 ON 1927 DATUM. ON 1983 (1990 GPS ADJUSTMENT) DATUM.

COORDINATES (FT.) 2ND ORDER COORDINATES (FT.) 2ND ORDER
 NORTHING (Y) _____ NORTHING (X) 791852.35
 EASTING (X) _____ EASTING (Y) 662344.10

GRID FLORIDA TRANSVERSE MERCATOR RECOVERED BY _____
 ZONE WEST DATE CONDITION _____
 FIELD BOOK BW #1 PAGE 49

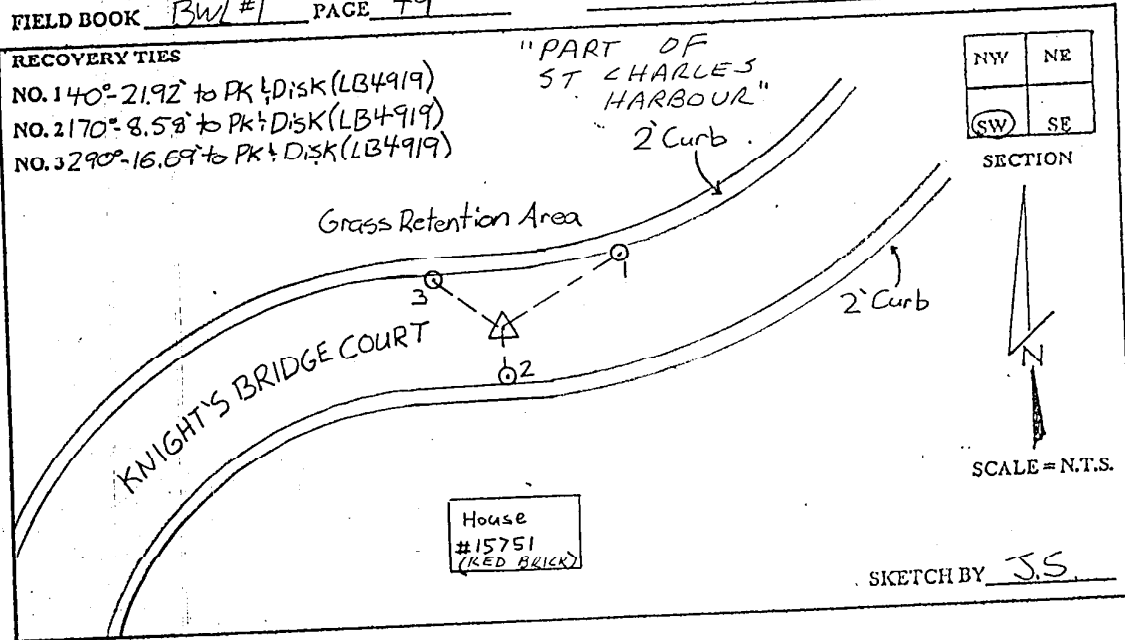

JOHNSON ENGINEERING, INC.

CIVIL ENGINEERS - LAND SURVEYORS
 2158 JOHNSON STREET, POST OFFICE BOX 1550, FORT MYERS, FLORIDA, 33902-1550
 PHONE: 941-334-0046