

LEE COUNTY
SURVEY MARK DESCRIPTION

DESIGNATION 2288 COUNTY LEE STATE FLORIDA
 LOCATED IN SEC 25 TWP 435 RGE 21E USGS QUAD MAP BOKEELIA

TO REACH SURVEY MARK:
 FROM PINE ISLAND CENTER; RUN NORTHERLY ALONG STRINGFELLOW ROAD
 TO END; THENCE RUN WEST ALONG MAIN ST 0.5 mi. ± TO SEATROUT LANE.

MARK IS LOCATED AT THE NORTHEAST CORNER OF A CONCRETE
 PAD ON THE NORTH SIDE OF MAIN ST. BETWEEN MARIE LN. + SEATROUT LN.

TYPE OF SET 6" ROUND CONCRETE MONUMENT W/ 3" LEE COUNTY
 MARK PUBLIC WORKS DISK DATE SET APRIL 20 1998

HORIZONTAL CONTROL ORIGINATED ON 2ND 1ST ORDER CONTROL BY _____
 ON 1927 DATUM. ON 1983 (1990 GPS ADJUSTMENT) DATUM.

COORDINATES (FT). 200 ORDER _____
 COORDINATES (FT) 200 ORDER _____
 NORTHING (X) 862340.61
 EASTING (X) 602150.25

GRID FLORIDA TRANSVERSE MERCATOR RECOVERED BY _____
 ZONE WEST DATE CONDITION _____
 FIELD BOOK BWL #2 PAGE 7

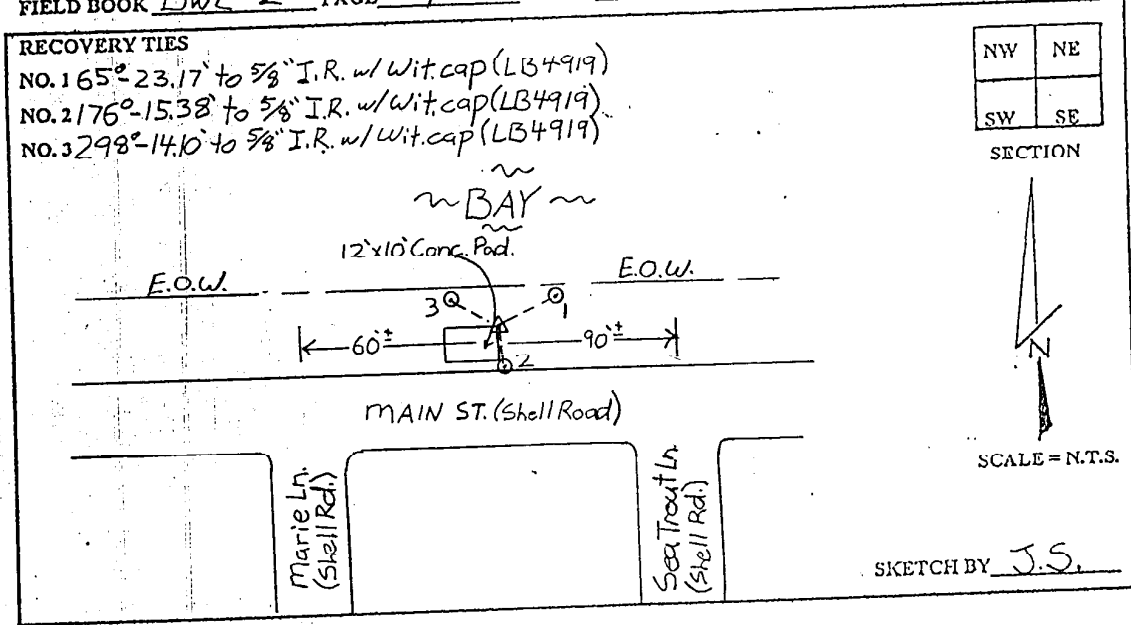

JOHNSON ENGINEERING, INC.

CIVIL ENGINEERS - LAND SURVEYORS

2158 JOHNSON STREET, POST OFFICE BOX 1550, FORT MYERS, FLORIDA, 33902-1550.

PHONE: 941-334-0046