

LEE COUNTY
SURVEY MARK DESCRIPTION

1111

DESIGNATION 4229 COUNTY LEE STATE FL.
 LOCATED IN SEC _____ TWP _____ RGE _____ USGS QUAD MAP _____
 TO REACH SURVEY MARK:

TYPE OF 3/4" ALUMINUM LEE COUNTY SURVEY CONTROL MARK ON 3/4" PIPE SET IN CONCRETE
 MARK 4229 DATE SET APRIL 28 1998
 HORIZONTAL CONTROL ORIGINATED ON 2nd/1st ORDER CONTROL BY NATIONAL GEODETIC SURVEY (NGS)
 ON 1927 DATUM. ON 1983 (1990 GPS Adjustment) DATUM.
 COORDINATES (FT), 2nd ORDER COORDINATES (FT), 2nd ORDER
 NORTHING (M) N/A NORTHING (M) 885655.0887
 EASTING (M) N/A EASTING (M) 687483.1748
 GRID FLORIDA TRANSVERSE MERCATOR RECOVERED BY _____
 ZONE WEST DATE, CONDITION _____
 FIELD BOOK JE1 # 2 PAGE 62

RECOVERY TIES

- NO. 1 SET FK NAIL W/DISK SW FACE 12" PINE
- NO. 2 SET FK NAIL W/DISK NW FACE 8" PINE
- NO. 3 SET FK NAIL W/DISK W FACE 10" PINE

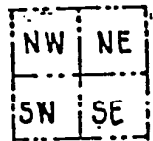

SECTION

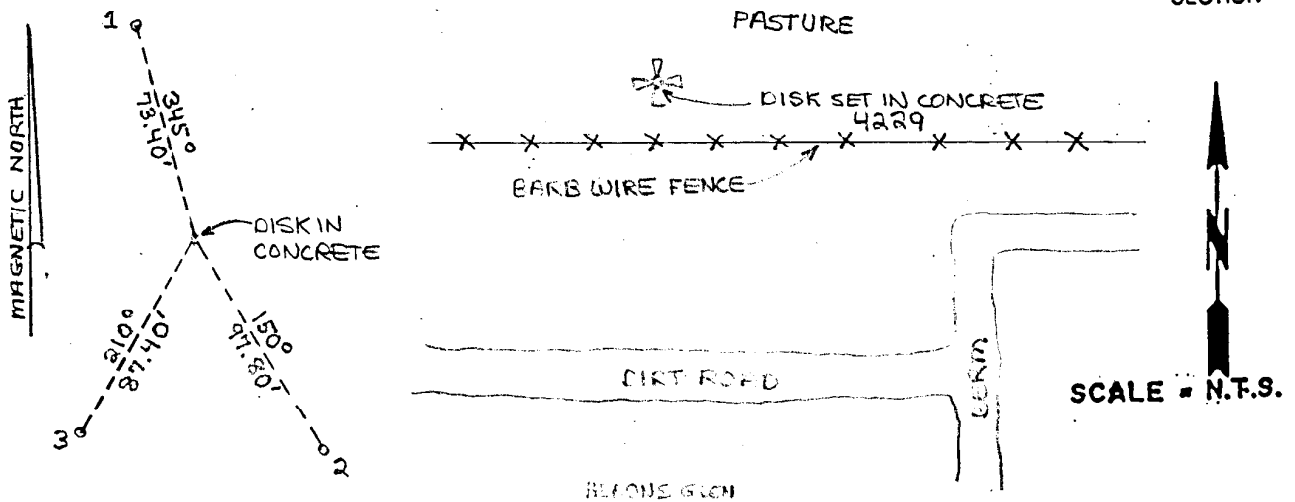

JOHNSON ENGINEERING, INC.

CIVIL ENGINEERS LAND SURVEYORS
 2156 JOHNSON STREET, POST OFFICE BOX 1550, FORT MYERS, FLORIDA, 33902-1550
 PHONE (941) 334-0046