

LEE COUNTY SURVEY MARK DESCRIPTION

1058

DESIGNATION 5118 COUNTY LEE STATE FL.

LOCATED IN SEC 4 TWP 44S RGE 25E USGS QUAD MAP FORT MYERS

TO REACH SURVEY MARK:

TYPE OF 3/4" ALUMINUM LEE COUNTY SURVEY CONTROL MARK SET IN PAVEMENT

MARK 5118 DATE SET APRIL 7 1998

HORIZONTAL CONTROL ORIGINATED ON 2nd/1st ORDER CONTROL BY NATIONAL GEODETIC SURVEY (NGS)

ON 1927 DATUM. ON 1983 (1990 GPS Adjustment) DATUM.

COORDINATES (FT). 2nd ORDER COORDINATES (FT). 2nd ORDER

NORTHING (M) N/A NORTHING (M) 852517.5100

EASTING (M) N/A EASTING (M) 713959.2551

GRID FLORIDA TRANSVERSE MERCATOR RECOVERED BY _____

ZONE WEST DATE, CONDITION _____

FIELD BOOK JEI # 2 PAGE 73

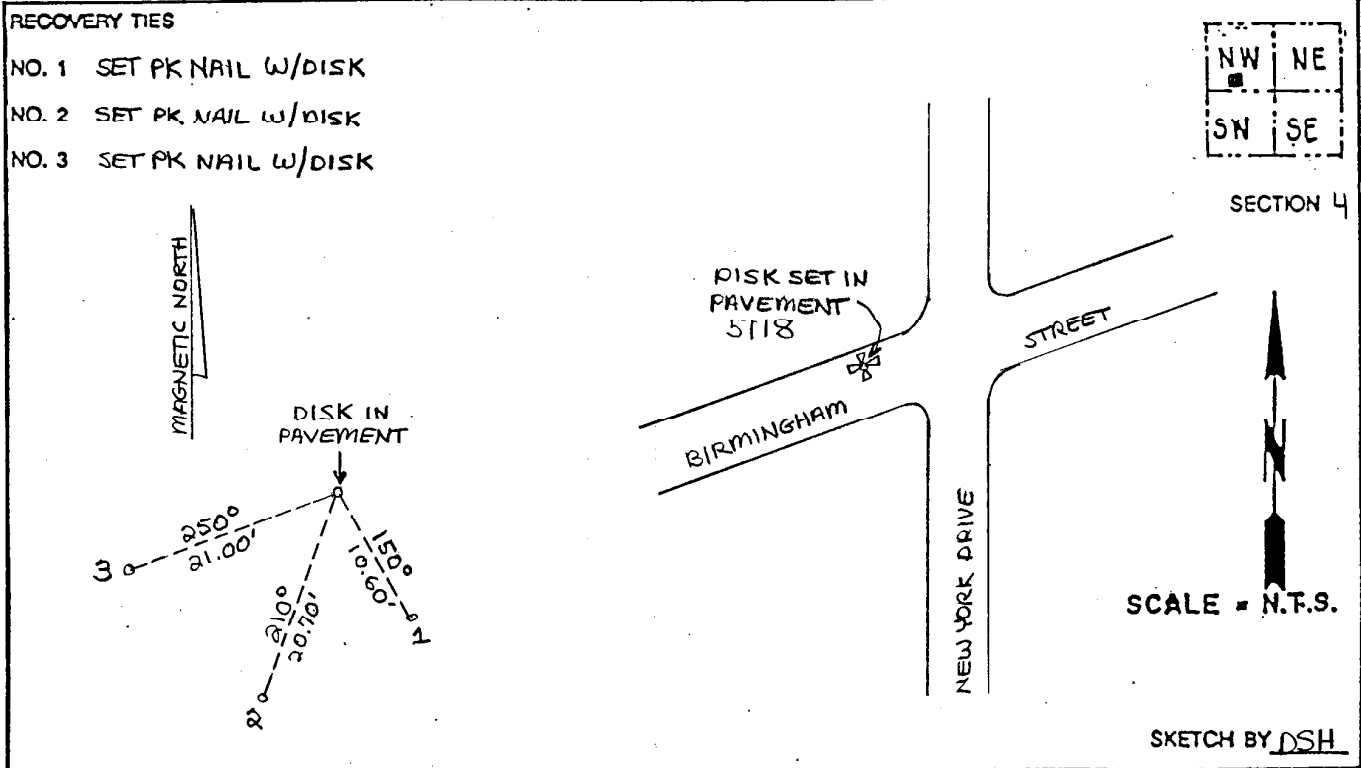

JOHNSON ENGINEERING, INC.
 CIVIL ENGINEERS - LAND SURVEYORS
 2158 JOHNSON STREET, POST OFFICE BOX 1550, FORT MYERS, FLORIDA, 33902-1550
 PHONE (941) 334-0046