

LEE COUNTY SURVEY MARK DESCRIPTION

1055

DESIGNATION 4123 COUNTY CHARLOTTE STATE FL.
 LOCATED IN SEC _____ TWP 42 S RGE 25 E USGS QUAD MAP _____
 TO REACH SURVEY MARK:

TYPE OF 3/4" ALUMINUM LEE COUNTY SURVEY CONTROL MARK ON 3/4" PIPE SET IN CONCRETE
 MARK 4123 DATE SET APRIL 29 19 98
 HORIZONTAL CONTROL ORIGINATED ON 2nd/1st ORDER CONTROL BY NATIONAL GEODETIC SURVEY (NGS)
 ON 1927 DATUM. ON 1983 (1990 GPS Adjustment) DATUM.
 COORDINATES (FT), 2nd ORDER COORDINATES (FT), 2nd ORDER
 NORTHING (M) N/A NORTHING (M) 886160.4344
 EASTING (M) N/A EASTING (M) 729278.7495
 GRID FLORIDA TRANSVERSE MERCATOR RECOVERED BY _____
 ZONE WEST DATE, CONDITION _____
 FIELD BOOK JEI # 2 PAGE 45

RECOVERY TIES

- NO. 1 SET 1/2" STEEL PIN W/C LB642
- NO. 2 SET 1/2" STEEL PIN W/C LB642
- NO. 3 SET 1/2" STEEL PIN W/C LB642

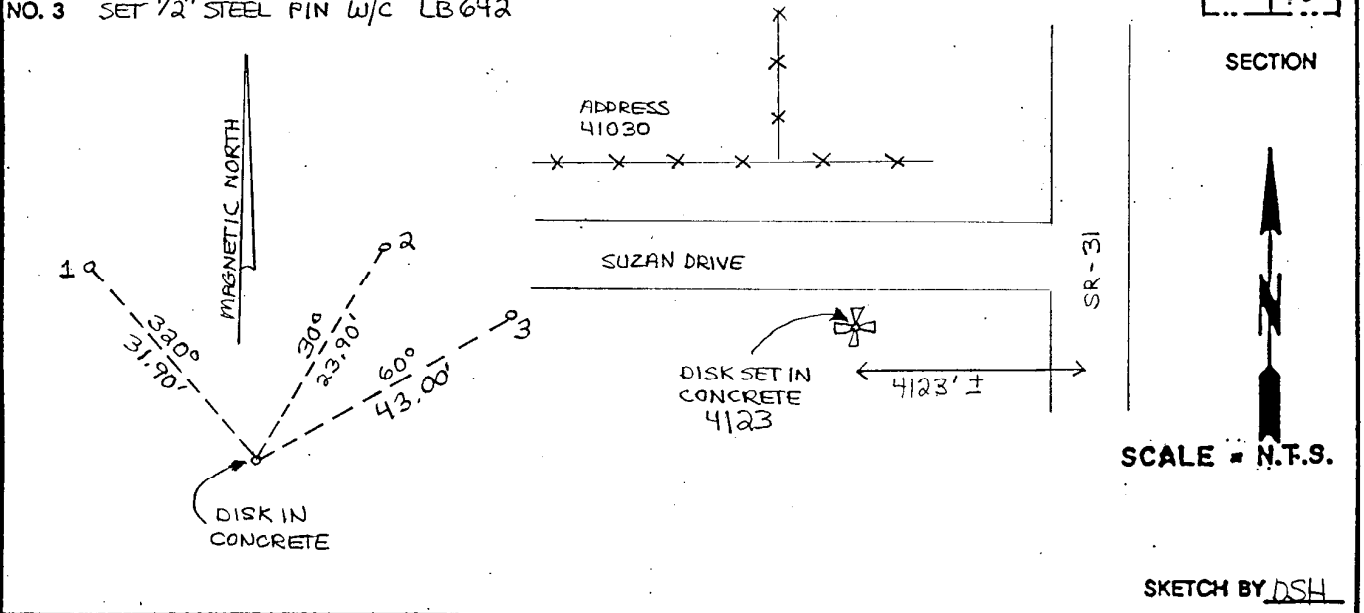

JOHNSON ENGINEERING, INC.
 CIVIL ENGINEERS LAND SURVEYORS
 2158 JOHNSON STREET, POST OFFICE BOX 1550, FORT MYERS, FLORIDA, 33902-1550
 PHONE (941) 334-0046