

LEE COUNTY SURVEY MARK DESCRIPTION

1050

DESIGNATION 5122 COUNTY LEE STATE FL.
 LOCATED IN SEC 7 TWP 44S RGE 25E USGS QUAD MAP FORT MYERS
 TO REACH SURVEY MARK:

TYPE OF 3/4" ALUMINUM LEE COUNTY SURVEY CONTROL MARK SET IN PAVEMENT
 MARK 5122 DATE SET APRIL 7 1998
 HORIZONTAL CONTROL ORIGINATED ON 2nd/1st ORDER CONTROL BY NATIONAL GEODETIC SURVEY (NGS)
 ON 1927 DATUM. ON 1983 (1990 GPS Adjustment) DATUM.
 COORDINATES (FT). 2nd ORDER COORDINATES (FT). 2nd ORDER
 NORTHING (M) N/A NORTHING (M) 845285.8983
 EASTING (M) N/A EASTING (M) 706870.9261
 GRID FLORIDA TRANSVERSE MERCATOR RECOVERED BY _____
 ZONE WEST DATE, CONDITION _____
 FIELD BOOK JEI # 2 PAGE 75

RECOVERY TIES

- NO. 1 SET PK NAIL W/DISK
- NO. 2 SET PK NAIL W/DISK
- NO. 3 SET PK NAIL W/DISK

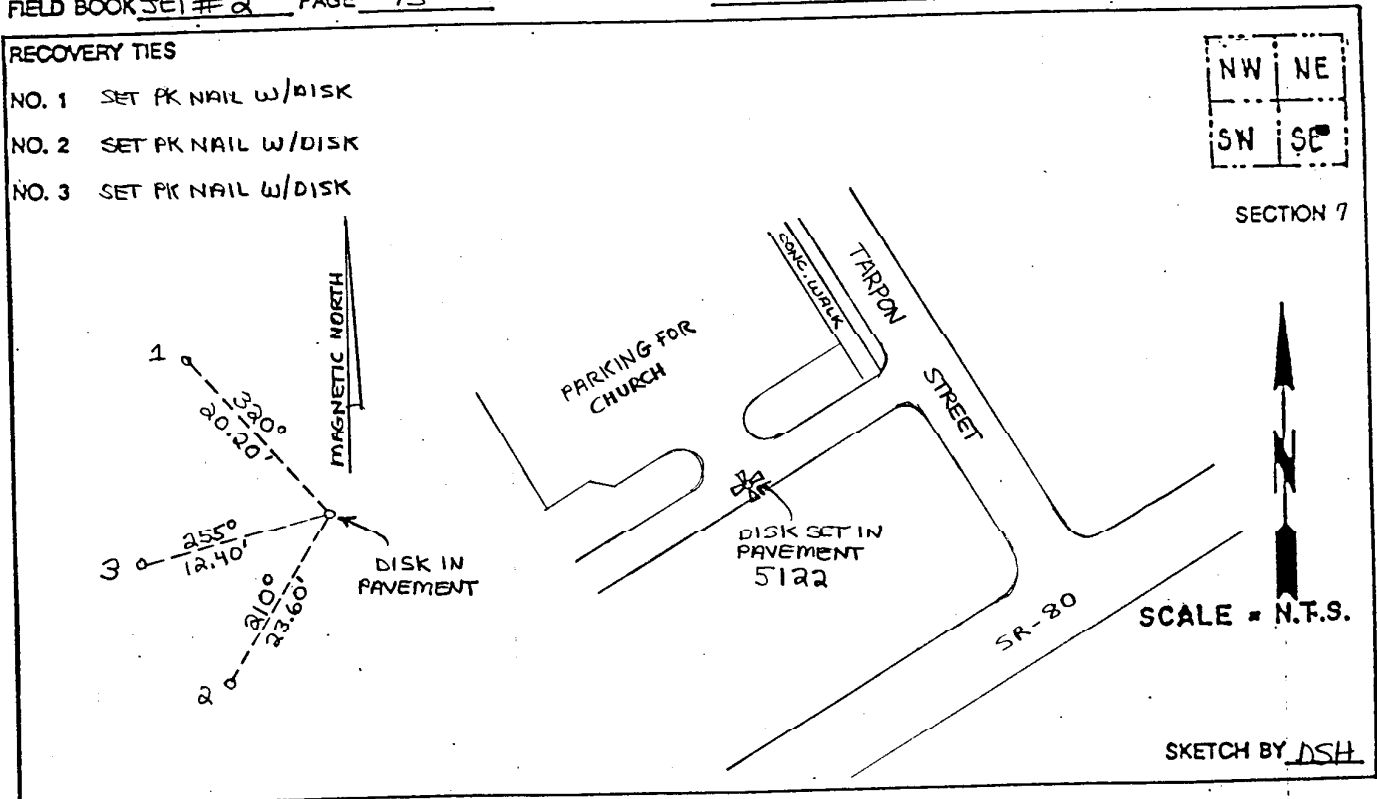

JOHNSON ENGINEERING, INC.
 CIVIL ENGINEERS - LAND SURVEYORS
 2158 JOHNSON STREET, POST OFFICE BOX 1550, FORT MYERS, FLORIDA, 33902-1550
 PHONE 19411 334-0046