

LEE COUNTY  
SURVEY MARK DESCRIPTION

1043

DESIGNATION 5116 COUNTY LEE STATE FL.

LOCATED IN SEC 34 TWP 43 S RGE 25 E USGS QUAD MAP FORT MYERS

TO REACH SURVEY MARK:

TYPE OF 3/4" ALUMINUM LEE COUNTY SURVEY CONTROL MARK SET IN PAVEMENT

MARK 5116 DATE SET APRIL 7 1998

HORIZONTAL CONTROL ORIGINATED ON 2<sup>nd</sup>/1<sup>st</sup> ORDER CONTROL BY NATIONAL GEODETIC SURVEY (NGS)

ON 1927 DATUM. ON 1983 (1990 GPS Adjustment) DATUM.

COORDINATES (FT), 2<sup>nd</sup> ORDER COORDINATES (FT), 2<sup>nd</sup> ORDER

NORTHING (M) N/A NORTHING (M) 854864.9166

EASTING (M) N/A EASTING (M) 720048.1070

GRID FLORIDA TRANSVERSE MERCATOR RECOVERED BY \_\_\_\_\_

ZONE WEST DATE, CONDITION \_\_\_\_\_

FIELD BOOK JEI # 2 PAGE 72

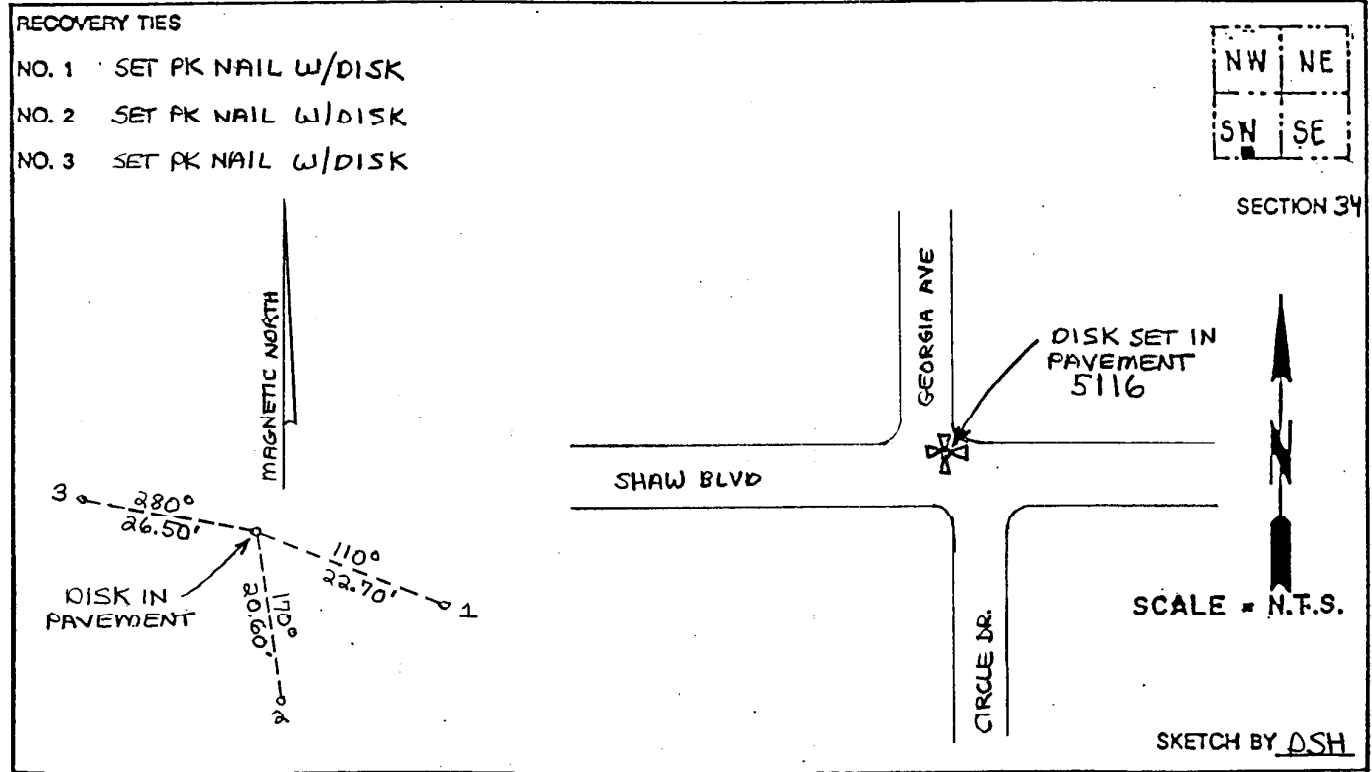

JOHNSON ENGINEERING, INC.

CIVIL ENGINEERS - LAND SURVEYORS

2158 JOHNSON STREET, POST OFFICE BOX 1550, FORT MYERS, FLORIDA, 33902-1550

PHONE (941) 334-0046