

LEE COUNTY
SURVEY MARK DESCRIPTION

1037

DESIGNATION 5105 COUNTY LEE STATE FL.
 LOCATED IN SEC 24 TWP 43 S RGE 25 E USGS QUAD MAP FORT MYERS
 TO REACH SURVEY MARK:

TYPE OF 3 1/4" ALUMINUM LEE COUNTY SURVEY CONTROL MARK SET IN PAVEMENT
 MARK 5105 DATE SET APRIL 7 1998
 HORIZONTAL CONTROL ORIGINATED ON 2nd/1st ORDER CONTROL BY NATIONAL GEODETIC SURVEY (NGS)
 ON 1927 DATUM. ON 1983 (1990 GPS Adjustment) DATUM.
 COORDINATES (FT), 2nd ORDER COORDINATES (FT), 2nd ORDER
 NORTHING (M) N/A NORTHING (M) 866122.0669
 EASTING (M) N/A EASTING (M) 731511.5127
 GRID FLORIDA TRANSVERSE MERCATOR RECOVERED BY _____
 ZONE WEST DATE, CONDITION _____
 FIELD BOOK JEI # 2 PAGE 65

RECOVERY TIES

- NO. 1 SET PK NAIL W/DISK
- NO. 2 SET PK NAIL W/DISK
- NO. 3 SET PK NAIL W/DISK

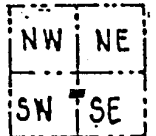

SECTION 24

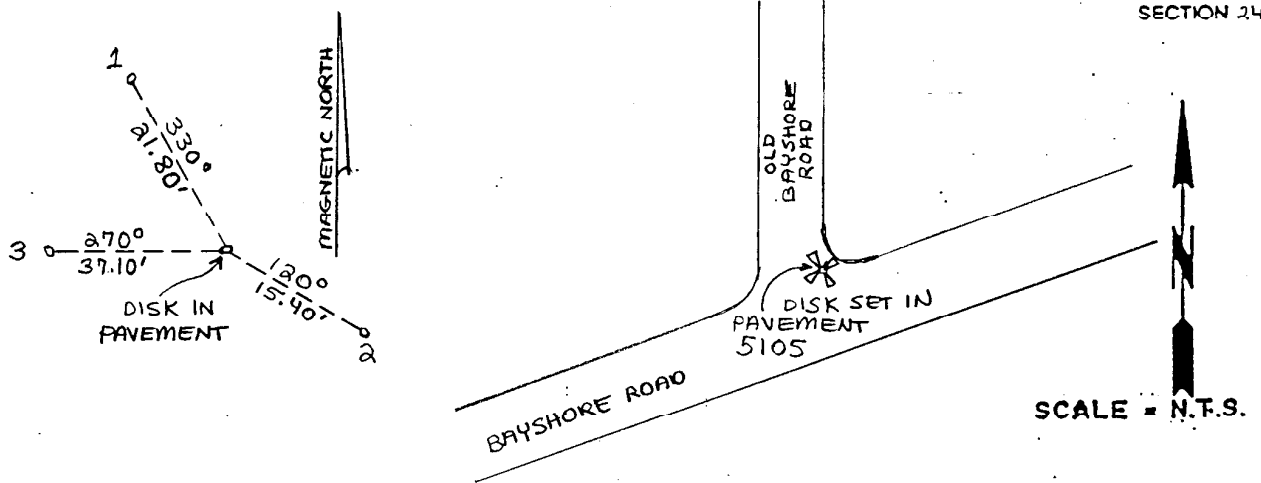

SCALE - N.T.S.

SKETCH BY DSH