

LEE COUNTY SURVEY MARK DESCRIPTION

1032

DESIGNATION 5131 COUNTY LEE STATE FL.

LOCATED IN SEC 2 TWP 44 S RGE 24 E USGS QUAD MAP FORT MYERS NW

TO REACH SURVEY MARK:

TYPE OF 3/4" ALUMINUM LEE COUNTY SURVEY CONTROL MARK SET IN PAVEMENT

MARK 5131 DATE SET APRIL 7 1998

HORIZONTAL CONTROL ORIGINATED ON 2nd/1st ORDER CONTROL BY NATIONAL GEODETIC SURVEY (NGS)

ON 1927 DATUM. ON 1983 (1990 GPS Adjustment) DATUM.

COORDINATES (FT), 2nd ORDER COORDINATES (FT), 2nd ORDER

NORTHING (M) N/A NORTHING (M) 848655.6726

EASTING (M) N/A EASTING (M) 696842.3073

GRID FLORIDA TRANSVERSE MERCATOR RECOVERED BY _____

ZONE WEST DATE, CONDITION _____

FIELD BOOK JEI # 4 PAGE 1

RECOVERY TIES

- NO. 1 SET PK NAIL W/DISK
- NO. 2 SET PK NAIL W/DISK
- NO. 3 SET PK NAIL W/DISK

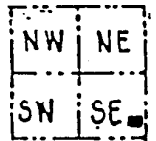

SECTION 2

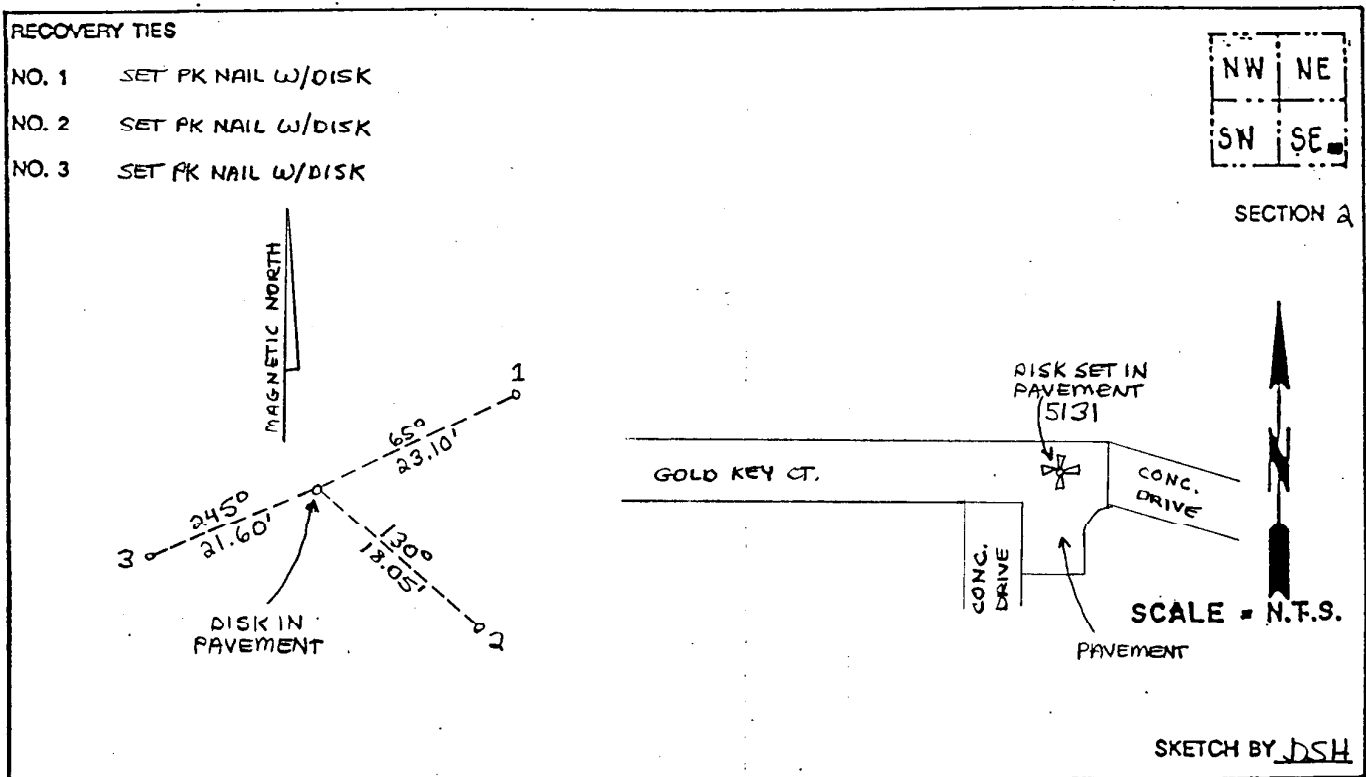

SKETCH BY JSH

JOHNSON ENGINEERING, INC.

CIVIL ENGINEERS - LAND SURVEYORS

2158 JOHNSON STREET, POST OFFICE BOX 1550, FORT MYERS, FLORIDA, 33902-1550

PHONE (941) 334-0046