

# LEE COUNTY SURVEY MARK DESCRIPTION



SURVEY CONTROL BY:  
DENI ASSOCIATES, INC.  
FORT MYERS, FLORIDA

MAPPING BY:  
WOOLPERT CONSULTANTS

DESIGNATION 1-02 48 26 (GPS 9051) COUNTY LEE STATE FL

LOCATED IN SEC 2 TWP 48 RGE 26 USGS QUAD MAP CORKSCREW SW

TO REACH SURVEY MARK FROM I75 & BONITA BEACH RD./CARREL RD. GO E.  
0.25 MI ; THENCE ALONG FARM RDS: S. 0.35 MI ; THENCE  
W. 0.3 MI ; THENCE S. 0.1 MI. ; THENCE W. 0.1 MI.  
TO MARK

TYPE OF 3" DIA ALUM. DISK IN CONG. 5" BLW. GRD., "LEE COUNTY  
MARK DENI ASSOCIATES 1990" DATE SET JAN 1991

HORIZONTAL CONTROL ORIGINATED ON <u>1st</u> ORDER	HORIZONTAL CONTROL ORIGINATED ON _____ ORDER
CONTROL BASED ON FLORIDA HIGH PRECISION GPS NETWORK,	CONTROL BY _____
ON NORTH AMERICAN DATUM OF 1983, 1990 ADJUSTMENT	ON _____ DATUM
COORDINATES (FT), <u>1st</u> ORDER	COORDINATES (FT), _____ ORDER
NORTHING (Y) <u>723,790,399</u>	NORTHING (Y) _____
EASTING (X) <u>758,417,755</u>	EASTING (X) _____

GRID FLORIDA TRANSVERSE MERCATOR RECOVERED BY \_\_\_\_\_  
ZONE WEST SCALE FACTOR ,999953 DATE, CONDITION \_\_\_\_\_  
FIELD BOOK \_\_\_\_\_ PAGE \_\_\_\_\_

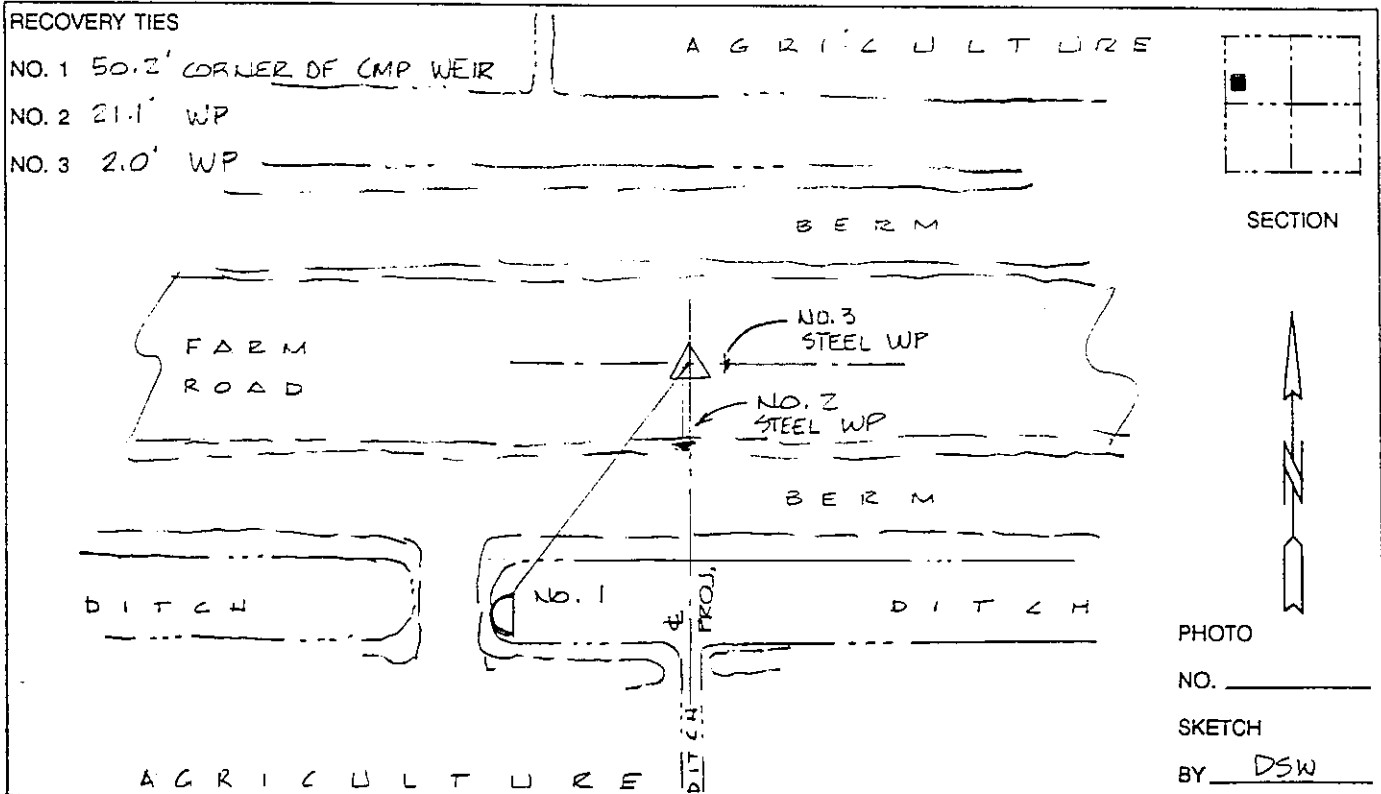

VERTICAL CONTROL ORIGINATED ON 2nd ORDER CONTROL ESTABLISHED BY N. G. S. AND F. D. O. T.  
ON NATIONAL GEODETIC VERTICAL DATUM OF 1929.  
ELEVATION (FT) \_\_\_\_\_, 3rd ORDER LEVEL BOOK \_\_\_\_\_ PAGE \_\_\_\_\_