

LEE COUNTY SURVEY MARK DESCRIPTION



SURVEY CONTROL BY:
DENI ASSOCIATES, INC.
FORT MYERS, FLORIDA

MAPPING BY:
WOOLPERT CONSULTANTS

DESIGNATION 2-24-47-26 ^{GPS} (9053) COUNTY LEE STATE FL
 LOCATED IN SEC 24 TWP 47S RGE 26E USGS QUAD MAP CORKSCREW SW
 TO REACH SURVEY MARK FROM I75 & BONITA BEACH RD / CARREL RD; GO
E. 4.65 MI; THENCE N. 2.0 MI; THENCE E. 1.0 MI.
TO MARK.

TYPE OF 3" DIAMETER ALUMINUM DISK IN CONCRETE 0.1 FT. BELOW GROUND;
 MARK "LEE COUNTY DENI ASSOCIATES 1990" DATE SET 1991

HORIZONTAL CONTROL ORIGINATED ON 1st ORDER HORIZONTAL CONTROL ORIGINATED ON _____ ORDER
 CONTROL BASED ON FLORIDA HIGH PRECISION GPS NETWORK, CONTROL BY _____
 ON NORTH AMERICAN DATUM OF 1983, 1990 ADJUSTMENT ON _____ DATUM
 COORDINATES (FT), 1st ORDER COORDINATES (FT), _____ ORDER
 NORTHING (Y) 737,498,663 NORTHING (Y) _____
 EASTING (X) 767,915,577 EASTING (X) _____

GRID FLORIDA TRANSVERSE MERCATOR RECOVERED BY _____
 ZONE WEST SCALE FACTOR .999955 DATE, CONDITION _____
 FIELD BOOK _____ PAGE _____

RECOVERY TIES

- NO. 1 2.6' WP
- NO. 2 32.3'
- NO. 3 39.5'

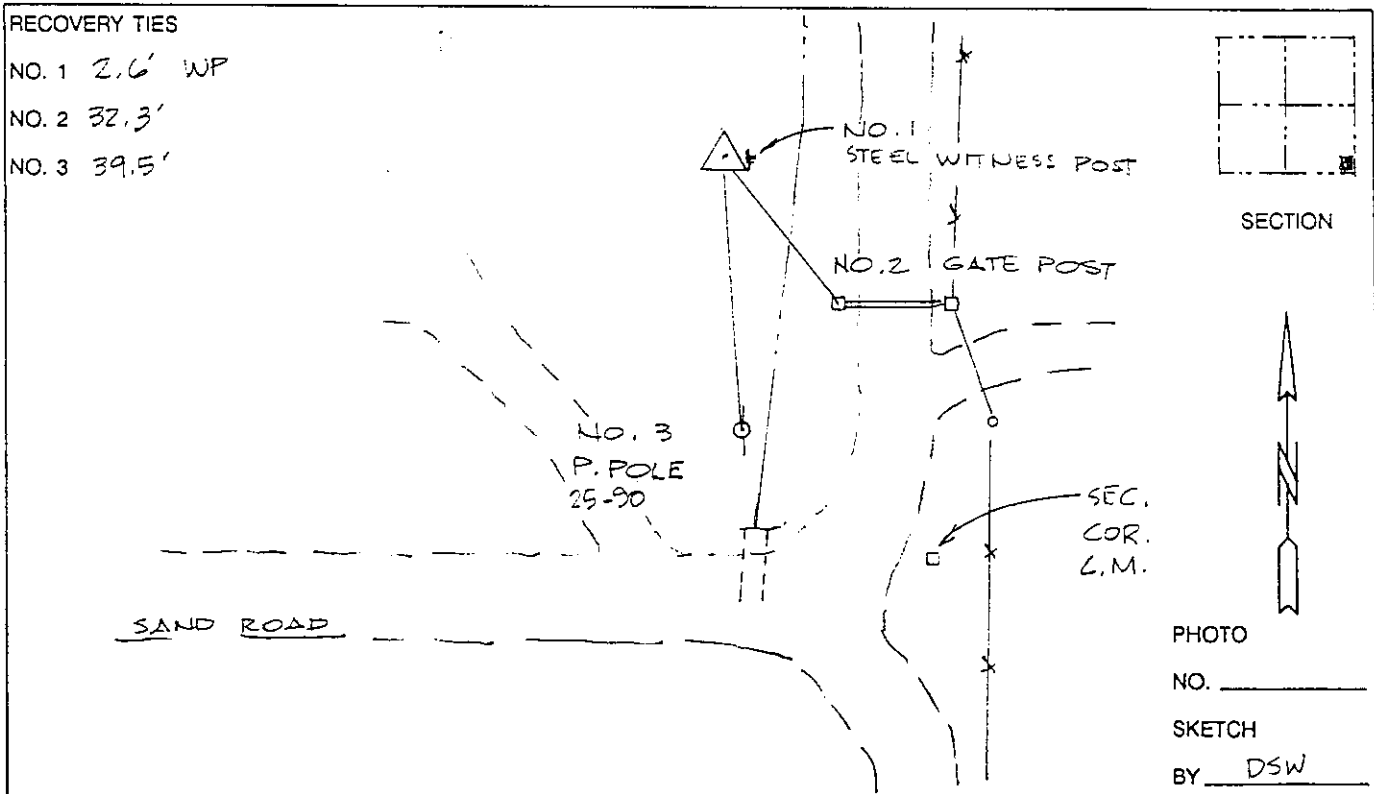

PHOTO NO. _____
 SKETCH BY DSW

VERTICAL CONTROL ORIGINATED ON 2nd ORDER CONTROL ESTABLISHED BY N. G. S. AND F. D. O. T.
 ON NATIONAL GEODETIC VERTICAL DATUM OF 1929.
 ELEVATION (FT) _____, 3rd ORDER LEVEL BOOK _____ PAGE 36