

LEE COUNTY SURVEY MARK DESCRIPTION



SURVEY CONTROL BY:
DENI ASSOCIATES, INC.
FORT MYERS, FLORIDA

MAPPING BY:
WOOLPERT CONSULTANTS

DESIGNATION GPS LUTZ (GPS 9011) COUNTY LEE STATE FL
 LOCATED IN SEC 31 TWP 45 S RGE 24 E USGS QUAD MAP FORT MYERS SW
 TO REACH SURVEY MARK FROM MCGREGOR BLVD & GLADIOLUS RD; GO
SOUTHWESTERLY ALONG MCGREGOR BLVD 0.5 MILES TO
THE INTERSECTION OF MCGREGOR BLVD & KAPOK CT. & MARK.

TYPE OF 3" Alum LEE Co Disc w Conc; "LEE COUNTY
 MARK DENI ASSOCIATES 1990" DATE SET 1990

HORIZONTAL CONTROL ORIGINATED ON 1st ORDER HORIZONTAL CONTROL ORIGINATED ON _____ ORDER
 CONTROL BASED ON FLORIDA HIGH PRECISION GPS NETWORK, CONTROL BY _____
 ON NORTH AMERICAN DATUM OF 1983, 1990 ADJUSTMENT ON _____ DATUM
 COORDINATES (FT), 1st ORDER COORDINATES (FT), _____ ORDER
 NORTHING (Y) 792,549.676 NORTHING (Y) _____
 EASTING (X) 672,712.539 EASTING (X) _____

GRID FLORIDA TRANSVERSE MERCATOR RECOVERED BY _____
 ZONE WEST SCALE FACTOR .999941 DATE, CONDITION _____
 FIELD BOOK _____ PAGE _____

- RECOVERY TIES
 NO. 1 3.3' WP
 NO. 2 24.5' E
 NO. 3 3.3' BC

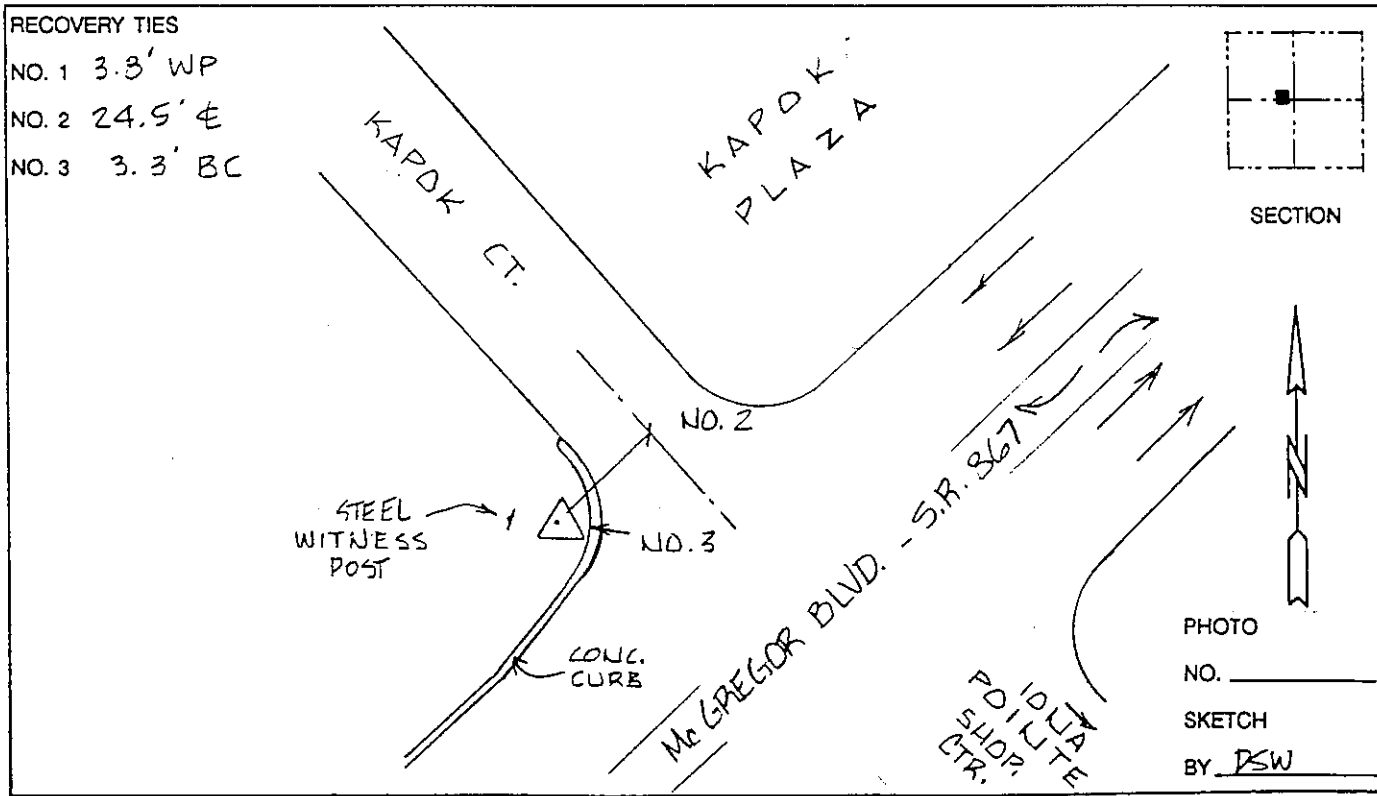

VERTICAL CONTROL ORIGINATED ON 2nd ORDER CONTROL ESTABLISHED BY N. G. S. AND F. D. O. T.
 ON NATIONAL GEODETIC VERTICAL DATUM OF 1929.
 ELEVATION (FT) _____, 3rd ORDER LEVEL BOOK _____ PAGE _____

PHOTO NO. _____
 SKETCH BY DSW