

LEE COUNTY SURVEY MARK DESCRIPTION



SURVEY CONTROL BY:
DENI ASSOCIATES, INC.
FORT MYERS, FLORIDA

MAPPING BY:
WOOLPERT CONSULTANTS

DESIGNATION GPS BEAN AZIMUTH^{GPS} (9005) COUNTY LEE STATE FL
 LOCATED IN SEC 25 TWP 45 S. RGE 24 E. USGS QUAD MAP FORT MYERS SE
 TO REACH SURVEY MARK FROM U.S. 41 AND SIX MILE PARKWAY; GO EASTERLY ALONG SIX MILE PARKWAY FOR 0.3 MILES TO THE MARK AT THE CROSSOVER.

TYPE OF 3" DIAMETER ALUMINUM DISC IN CONCRETE, 0.1 FT. BELOW GROUND
 MARK "LEE COUNTY DENI ASSOCIATES 1990" DATE SET 1990

HORIZONTAL CONTROL ORIGINATED ON 1st ORDER HORIZONTAL CONTROL ORIGINATED ON _____ ORDER
 CONTROL BASED ON FLORIDA HIGH PRECISION GPS NETWORK, CONTROL BY _____
 ON NORTH AMERICAN DATUM OF 1983, 1990 ADJUSTMENT ON _____ DATUM
 COORDINATES (FT), 1st ORDER COORDINATES (FT), _____ ORDER
 NORTHING (Y) 797,627,552 NORTHING (Y) _____
 EASTING (X) 700,080,009 EASTING (X) _____

GRID FLORIDA TRANSVERSE MERCATOR RECOVERED BY _____
 ZONE WEST SCALE FACTOR ,999943 DATE, CONDITION _____
 FIELD BOOK _____ PAGE _____

RECOVERY TIES

- NO. 1 17.0 FT TO END GRASS MEDIAN
- NO. 2 10.7 FT. TO S. EDGE GRASS MEDIAN
- NO. 3 58.8 FT TO ϕ DRIVE

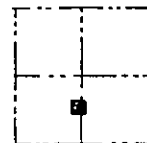
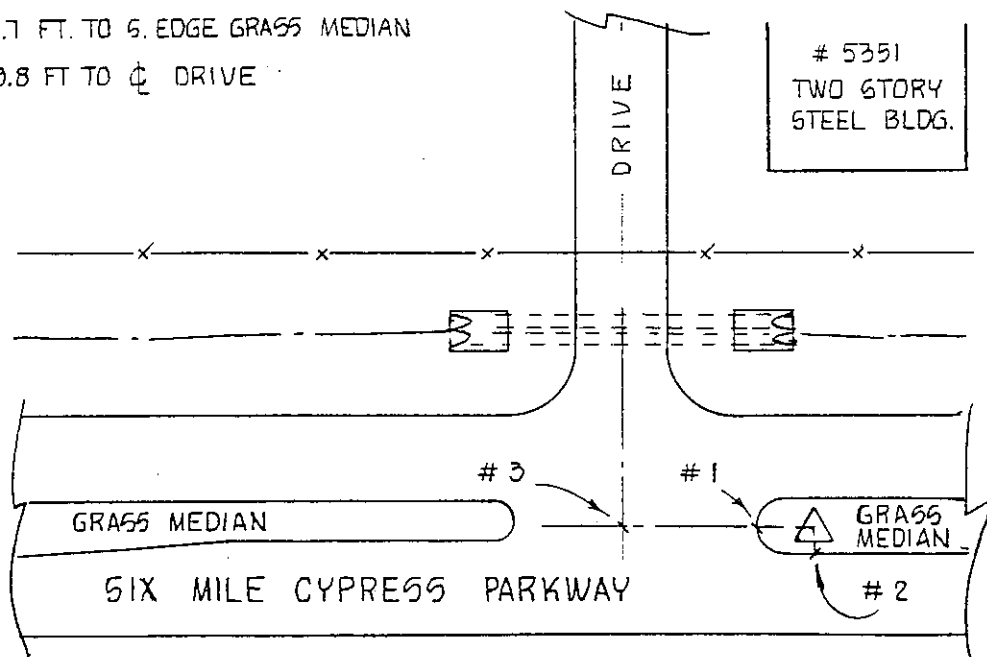

SECTION

PHOTO NO. _____
 SKETCH BY _____

VERTICAL CONTROL ORIGINATED ON 2nd ORDER CONTROL ESTABLISHED BY N. G. S. AND F. D. O. T.
 ON NATIONAL GEODETIC VERTICAL DATUM OF 1929.
 ELEVATION (FT) _____, 3rd ORDER LEVEL BOOK _____ PAGE _____