

LEE COUNTY SURVEY MARK DESCRIPTION



SURVEY CONTROL BY:
DENI ASSOCIATES, INC.
FORT MYERS, FLORIDA

MAPPING BY:
WOOLPERT CONSULTANTS

DESIGNATION GPS SUNSHINE (GPS 9037) COUNTY LEE STATE FL

LOCATED IN SEC 13 TWP 44 S. RGE 26 E USGS QUAD MAP OLGA

TO REACH SURVEY MARK FROM THE INTERSECTION OF SUNSHINE BLVD & LEE BLVD;
GO NORTHERLY ON SUNSHINE BLVD 3.8 MILES TO 46 ST W;
THENCE CONT. NORTH 0.1 MILE TO MARK.

TYPE OF 3 1/4" LEE CO - DENI ASSOCIATES DISC SET IN CONC.
MARK _____ DATE SET MAR 1990

HORIZONTAL CONTROL ORIGINATED ON 1st ORDER HORIZONTAL CONTROL ORIGINATED ON _____ ORDER

CONTROL BASED ON FLORIDA HIGH PRECISION GPS NETWORK, CONTROL BY _____

ON NORTH AMERICAN DATUM OF 1983, 1990 ADJUSTMENT ON _____ DATUM

COORDINATES (FT), 1st ORDER COORDINATES (FT), _____ ORDER

NORTHING (Y) 844,792.540 NORTHING (Y) _____

EASTING (X) 766,034.149 EASTING (X) _____

GRID FLORIDA TRANSVERSE MERCATOR RECOVERED BY _____

ZONE WEST SCALE FACTOR .999955 DATE, CONDITION _____

FIELD BOOK _____ PAGE _____

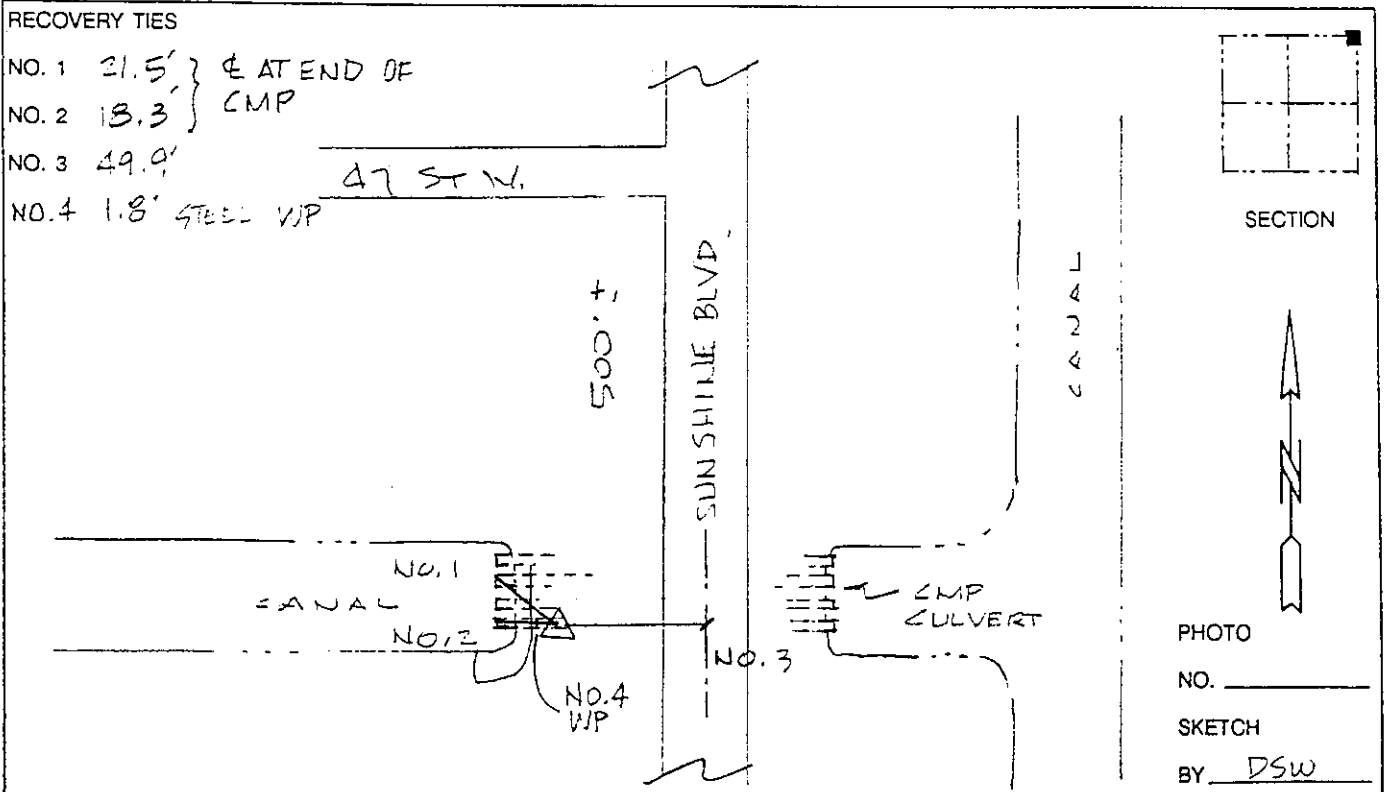

VERTICAL CONTROL ORIGINATED ON 2nd ORDER CONTROL ESTABLISHED BY _____ N. G. S. AND F. D. O. T.

ON NATIONAL GEODETIC VERTICAL DATUM OF 1929.

ELEVATION (FT) _____, 3rd ORDER LEVEL BOOK _____ PAGE _____