

LEE COUNTY SURVEY MARK DESCRIPTION



SURVEY CONTROL BY:
DENI ASSOCIATES, INC.
FORT MYERS, FLORIDA

MAPPING BY:
WOOLPERT CONSULTANTS

DESIGNATION (JEI) 44-23-17-01 (GPS 9061) COUNTY LEE STATE FL
 LOCATED IN SEC 17 TWP 44S RGE 23E USGS QUAD MAP MATLACHA
 TO REACH SURVEY MARK FROM _____

AT THE INTERSECTION OF PINE ISLAND ROAD AND BURNT
 STORE MARINA ROAD IN WESTERN CAPE CORAL,

TYPE OF 4" x 4" CONCRETE MONUMENT WITH BRASS DISK "LEE COUNTY GPS
 MARK LB 642", SET BY J.E.I. DATE SET 1990

HORIZONTAL CONTROL ORIGINATED ON <u>1st</u> ORDER CONTROL BASED ON FLORIDA HIGH PRECISION GPS NETWORK, ON NORTH AMERICAN DATUM OF 1983, 1990 ADJUSTMENT COORDINATES (FT), <u>1st</u> ORDER NORTHING (Y) <u>837,582.099</u> EASTING (X) <u>643,202.643</u>	HORIZONTAL CONTROL ORIGINATED ON _____ ORDER CONTROL BY _____ ON _____ DATUM COORDINATES (FT), _____ ORDER NORTHING (Y) _____ EASTING (X) _____
--	--

GRID FLORIDA TRANSVERSE MERCATOR RECOVERED BY DENI ASSOCIATES
 ZONE WEST SCALE FACTOR .999941 DATE, CONDITION 2-91
 FIELD BOOK _____ PAGE _____ GOOD

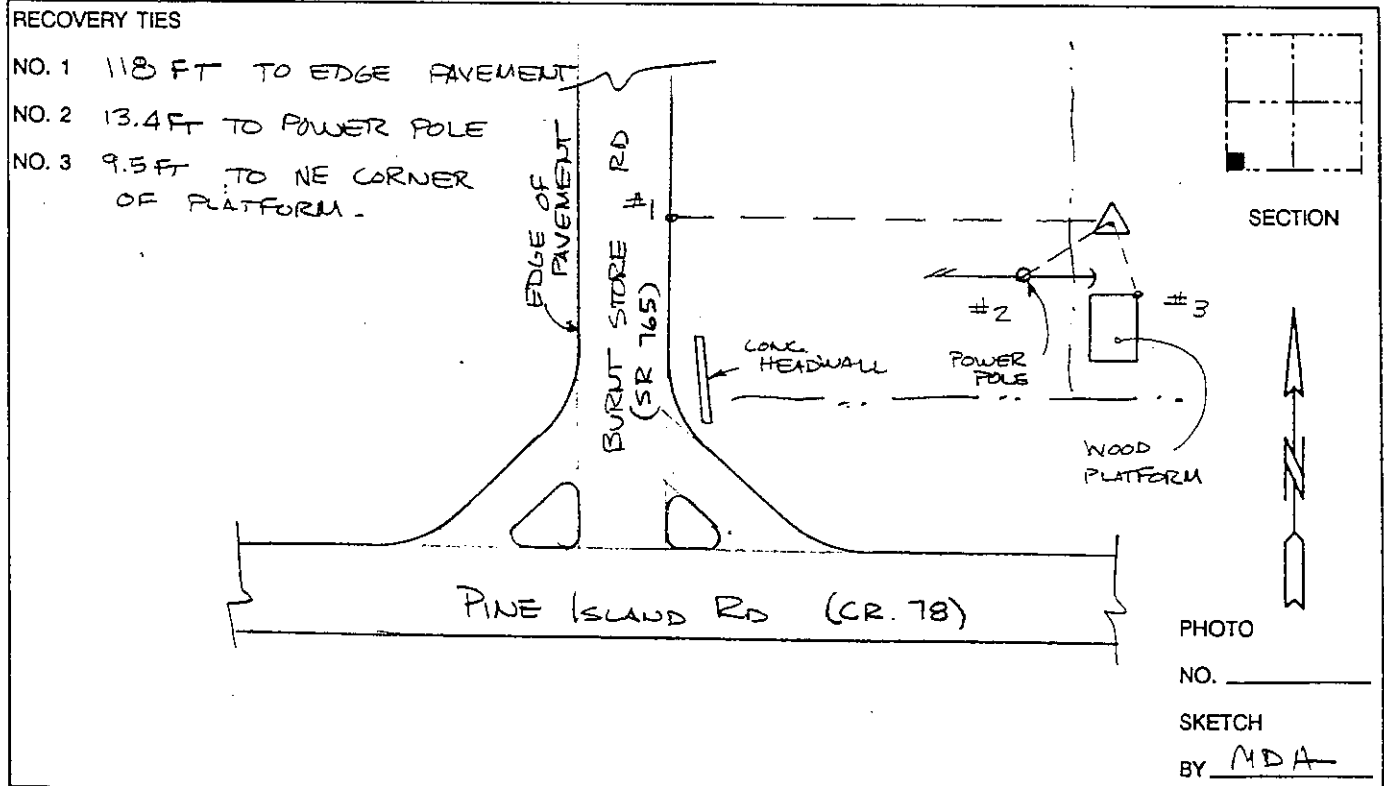

VERTICAL CONTROL ORIGINATED ON 2nd ORDER CONTROL ESTABLISHED BY _____ N. G. S. AND F. D. O. T.
 ON NATIONAL GEODETIC VERTICAL DATUM OF 1929.
 ELEVATION (FT) _____ 3rd ORDER LEVEL BOOK _____ PAGE _____