

# LEE COUNTY SURVEY MARK DESCRIPTION



SURVEY CONTROL BY:  
DENI ASSOCIATES, INC.  
FORT MYERS, FLORIDA

MAPPING BY:  
WOOLPERT CONSULTANTS

DESIGNATION F.D.O.T. 12 88 A30 <sup>GPS</sup> (9032) COUNTY LEE STATE FL

LOCATED IN SEC 31 TWP 43S RGE 23E USGS QUAD MAP MATLACHA

TO REACH SURVEY MARK FROM INTERSECTION OF PINE ISLAND ROAD (CR 78)  
& BURNT STORE ROAD (CR 765) ; GO NORTH ON BURNT STORE  
ROAD (CR 765) 3.2 MI ± ; 0.15 MI. N. OF GULFSTREAM PKWY.

TYPE OF 4x4" CONCRETE MONUMENT WITH BRASS DISK & "FLA DOT."  
MARK EXISTING DATE SET <sup>GPS</sup> 1990

HORIZONTAL CONTROL ORIGINATED ON 1st ORDER HORIZONTAL CONTROL ORIGINATED ON \_\_\_\_\_ ORDER  
CONTROL BASED ON FLORIDA HIGH PRECISION GPS NETWORK, CONTROL BY \_\_\_\_\_  
ON NORTH AMERICAN DATUM OF 1983, 1990 ADJUSTMENT ON \_\_\_\_\_ DATUM  
COORDINATES (FT), 1st ORDER COORDINATES (FT), \_\_\_\_\_ ORDER  
NORTHING (Y) 854,422.483 NORTHING (Y) \_\_\_\_\_  
EASTING (X) 643,300.507 EASTING (X) \_\_\_\_\_

GRID FLORIDA TRANSVERSE MERCATOR MARK RECOVERED BY DENI ASSOC., INC.  
ZONE WEST SCALE FACTOR .999941 DATE, CONDITION MAR. 1990 ; GOOD

FIELD BOOK \_\_\_\_\_ PAGE \_\_\_\_\_

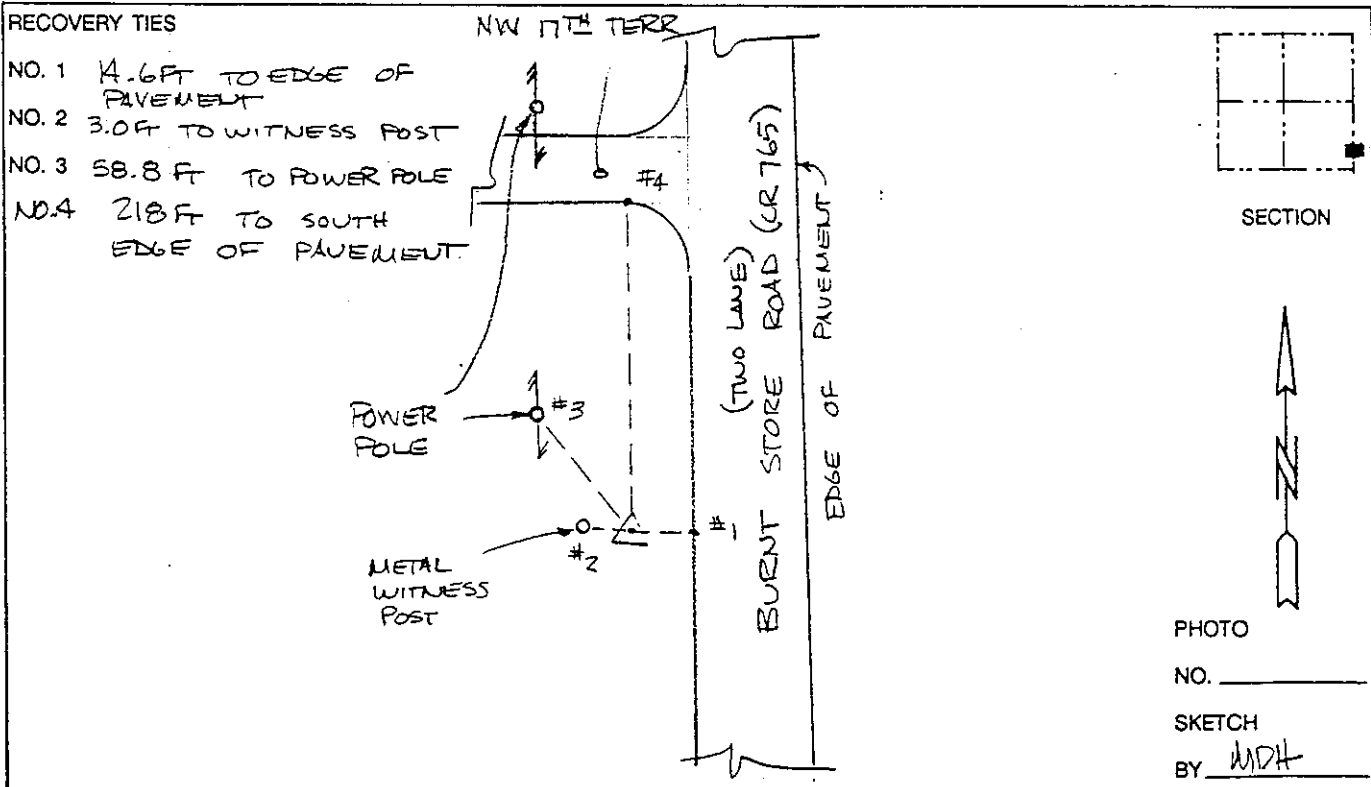

VERTICAL CONTROL ORIGINATED ON 2nd ORDER CONTROL ESTABLISHED BY \_\_\_\_\_ N. G. S. AND F. D. O. T.

ON NATIONAL GEODETIC VERTICAL DATUM OF 1929.

ELEVATION (FT) \_\_\_\_\_, 3rd ORDER LEVEL BOOK \_\_\_\_\_ PAGE \_\_\_\_\_