

LEE COUNTY SURVEY MARK DESCRIPTION

DESIGNATION 44 26-02-01 COUNTY LEE STATE FL.

LOCATED IN SEC 02 TWP 44 S. RGE 26 E. USGS QUAD MAP 01gd

TO REACH SURVEY MARK:

From the intersection of S.R. 884 (Lee Boulevard) and Sunshine Boulevard, travel northerly along Sunshine Boulevard for 5.4 miles to West 75th Street S.E. and the end of Sunshine Boulevard; thence travel westerly along 75th Street S.E. for 2 miles to a cul-de-sac; thence travel northerly along a dirt track to the intersection of two canals. The point is 10 feet south of a witness sign.

TYPE OF 4"x4" Concrete Monument With Brass Disk

MARK GPS 44-26-02-01 DATE SET March 9, 1990

HORIZONTAL CONTROL ORIGINATED ON 2nd/1st ORDER CONTROL BY U.S.C. & GS / NGS

ON 1927 DATUM. ON 1983 (1990 GPS Adjustment) DATUM.

COORDINATES (FT), 2nd ORDER COORDINATES (FT), 2nd ORDER

NORTHING (Y) 854883.341 NORTHING (Y) 855053.379

EASTING (X) 599 366.214 EASTING (X) 755597.381

GRID FLORIDA TRANSVERSE MERCATOR RECOVERED BY _____

ZONE WEST DATE, CONDITION _____

FIELD BOOK 1738 PAGE 13

RECOVERY TIES

- NO. 1 Set 3/4" Pipe w/Ref. Cap
- NO. 2 Set 3/4" Pipe w/Ref. Cap
- NO. 3 Set 3/4" Pipe w/Ref. Cap
- NO. 4 Set 3/4" Pipe w/Ref. Cap
- NO. 5 Set 4"x4" Conc. Mon. (PRM)

Note: Witness Sign 10'
North of Monument

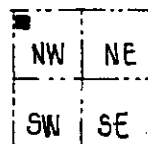

SECTION 02

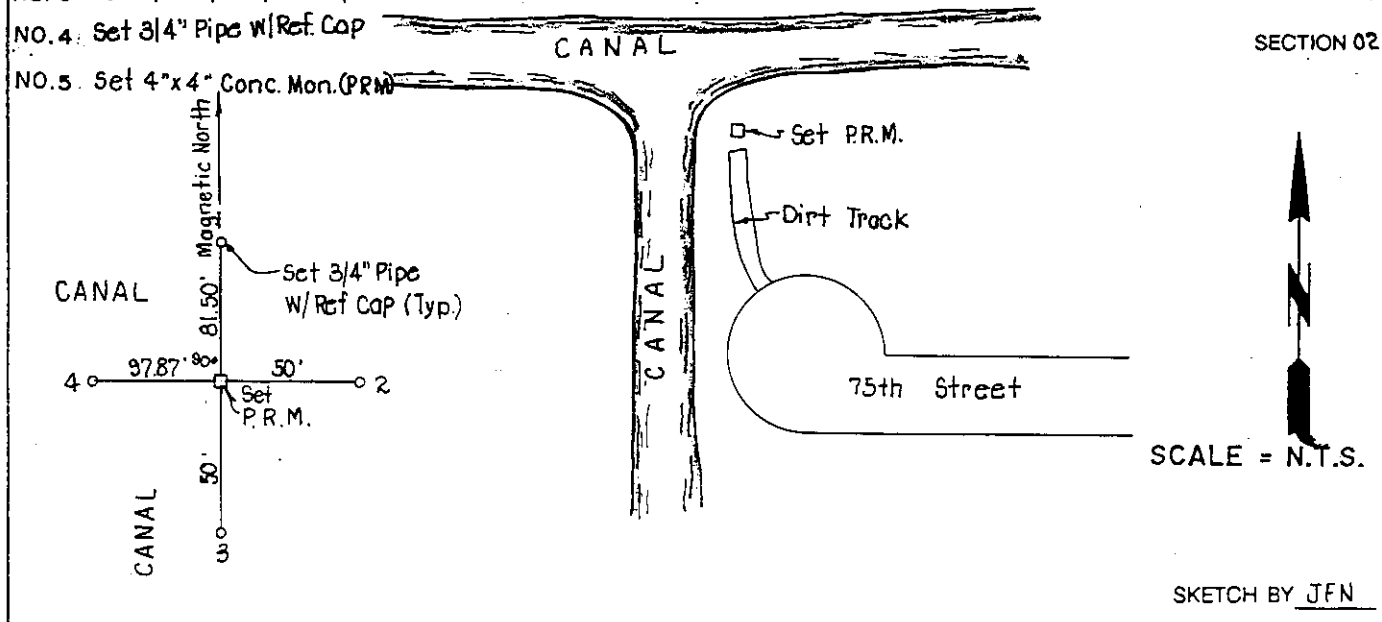

JOHNSON ENGINEERING, INC.

CIVIL ENGINEERS - LAND SURVEYORS
2158 JOHNSON STREET, POST OFFICE BOX 1550, FORT MYERS, FLORIDA, 33902-1550
PHONE (813) 334-0046