

LEE COUNTY SURVEY MARK DESCRIPTION

DESIGNATION 43-24-11-01 COUNTY LEE STATE FL.

LOCATED IN SEC 11 TWP 43S. RGE 24E. USGS QUAD MAP Fort Myers, NW

TO REACH SURVEY MARK:

From the intersection of U.S. 41 and Business 41; thence north along U.S. 41 2.50 miles to a dirt track on the right. Dirt track is opposite and southeasterly of the entrance to Pine Lakes Country Club; thence easterly along dirt track 1.80 miles to a power line right-of-way that is abandoned; thence northerly along said power line right-of-way 0.20 miles to the mark. Station is 10' north of the witness post.

TYPE OF 4"x4" Concrete Monument With Brass Disk

MARK GPS43-24-11-01 DATE SET March, 21 1990

HORIZONTAL CONTROL ORIGINATED ON 2nd/1st ORDER CONTROL BY USC & GS / NGS

ON 1927 DATUM. ON 1983 (1990 GPS Adjustment) DATUM.

COORDINATES (FT), 2nd ORDER COORDINATES (FT), 2nd ORDER

NORTHING (Y) 879842.650 NORTHING (Y) 880012.771

EASTING (X) 535743.078 EASTING (X) 691973.911

GRID FLORIDA TRANSVERSE MERCATOR RECOVERED BY _____

ZONE WEST DATE, CONDITION _____

FIELD BOOK 1738 PAGE 39

RECOVERY TIES

- NO. 1 Set 3/4" Pipe w/ Ref. Cap
- NO. 2 Set 3/4" Pipe w/ Ref. Cap
- NO. 3 Set 3/4" Pipe w/ Ref. Cap
- NO. 4 Set 3/4" Pipe w/ Ref. Cap
- NO. 5 Set 4"x4" Conc Mon. (P.R.M.)

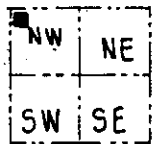
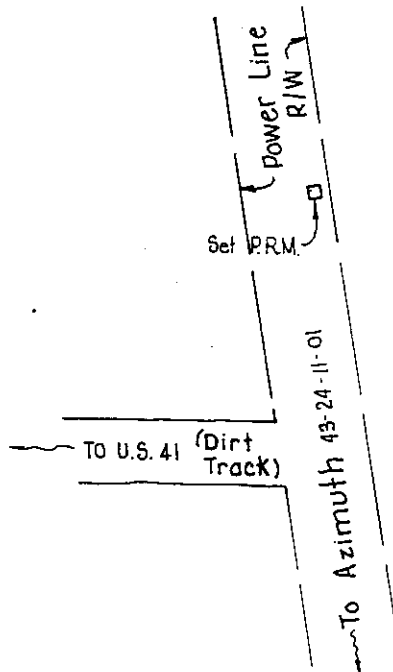
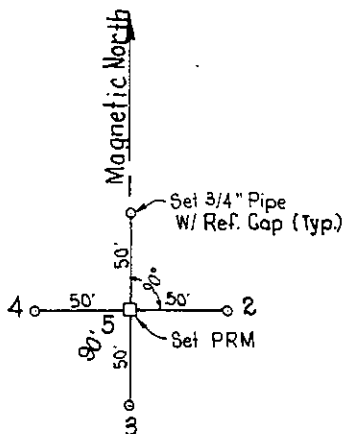

SECTION 11

Note: Witness Sign 10' South of Monument

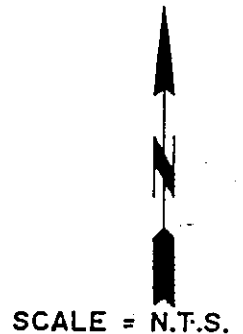

SKETCH BY JFN

JOHNSON ENGINEERING, INC.

CIVIL ENGINEERS - LAND SURVEYORS
2158 JOHNSON STREET, POST OFFICE BOX 1550, FORT MYERS, FLORIDA, 33902-1550
PHONE (813) 334-0046