

**LEE COUNTY PUBLIC WORKS
GPS SURVEY MARK DESCRIPTION**

GPS CONTROL BY:
DENI ASSOCIATES, INC.
FORT MYERS, FLORIDA

NORTH & EAST FORT MYERS
WATER QUALITY
LEE COUNTY, FLORIDA

DESIGNATION GPS MARHENKE GPS No. A137 COUNTY LEE STATE FLORIDA

LOCATED IN SECTION 9 TWP 43 RGE 24 USGS QUAD MAP FORT MYERS NW

TO REACH FROM THE INTERSECTION OF U.S. 41 & OLD U.S. 41 IN NORTH FORT MYERS; GO N'LY ON U.S. 41

2.2+/- MILES TO "RAINTREE RV RESORT" E'LY AND BOX CULVERT STRUCTURE (#120099) UNDER U.S 41

AT GATOR SLOUGH CANAL AND MARK. MARK IS LOCATED ON THE WEST SIDE OF U.S. 41 AND EAST SIDE OF

W'LY CONCRETE HEADWALL FOR SAID BOX CULVERT STRUCTURE; 49.8' W'LY OF THE CENTERLINE OF THE

SOUTHBOUND LANES OF U.S. 41; 2.6' E'LY OF A CHISELED "+" IN THE CENTER OF CONCRETE HEADWALL;

13.0' N'LY OF THE SOUTH END OF SAID CONCRETE HEADWALL.

MARK 3-1/4" LEE COUNTY / DENI ASSOCIATES ALUMINUM SURVEY MARK DISK IN CONCRETE

MARK EXISTING VALUES AS PUBLISHED BY N.G.S. FOR HORIZONTAL

MARK SET VALUES ESTABLISHED BY DENI ASSOC., INC. FOR VERTICAL DATE 2000

HORIZONTAL VALUES ORIGINATED ON ORDER "B" FLORIDA HIGH ACCURACY REFERENCE NETWORK (HARN) CONTROL ESTABLISHED BY THE NATIONAL GEODETIC SURVEY AND BASED ON THE NORTH AMERICAN DATUM OF 1983, 1990 ADJUSTMENT.

FLORIDA COORDINATE SYSTEM: TRANSVERSE MERCATOR, WEST ZONE SCALE FACTOR: 0.99994202

COORDINATES: US FEET METERS

NORTHING (Y) 876042.109 267018.169 LATITUDE N 26° 44' 37.58612"

EASTING (X) 683214.054 208244.060 LONGITUDE W 81° 55' 01.64156"

VERTICAL VALUES ORIGINATED ON VERTICAL CONTROL ESTABLISHED BY THE NATIONAL GEODETIC SURVEY AND BASED ON THE NATIONAL GEODETIC VERTICAL DATUM OF 1929 (NGVD29) THE NORTH AMERICAN VERTICAL DATUM OF 1988 (NAVD88)

ELEVATION (US FEET) 21.30 ELEVATION (US FEET) 20.14

ELEVATION (METERS) 6.493 ELEVATION (METERS) 6.139

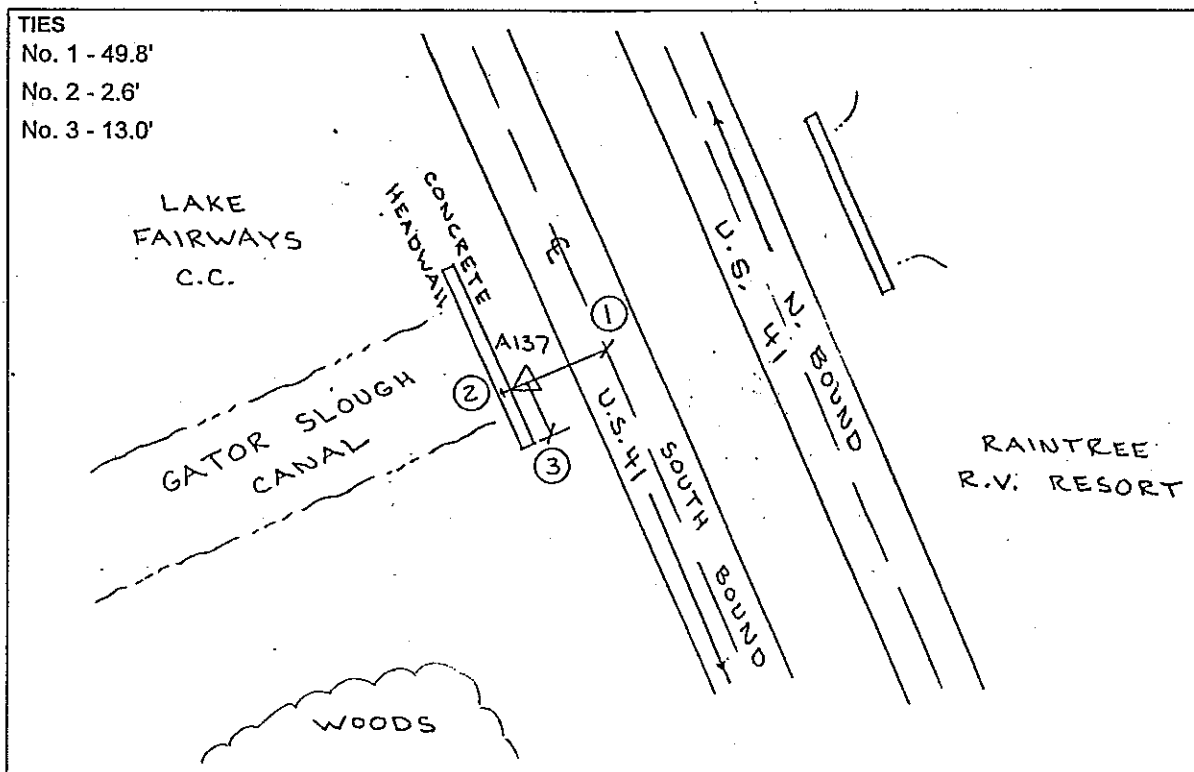

450