

**LEE COUNTY PUBLIC WORKS
GPS SURVEY MARK DESCRIPTION**

GPS CONTROL BY:
DENI ASSOCIATES, INC.
FORT MYERS, FLORIDA

ESTERO BAY WATER QUALITY
LEE COUNTY, FLORIDA

DESIGNATION A029 GPS No. A029 COUNTY LEE STATE FLORIDA

LOCATED IN SECTION 10 TWP 45 RGE 24 USGS QUAD MAP FT. MYERS S.W.

TO REACH FROM THE INTERSECTION OF MCGREGOR BLVD. & WHISKEY CREEK DR.; GO E'LY & S'LY ON
 WHISKEY CREEK DR. 0.45 +/- MILE TO BRIDGE (#124014) OVER CANAL AND MARK. MARK IS LOCATED IN
 THE S.W. CORNER OF CONCRETE PAD/SHOULDER/WALK ON EAST SIDE OF BRIDGE; NEAR ENTRANCE TO
 ASPHALT PARKING LOT FOR WHISKEY CREEK COUNTRY CLUB.

MARK 3-1/4" LEE COUNTY PUBLIC WORKS ALUMINUM DISK

MARK EXISTING VALUES AS PUBLISHED BY _____
 MARK SET VALUES ESTABLISHED BY DENI ASSOCIATES, INC. DATE 2000

HORIZONTAL VALUES ORIGINATED ON ORDER "B" FLORIDA HIGH ACCURACY REFERENCE NETWORK (HARN) CONTROL ESTABLISHED BY THE NATIONAL GEODETIC SURVEY AND BASED ON THE NORTH AMERICAN DATUM OF 1983, 1990 ADJUSTMENT.

FLORIDA COORDINATE SYSTEM: TRANSVERSE MERCATOR, WEST ZONE SCALE FACTOR: 0.99994260

COORDINATES:	US FEET	METERS		
NORTHING (Y)	<u> 814659.761 </u>	<u> 248308.792 </u>	LATITUDE	<u> N 26° 34' 29.59529" </u>
EASTING (X)	<u> 691345.965 </u>	<u> 210722.672 </u>	LONGITUDE	<u> W 81° 53' 32.50969" </u>

VERTICAL VALUES ORIGINATED ON VERTICAL CONTROL ESTABLISHED BY THE NATIONAL GEODETIC SURVEY AND BASED ON THE NATIONAL GEODETIC VERTICAL DATUM OF 1929 (NGVD29) THE NORTH AMERICAN VERTICAL DATUM OF 1988 (NAVD88)

ELEVATION (US FEET)	<u> 10.69 </u>	ELEVATION (US FEET)	<u> 9.51 </u>
ELEVATION (METERS)	<u> 3.258 </u>	ELEVATION (METERS)	<u> 2.899 </u>

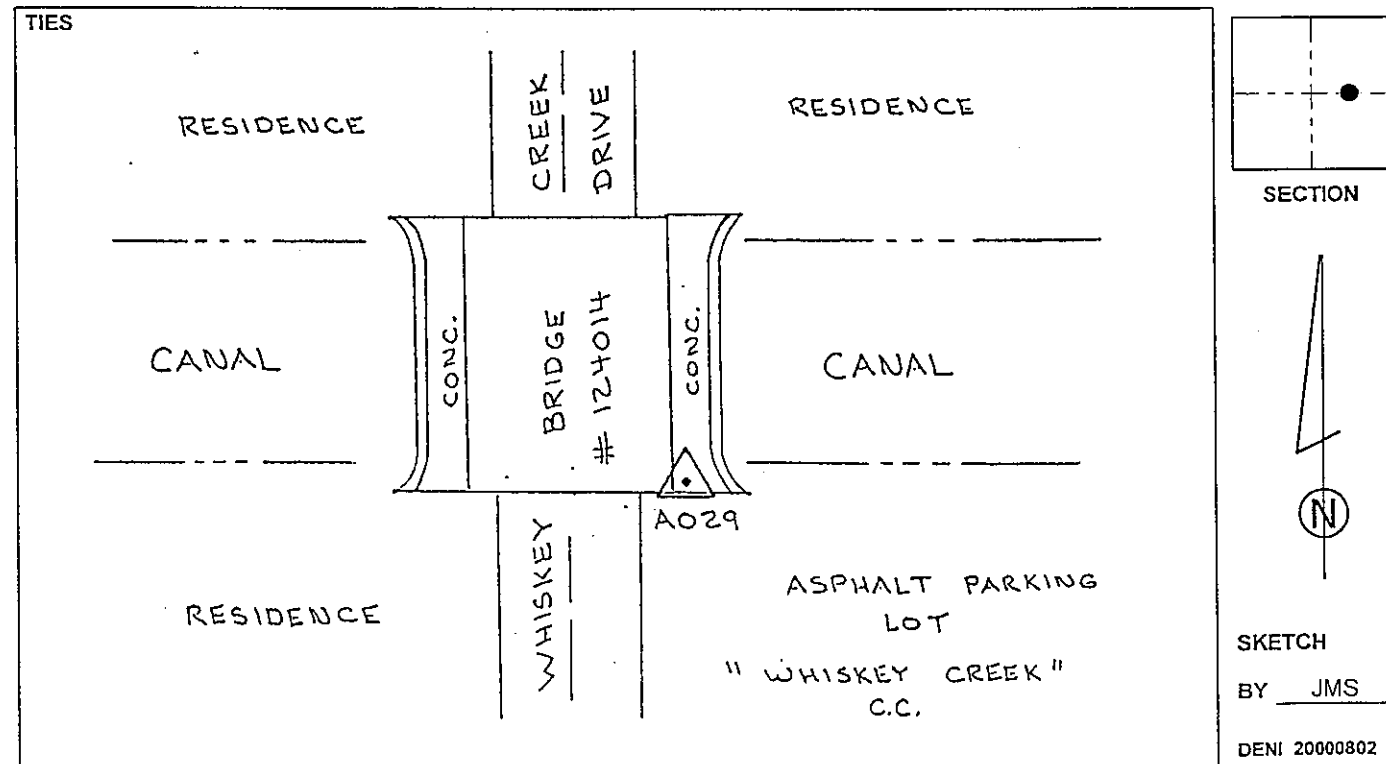

SKETCH
BY JMS
DENI 20000802

409