

LEE COUNTY PUBLIC WORKS
GPS SURVEY MARK DESCRIPTION

GPS CONTROL BY:
DENI ASSOCIATES, INC.
FORT MYERS, FLORIDA

ESTERO BAY WATER QUALITY
LEE COUNTY, FLORIDA

DESIGNATION A004 GPS No. A004 COUNTY LEE STATE FLORIDA
 LOCATED IN SECTION 31 TWP 47 RGE 26 USGS QUAD MAP BONITA SPRINGS
 TO REACH FROM THE INTERSECTION OF I-75 & BONITA BEACH ROAD (EXIT 18); GO N'LY 0.4 +/- MILE, CROSSING
THE IMPERIAL RIVER, TO MARK IN THE NORTH END OF A CONCRETE HEADWALL (STRUCTURE #120148)
ON THE EAST SIDE OF I-75; APPROXIMATELY 100' +/- SOUTH OF MOTORIST AID CALL BOX (MILE 116.6).

MARK 3-1/4" LEE COUNTY PUBLIC WORKS ALUMINUM DISK

MARK EXISTING VALUES AS PUBLISHED BY _____
 MARK SET VALUES ESTABLISHED BY DENI ASSOCIATES, INC. DATE 2000

HORIZONTAL VALUES ORIGINATED ON ORDER "B" FLORIDA HIGH ACCURACY REFERENCE NETWORK (HARN) CONTROL ESTABLISHED BY THE NATIONAL GEODETIC SURVEY AND BASED ON THE NORTH AMERICAN DATUM OF 1983, 1990 ADJUSTMENT.

FLORIDA COORDINATE SYSTEM: TRANSVERSE MERCATOR, WEST ZONE SCALE FACTOR: 0.99994879

COORDINATES:	US FEET	METERS		
NORTHING (Y)	<u>728658.798</u>	<u>222095.646</u>	LATITUDE	<u>N 26° 20' 17.18559"</u>
EASTING (X)	<u>737636.508</u>	<u>224832.057</u>	LONGITUDE	<u>W 81° 45' 04.46712"</u>

VERTICAL VALUES ORIGINATED ON VERTICAL CONTROL ESTABLISHED BY THE NATIONAL GEODETIC SURVEY AND BASED ON THE NATIONAL GEODETIC VERTICAL DATUM OF 1929 (NGVD29) THE NORTH AMERICAN VERTICAL DATUM OF 1988 (NAVD88)

ELEVATION (US FEET)	<u>15.11</u>	ELEVATION (US FEET)	<u>13.90</u>
ELEVATION (METERS)	<u>4.605</u>	ELEVATION (METERS)	<u>4.237</u>

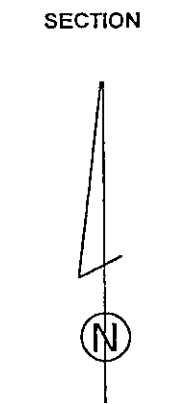
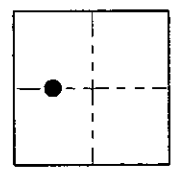
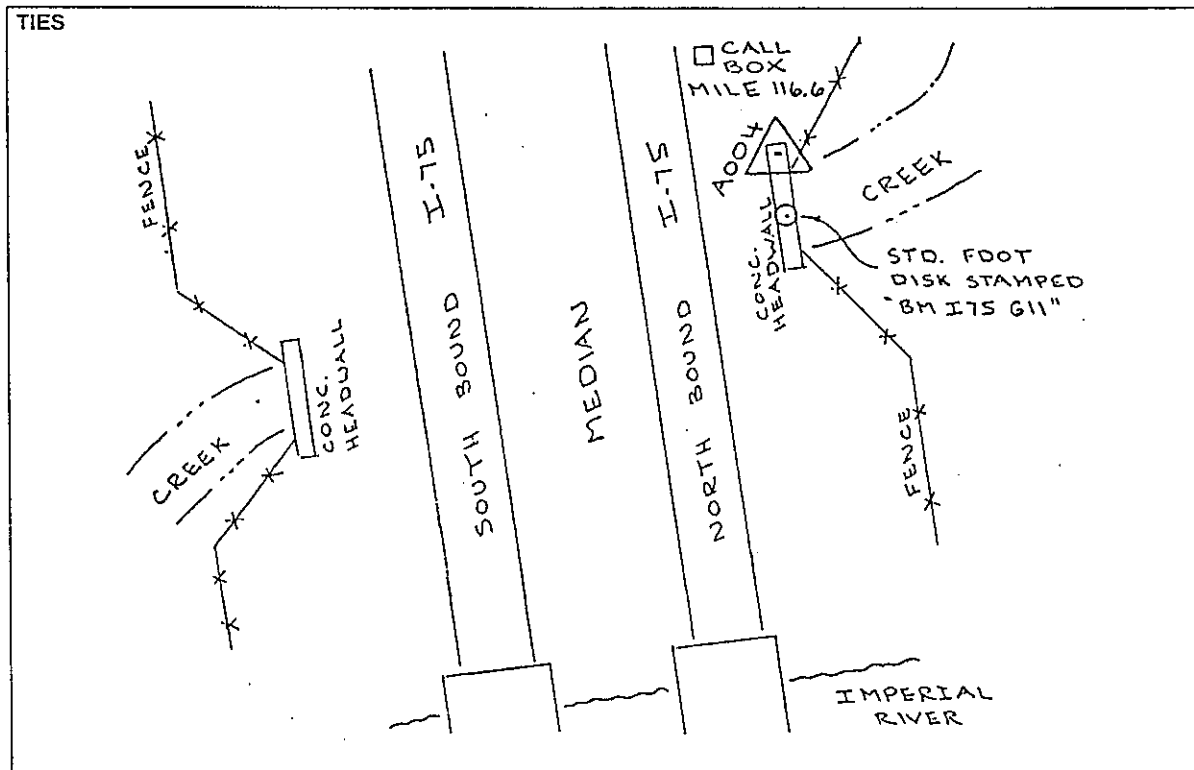

SKETCH
BY JMS
DENI 20000802