

LEE COUNTY PUBLIC WORKS  
GPS SURVEY MARK DESCRIPTION

GPS CONTROL BY:  
DENI ASSOCIATES, INC.  
FORT MYERS, FLORIDA

ESTERO BAY WATER QUALITY  
LEE COUNTY, FLORIDA

DESIGNATION A002 GPS No. A002 COUNTY LEE STATE FLORIDA  
 LOCATED IN SECTION 35 TWP 47 RGE 25 USGS QUAD MAP BONITA SPRINGS  
 TO REACH FROM THE INTERSECTION OF OLD U.S. 41 & BONITA BEACH RD. ( S.R. 865 ); GO NORTH 0.6 +/- MILE  
TO INTERSECTION WITH PENNSYLVANIA AVE.; THEN GO W'LY 0.4 +/- MILE TO BRIDGE (#124076) OVER  
OAK CREEK AND MARK IN TOP OF CONCRETE WINGWALL AT THE S.E. CORNER OF BRIDGE.

MARK 3-1/4" LEE COUNTY PUBLIC WORKS ALUMINUM DISK

MARK EXISTING  VALUES AS PUBLISHED BY \_\_\_\_\_  
 MARK SET  VALUES ESTABLISHED BY DENI ASSOCIATES, INC. DATE 2000

HORIZONTAL VALUES ORIGINATED ON ORDER "B" FLORIDA HIGH ACCURACY REFERENCE NETWORK (HARN) CONTROL ESTABLISHED BY THE NATIONAL GEODETIC SURVEY AND BASED ON THE NORTH AMERICAN DATUM OF 1983, 1990 ADJUSTMENT.

FLORIDA COORDINATE SYSTEM: TRANSVERSE MERCATOR, WEST ZONE SCALE FACTOR: 0.99994680

| COORDINATES: | US FEET           | METERS            |           |                            |
|--------------|-------------------|-------------------|-----------|----------------------------|
| NORTHING (Y) | <u>728940.478</u> | <u>222181.502</u> | LATITUDE  | <u>N 26° 20' 20.17840"</u> |
| EASTING (X)  | <u>726195.742</u> | <u>221344.905</u> | LONGITUDE | <u>W 81° 47' 10.22044"</u> |

VERTICAL VALUES ORIGINATED ON VERTICAL CONTROL ESTABLISHED BY THE NATIONAL GEODETIC SURVEY AND BASED ON THE NATIONAL GEODETIC VERTICAL DATUM OF 1929 (NGVD29) THE NORTH AMERICAN VERTICAL DATUM OF 1988 (NAVD88)

|                     |              |                     |              |
|---------------------|--------------|---------------------|--------------|
| ELEVATION (US FEET) | <u>11.60</u> | ELEVATION (US FEET) | <u>10.39</u> |
| ELEVATION (METERS)  | <u>3.537</u> | ELEVATION (METERS)  | <u>3.167</u> |

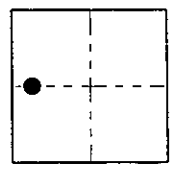
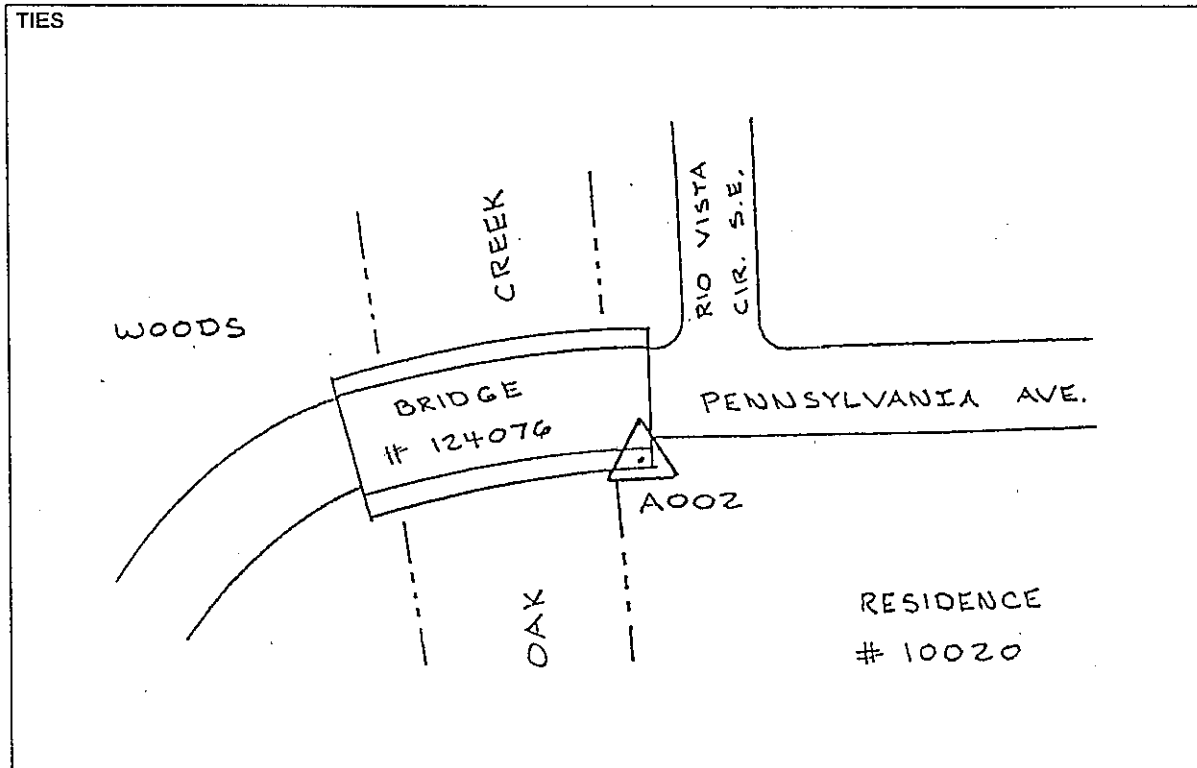

SECTION



SKETCH  
BY JMS

DENI 20000802

402