



Deni Associates
FORT MYERS, FLORIDA

LEE COUNTY, FLORIDA
AERIAL MAPPING PROJECT

MAPPING BY:
WOOLPERT CONSULTANTS

2-43-26

DESIGNATION TBM 19-33 COUNTY LEE STATE FL
LOCATED IN SEC 3/2 TWP 47 S RGE 26 E USGS QUAD MAP TELEGRAPH SWAMP
TO REACH SURVEY MARK FROM AS DESCRIBED BELOW
ON SECTION CORNER

TYPE OF TOP OF SECTION COR MON. 3/2
MARK 10/11 DATE SET SEPT. 19 88

HORIZONTAL CONTROL ORIGINATED ON 2ND ORDER CONTROL BY N.G.S. AND F.D.O.T.

ON NORTH AMERICAN DATUM OF 1927 (1927 ADJ) ON NORTH AMERICAN DATUM OF 1983

COORDINATES (FT) COORDINATES (FT)
NORTHING (Y) _____ NORTHING (Y) _____
EASTING (X) _____ EASTING (X) _____

3RD ORDER COORDINATES STATE AND ZONE FLORIDA, MERCATOR WEST

FIELD BOOK _____ PAGE _____ SKETCH BY WGH

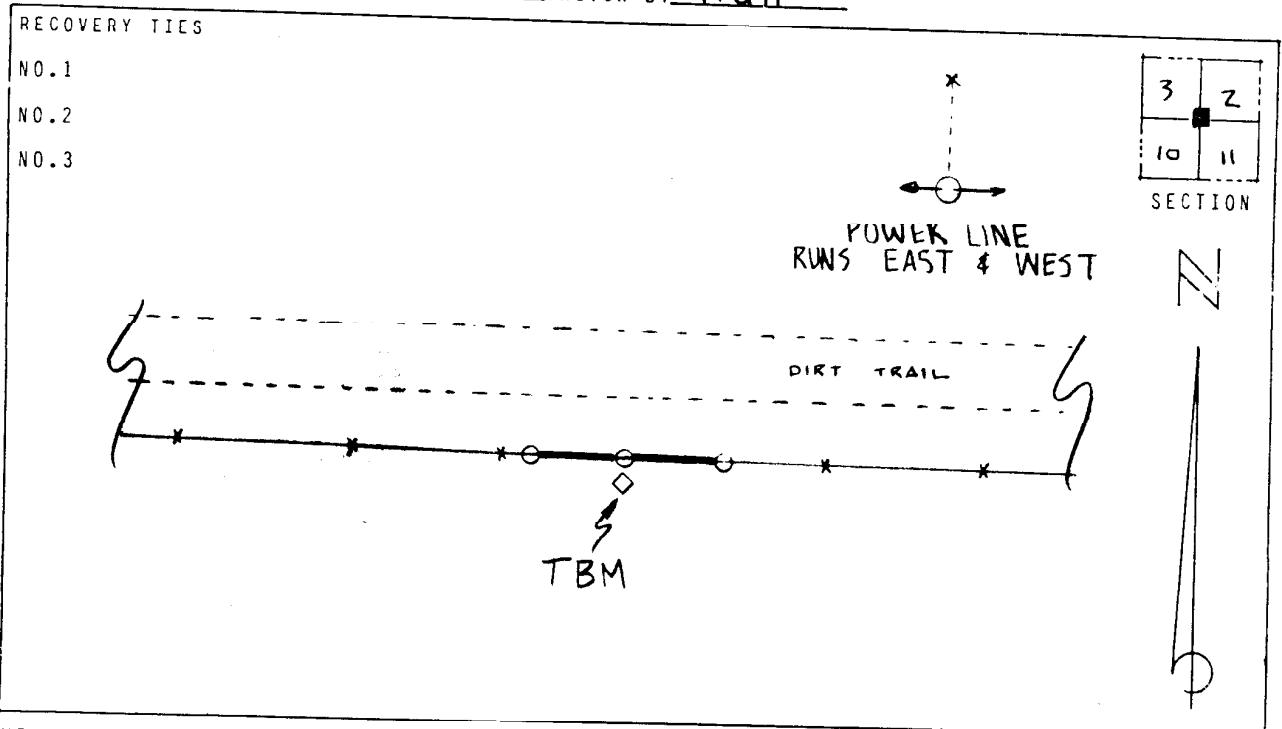

VERTICAL CONTROL ORIGINATED ON 2ND ORDER CONTROL ESTABLISHED BY N.G.S. AND F.D.O.T.

ON NATIONAL GEODETIC VERTICAL DATUM OF 1929

ELEVATION (FT) 21.63, 3RD ORDER LEVEL BOOK V 19 PAGE 33