



Deni Associates
FORT MYERS, FLORIDA

LEE COUNTY, FLORIDA
AERIAL MAPPING PROJECT

MAPPING BY:
WOOLPERT CONSULTANTS

1-43-26

DESIGNATION TBM 19-37 COUNTY LEE STATE FL

LOCATED IN SEC 1 TWP 42S RGE 26E USGS QUAD MAP TELEGRAPH SWAMP

TO REACH SURVEY MARK FROM INT. OF SR. 31 & CR 78: GO E. 2.75 MI ± TO A
PAVED DRIVE ON N. SIDE OF RD.: THENCE E. 0.20 MI ± TO 90° BEND:
THENCE N. 1.0 MI ± THRU VARIOUS GATES & PASTURES, TO A
GATE @ EAST/WEST FENCE LINE: THENCE E. ALONG N. SIDE OF
FENCE 2.0 MI ± TO MARK

TYPE OF 8" SPK S.W. FACE P.P. (COR. POWER POLE)

MARK _____ DATE SET NOV. 19 88

HORIZONTAL CONTROL ORIGINATED ON 2ND ORDER CONTROL BY N.G.S. AND F.D.O.T.

ON NORTH AMERICAN DATUM OF 1927 (1927 ADJ) ON NORTH AMERICAN DATUM OF 1983

COORDINATES (FT) COORDINATES (FT)

NORTHING (Y) _____ NORTHING (Y) _____

EASTING (X) _____ EASTING (X) _____

3RD ORDER COORDINATES STATE AND ZONE FLORIDA, MERCATOR WEST

FIELD BOOK _____ PAGE _____ SKETCH BY WGH

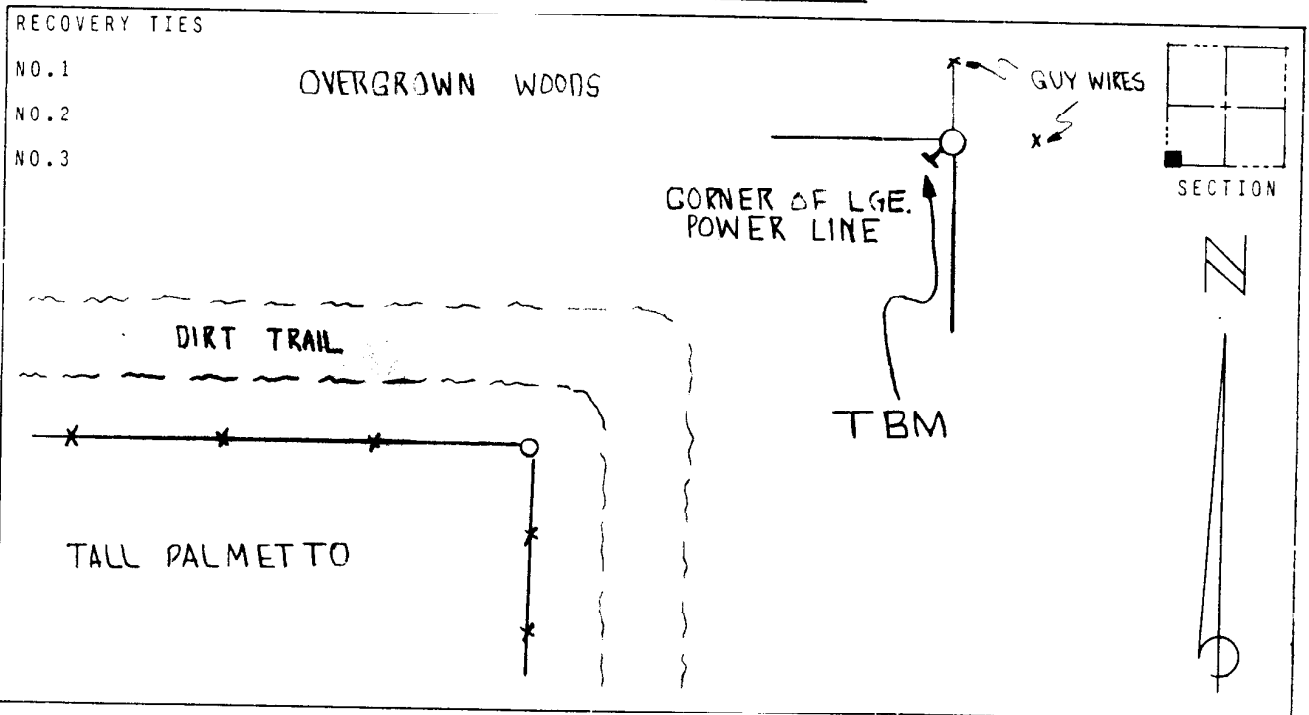

VERTICAL CONTROL ORIGINATED ON 2ND ORDER CONTROL ESTABLISHED BY N.G.S. AND F.D.O.T.

ON NATIONAL GEODETIC VERTICAL DATUM OF 1929

ELEVATION (FT) 20.38 , 3RD ORDER LEVEL BOOK V 19 PAGE 37