



Deni Associates  
FORT MYERS, FLORIDA

LEE COUNTY, FLORIDA  
AERIAL MAPPING PROJECT  
MAPPING BY: HAMRICK AERIAL SURVEYS, INC.  
CLEARWATER, FLORIDA

DESIGNATION FLA DOT BM 38 COUNTY LEE STATE FL  
LOCATED IN SEC 36 TWP 43 S. RGE 25E USGS QUAD MAP FORT MYERS 7.5 MIN.  
TO REACH SURVEY MARK FROM INT. S.R. 80 + S.R. 31 IN SEC. 30-43-26:  
GO W. ON S.R. 80 ± 0.7 MI TO MARK.

TYPE OF MARK FLA DOT DISC IN CONC. DATE SET MAY 1985

HORIZONTAL CONTROL ORIGINATED ON \_\_\_\_\_ ORDER CONTROL ESTABLISHED BY \_\_\_\_\_  
IN \_\_\_\_\_, ON NORTH AMERICAN DATUM OF 1927.

COORDINATES (FT) NORTH (Y) \_\_\_\_\_ EAST (X) \_\_\_\_\_  
3RD ORDER STATE AND ZONE FLORIDA, MERCATOR WEST

REFERENCE BEARINGS TO STATION OR OBJECT

DESCRIPTION	BEARING	DISTANCE
_____	_____	_____
_____	_____	_____
_____	_____	_____

FIELD BOOK \_\_\_\_\_ PAGE \_\_\_\_\_ SKETCH BY EVS

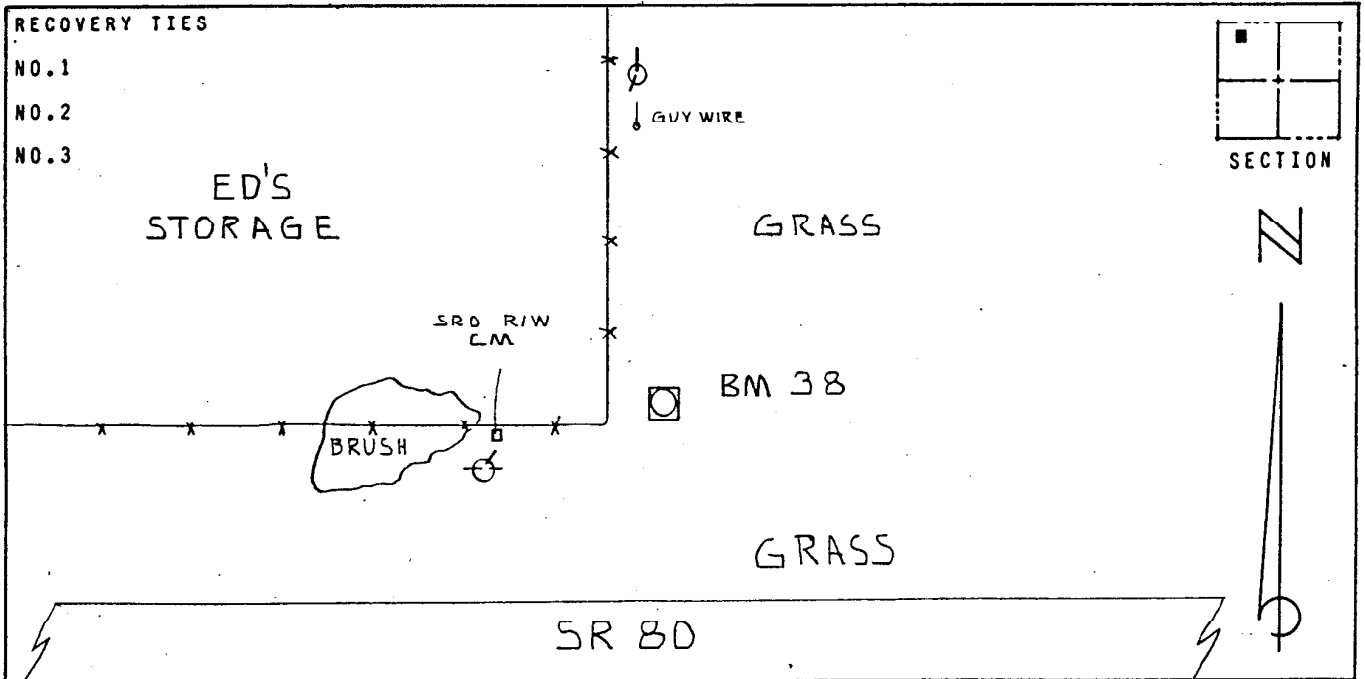

VERTICAL CONTROL ORIGINATED ON 1<sup>ST</sup> ORDER CONTROL ESTABLISHED BY USC + GS  
IN 1966, ON NATIONAL GEODETIC SURVEY DATUM OF 1929.

ELEVATION (FT) 05.76, 3RD ORDER LEVEL BOOK 16 PAGE 20