



Deni Associates

FORT MYERS, FLORIDA

LEE COUNTY, FLORIDA  
AERIAL MAPPING PROJECT

MAPPING BY: HAMRICK AERIAL SURVEYS, INC.  
CLEARWATER, FLORIDA

DESIGNATION FLA DOT BM 29 COUNTY LEE STATE FL

LOCATED IN SEC 34 TWP 43 S RGE 25 E USGS QUAD MAP FORT MYERS 7.5 MIN.

TO REACH SURVEY MARK FROM INT. S.R. 80 + INTERSTATE 75 IN  
SEC. 3-44-25: GO E. ON S.R. 80 ± 0.25 MI. TO MARK.

TYPE OF MARK FLA. DOT DISC IN CONC. DATE SET MAY 19 85

HORIZONTAL CONTROL ORIGINATED ON \_\_\_\_\_ ORDER CONTROL ESTABLISHED BY \_\_\_\_\_  
IN \_\_\_\_\_, ON NORTH AMERICAN DATUM OF 1927.

COORDINATES (FT) NORTH (Y) \_\_\_\_\_ EAST (X) \_\_\_\_\_  
3RD ORDER STATE AND ZONE FLORIDA, MERCATOR WEST

REFERENCE BEARINGS TO STATION OR OBJECT

DESCRIPTION	BEARING	DISTANCE
_____	_____	_____
_____	_____	_____
_____	_____	_____

FIELD BOOK \_\_\_\_\_ PAGE \_\_\_\_\_ SKETCH BY EVS

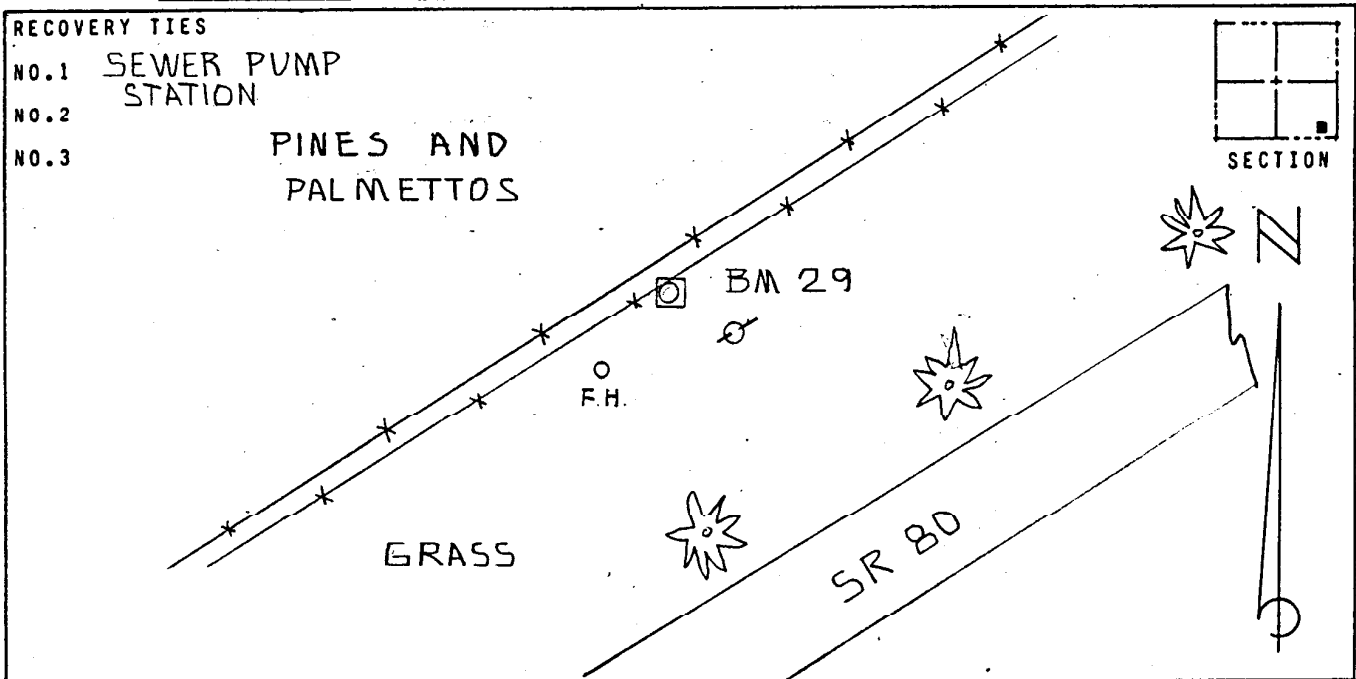

VERTICAL CONTROL ORIGINATED ON 1ST ORDER CONTROL ESTABLISHED BY USC + GS  
IN 1966, ON NATIONAL GEODETIC SURVEY DATUM OF 1929.

ELEVATION (FT) 08.62, 3RD ORDER LEVEL BOOK 16 PAGE 56